

The logo for WALTER, featuring the word "WALTER" in a bold, blue, sans-serif font. The letters are set against a grey background that consists of a large square with a smaller square cut out of its top-right corner.

# ASSEMBLY INSTRUCTIONS

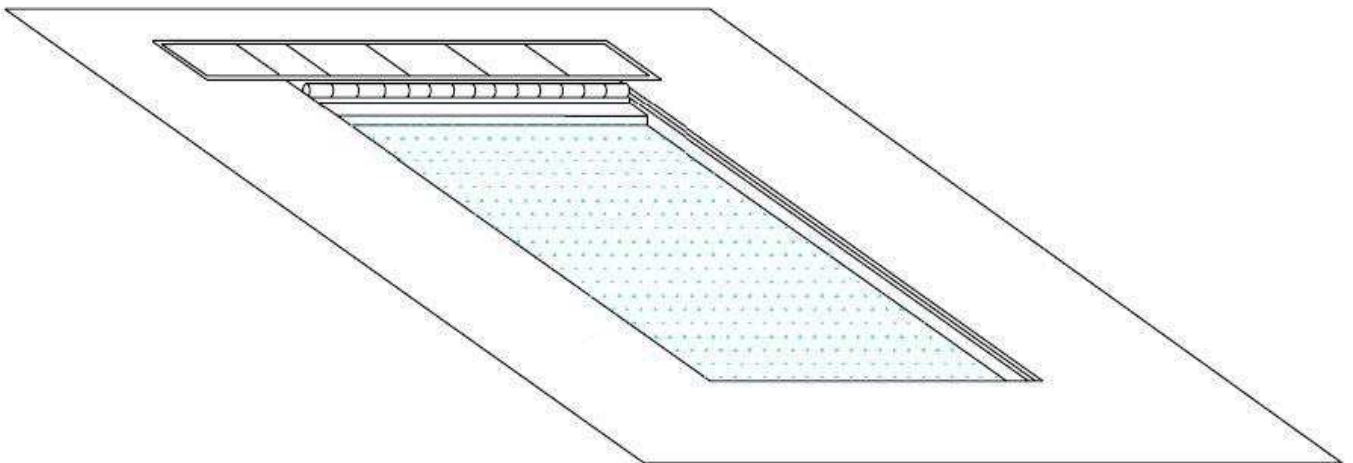

UNDER IN

# REMINDER

BEFORE ANY INSTALLATION, REFER TO THE DOCUMENT : **WORKSITE PREPARATION AND TAKING MEASUREMENTS**



THE DIFFERENT STEPS TO BE FOLLOWED FOR THE CREATION OF THE PIT:

## **I. REMINDER/CREATION OF THE POOL:**

During the creation of the pool you should not forget to reserve an area for installing the tracks that is 110 x 25 mm.

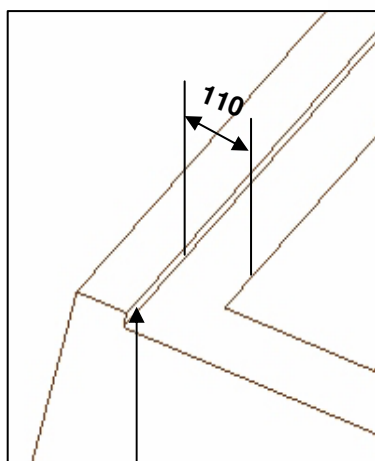

The groove height is 25mm.

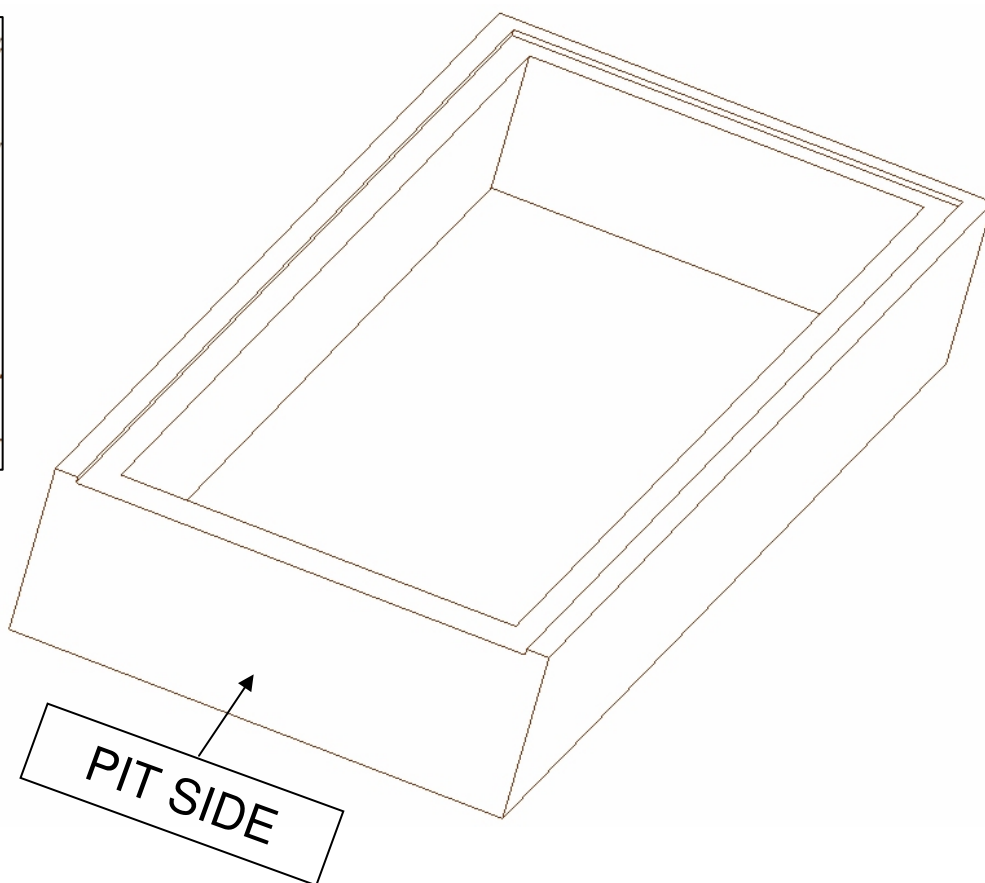

On the side of the pit, the groove is made along the entire width of the wall as you can see on the detailed view.

## II. REMINDER/CREATION OF THE PIT:

The motorisation can be placed on the left or the right depending on the location of the technical unit (pool house) where the POWER PACK is located.

To make the pit, the following rules are to be followed :

- The walls should be made of concrete or full blocks
- The thickness of the walls should be 100mm maximum
- The dimensions of the space for the LEFT hydraulic mechanism are the same as for the RIGHT version.
- Insert a  $\varnothing 100\text{mm}$  tube before pouring the concrete for passing the wires (motor side)
- Plan the drilling to drain the rainwater
- Round off the angle where the cover fits

### DIAGRAM REPRESENTING THE LEFT MOTORISATION

Tube  $\varnothing 100\text{ mm}$   
min. for passing  
hydraulic wires

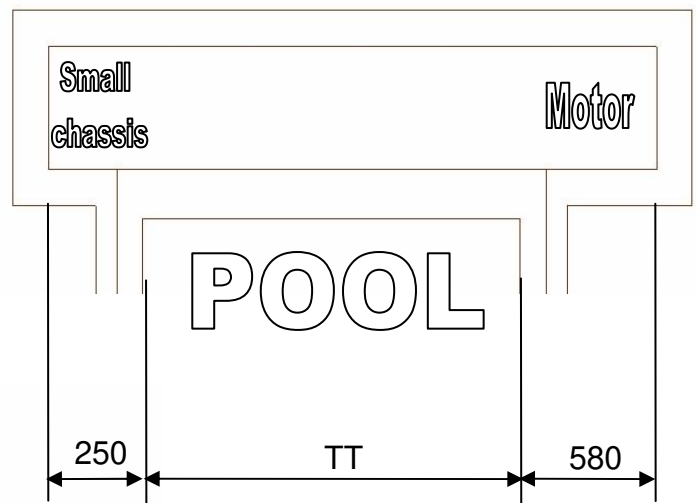
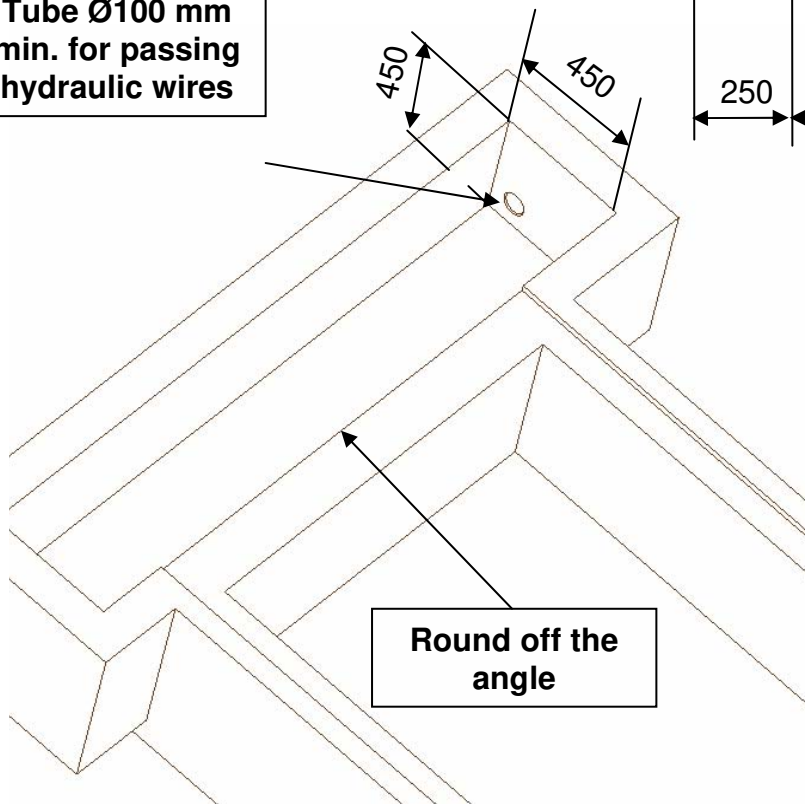

Positioning of the tube for installing the wires

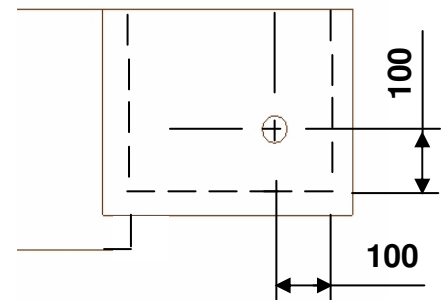

Don't forget to plan the drilling in the centre of the pit for the draining of rainwater.

# INSTALLING THE POCKET PROFILE

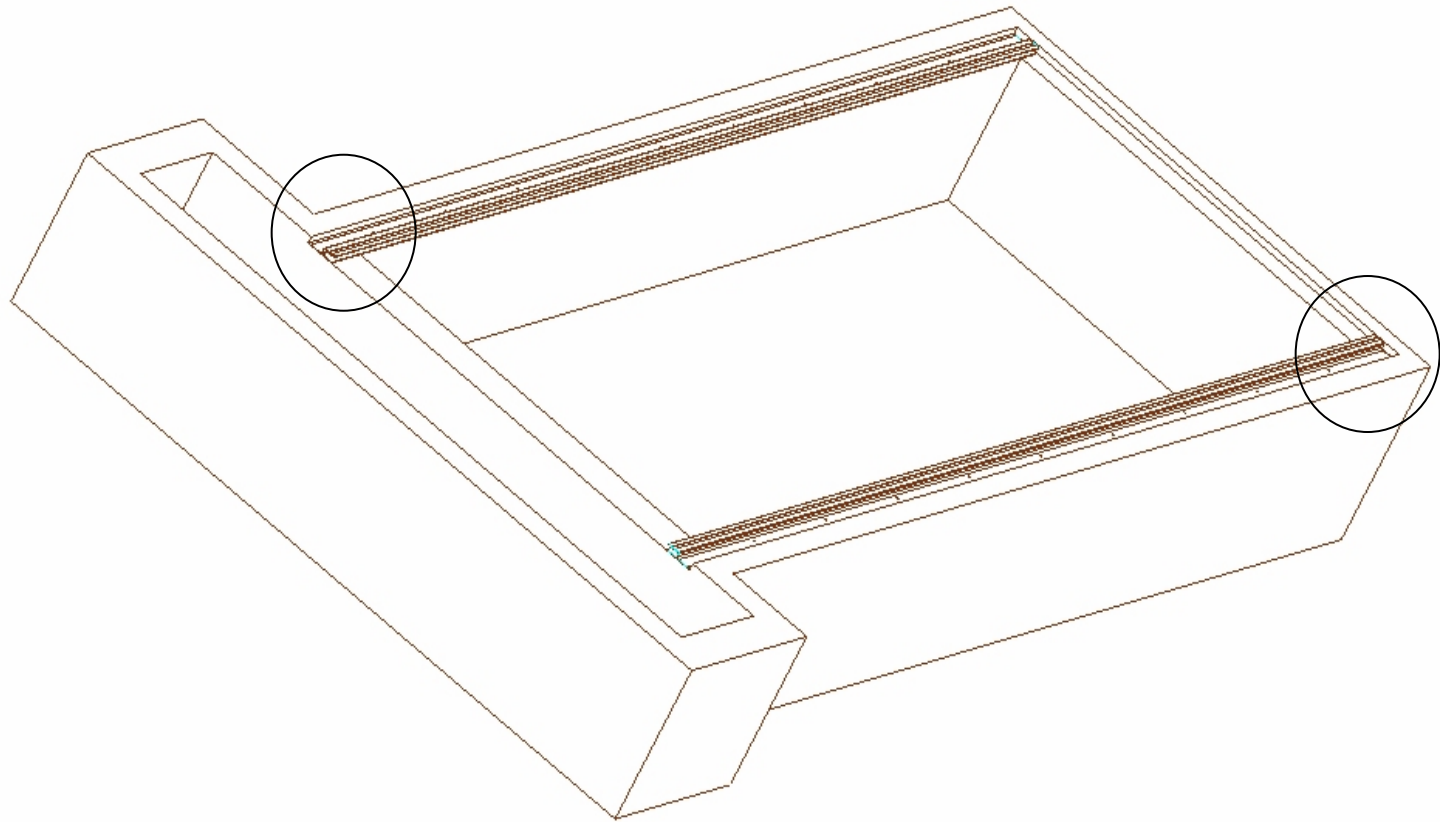

## I. POSITIONING OF THE POCKET PROFILE :

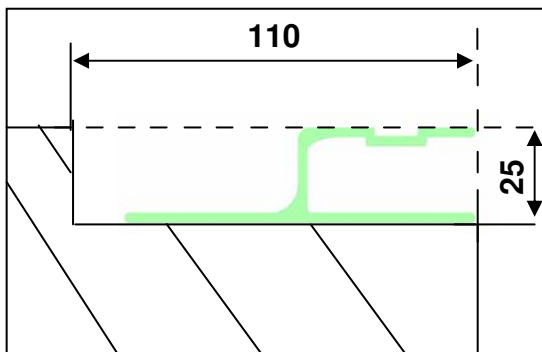
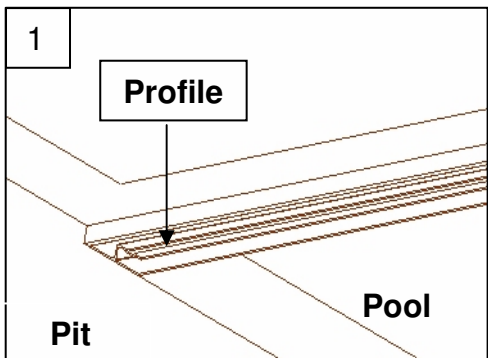

The POCKET profile should be aligned level with the pit and against the pool.

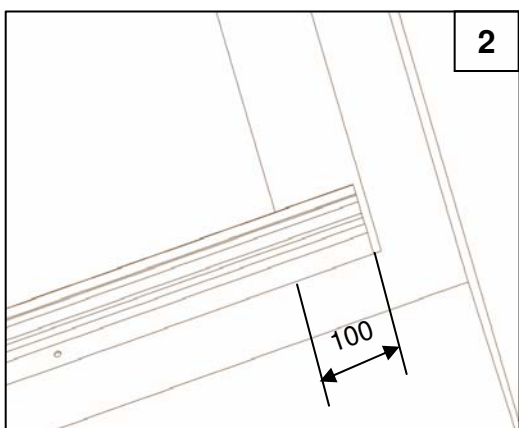

At the end, the POCKET profile should stick out 100mm.

## II. FIXING OF THE POCKET PROFILE:

After positioning the tracks, counter drill the holes at  $\varnothing$  8mm to install the plastic pegs S8 x 40.

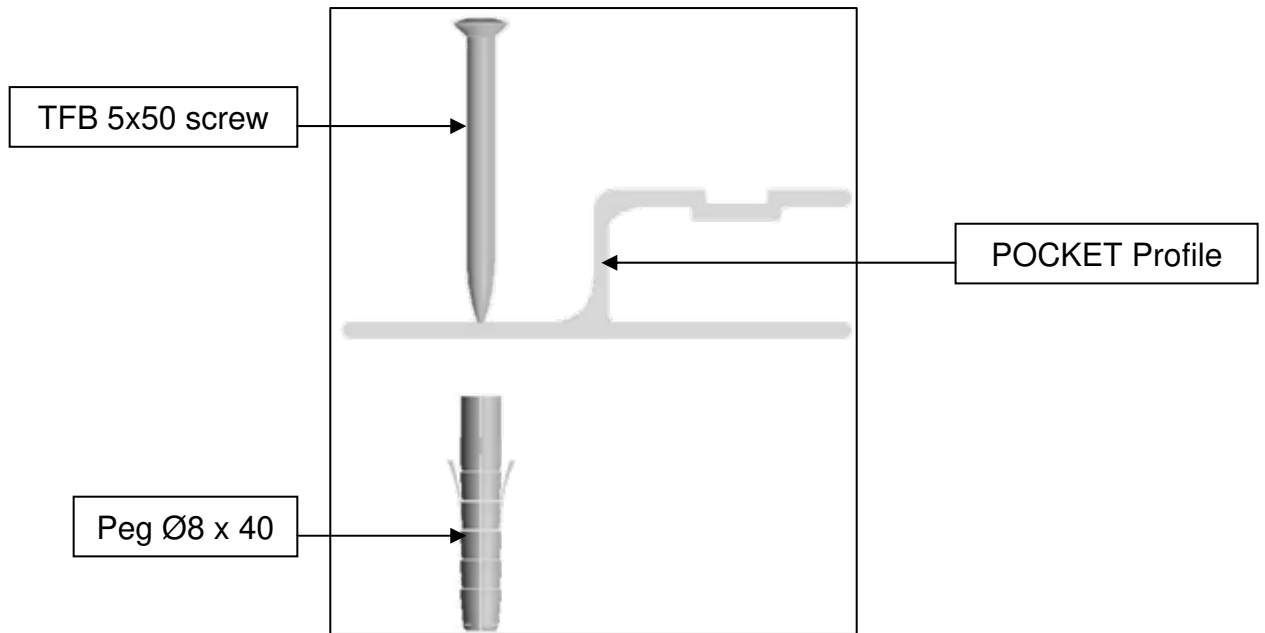

## INSTALLING THE ANGLE BAR ON THE OPPOSITE WALL

The angle bar is aligned level with the pool and fixed in the same way as the tracks.

The angle bar should have a length between the two tracks and as big as possible.

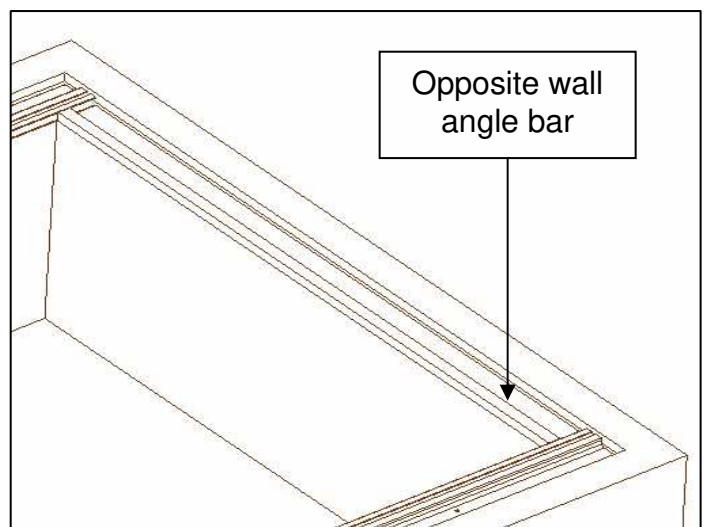

# INSTALLING THE MOTORISATION

## SUPPLIES NEEDED:

- Hydraulic motor chassis kit (left hand motorisation)
- Small chassis kit (left hand motorisation)
- Hydraulic chassis bracket kit + screw (ZU 200002)
- Motor fixation kit (ZD 200010)

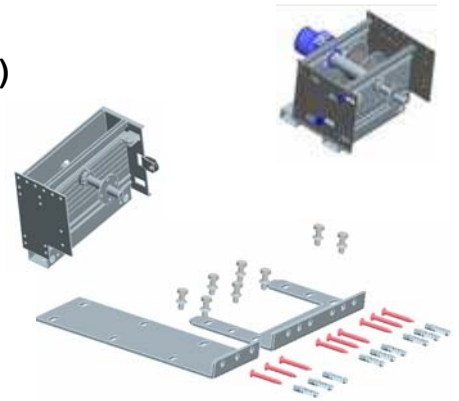

## I. POSITIONING OF THE HYDRAULIC CHASSIS:

To position the motor, fit this into the pit, place the front plate of the motor against the wall pool side and align this plate in relation to the Pocket profile.

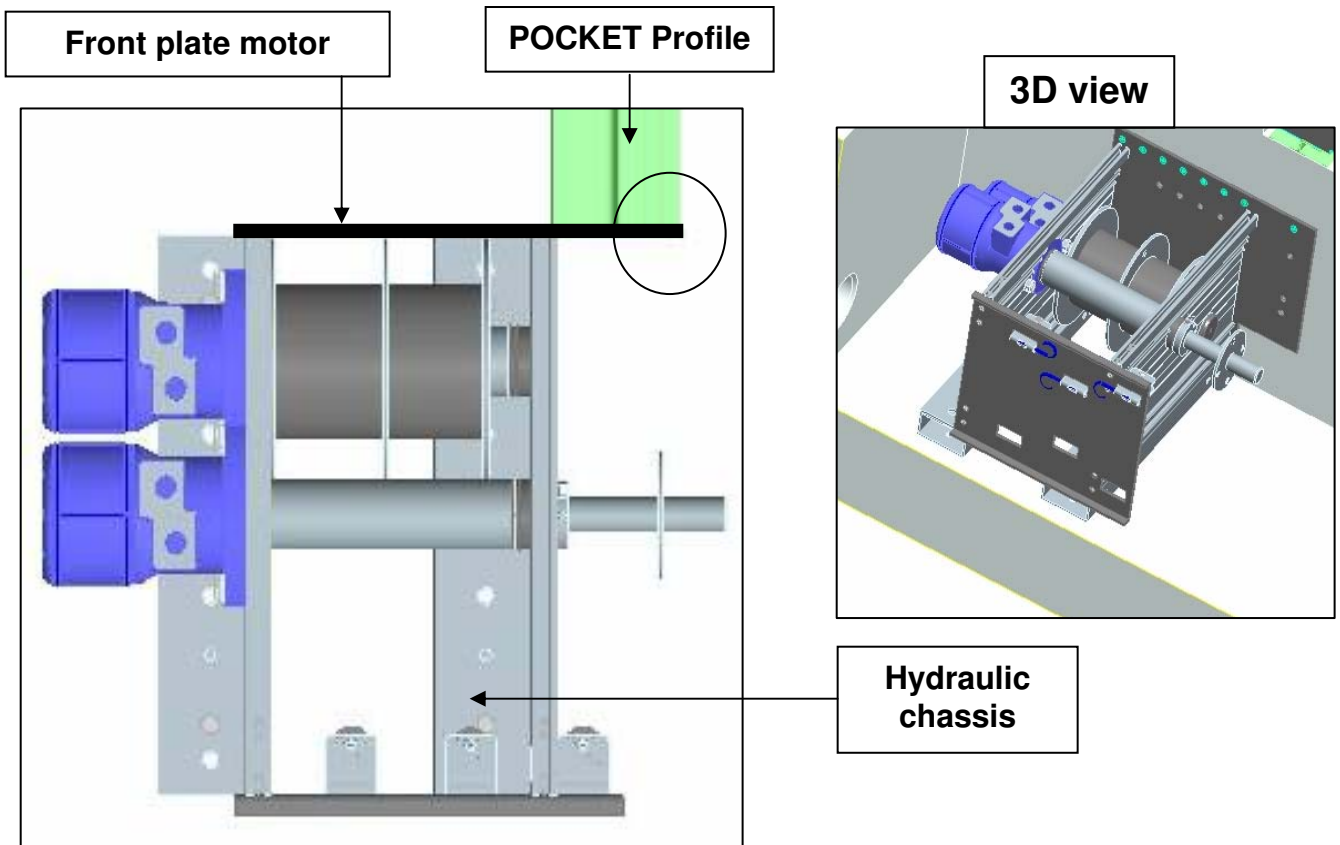



## II. FIXATION OF THE HYDRAULIC CHASSIS:

### 1. Fixing to the ground:

Once the hydraulic chassis has been positioned, counter drill four holes in the two profiles positioned on the ground to install the  $\varnothing 12$  pegs. For the fixation of the motor chassis, use the square head wood screws and  $\varnothing 10$  washers. Do not totally tighten the square head wood screws.

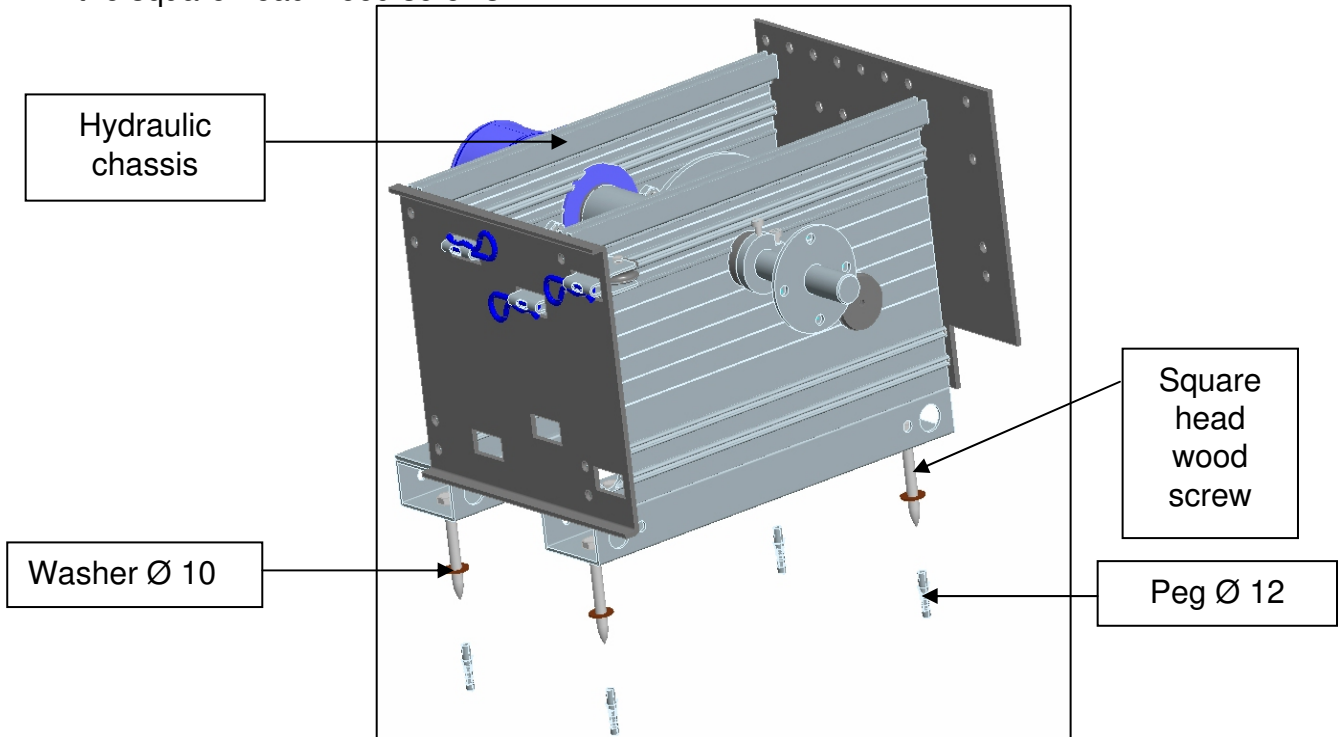

### 2. Fixation flush with the facade on the pool side:

After having installed the square head wood screws for fixing to the ground, counter drill the holes located on the top of the front plate of the motor to install the plastic pegs,  $\varnothing 8 \times 40$

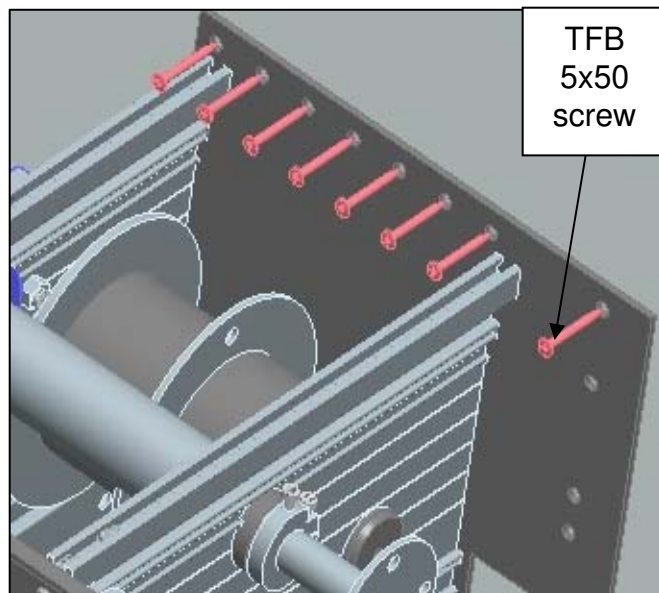

### 3. Fixation of the bracket kit:

The bracket kit allows the motor to be fixed on the back. For fixing the bracket it is first of all necessary to place it on the hydraulic chassis and fix it using the HM 8 x 20 screws, M8 washers and M8 nuts that you should slide into the hydraulic chassis grooves. Do not totally tighten the screws (see view below)

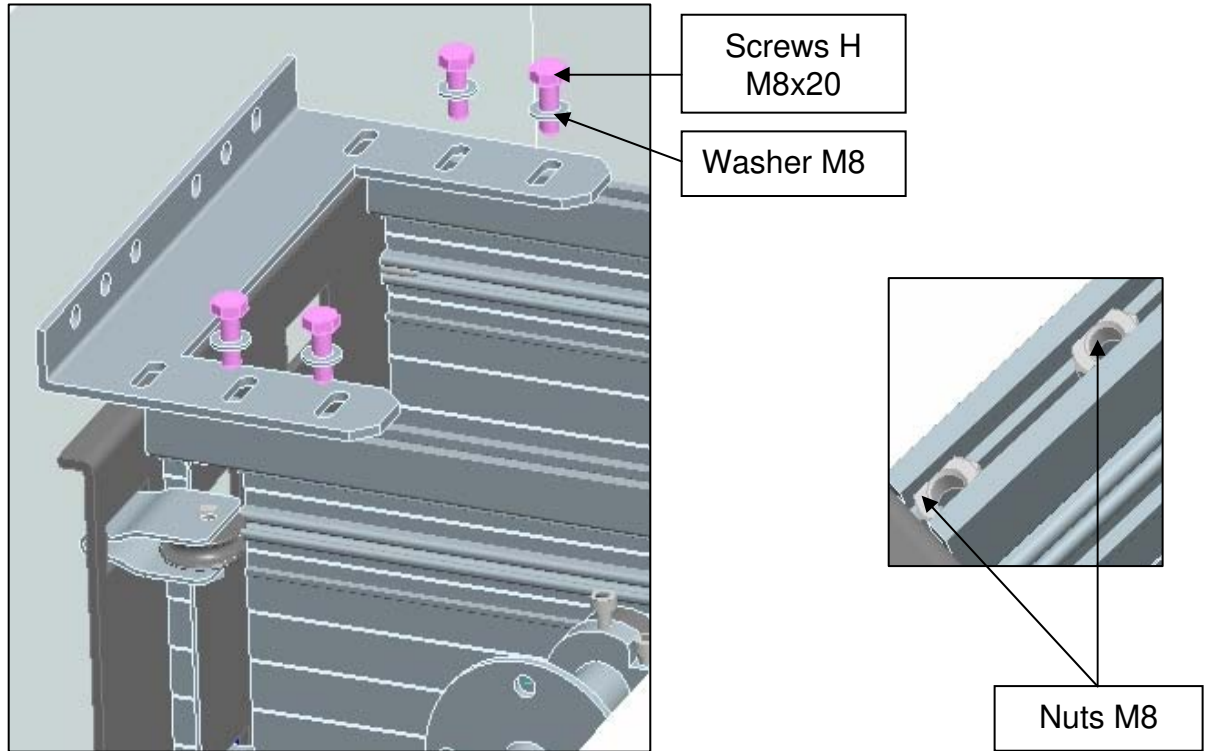

After having installed the bracket on the hydraulic chassis, counter drill the drill holes to fix the TFB 5x50 screws

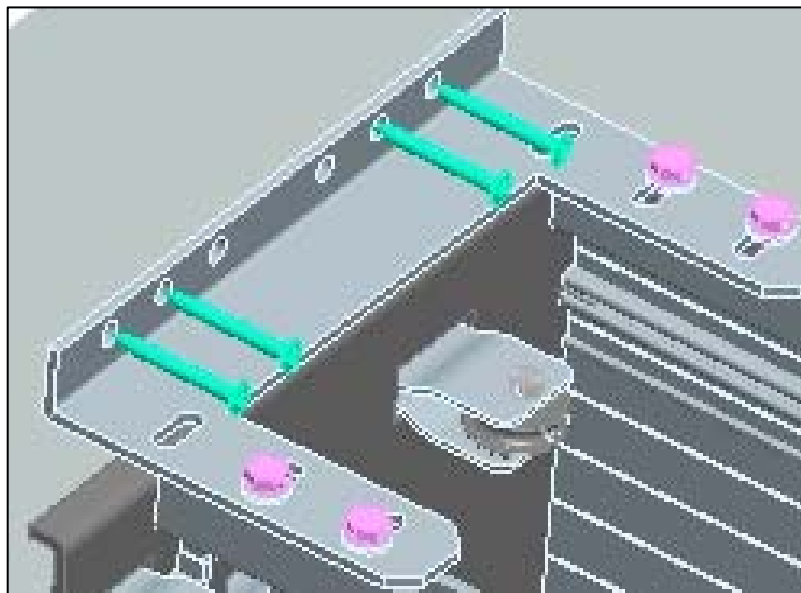

**For the small chassis, carry out the same operations using the appropriate bracket**



# INSTALLING THE WINDING TUBE

## SUPPLIES NEEDED :

- Winding tube



- Winding tube/motor linking screw kit

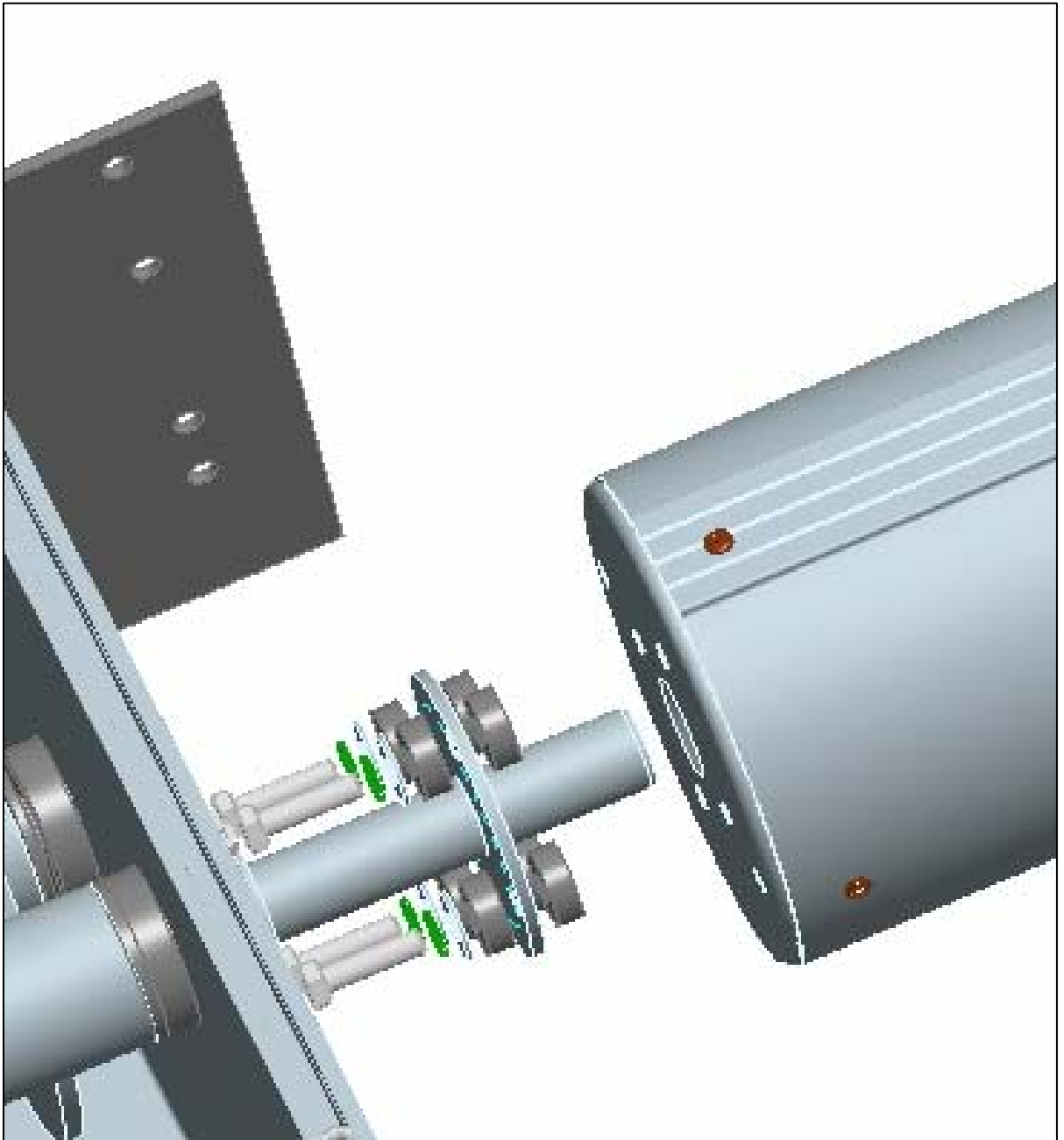

# CONNECTION WINDING TUBE TO MOTORBLOC

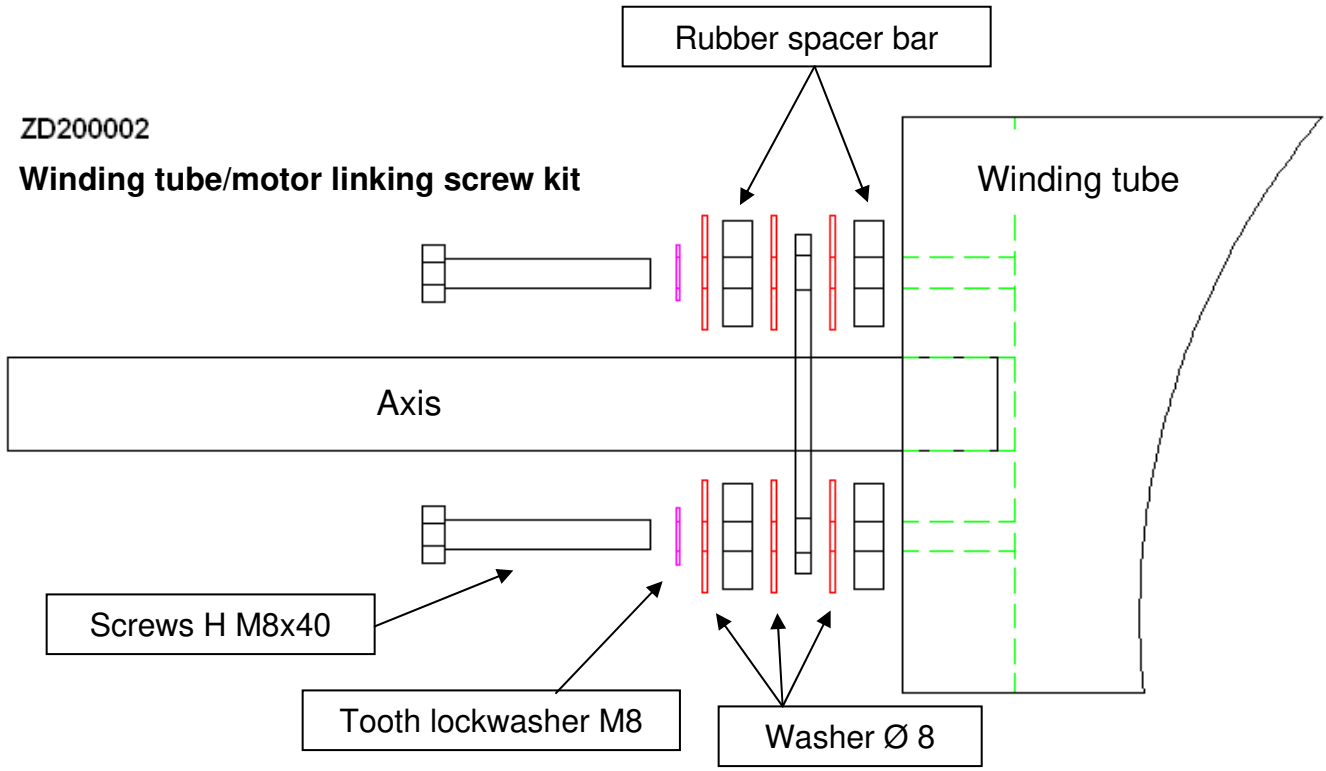

Tighten the H M8 screws until the rubber spacer bars are in contact with one another. To assemble the small chassis to the axle, follow the same procedure.

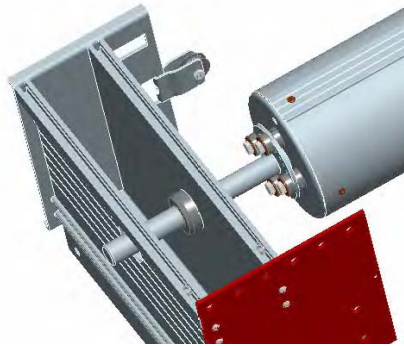

After assembly of the unit, centre the tube between the motor and the small chassis then tighten the two stop rings

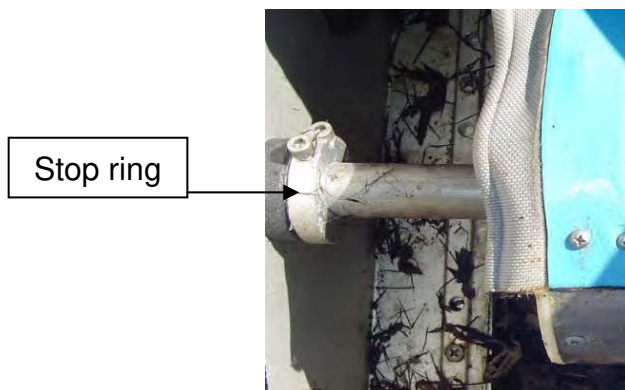

# INSTALLING THE TRACKS IN THE POCKET PROFILES

Before installing the tracks in the profiles, it is vital to carry out the following operations :

- Install the cord where the gliders are fixed.
- Install the pulley.

## SUPPLIES NEEDED :

- Cord



- Glider ( ZC 100025)



- IN profile end of track kit (ZA 200103)

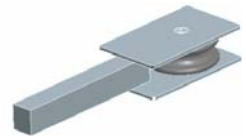

## I. INSTALLING THE CORD AND THE GLIDERS:

Install the cord then pull it until the glider is inserted into the track as in the following figure.



**THE COVER IS NOT SHOWN**

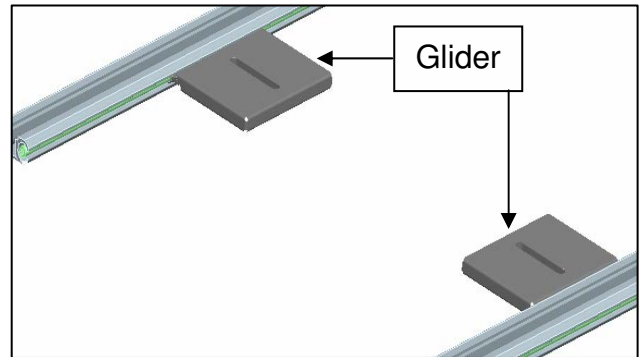
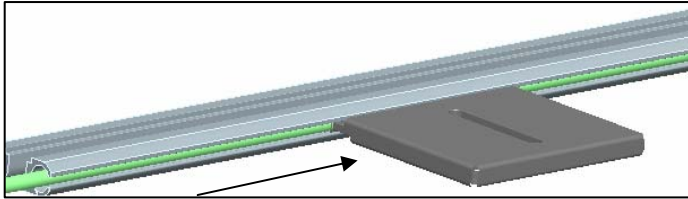

At the end of the track, the cord should be moved to the other side of the Pocket profile to make a loop to insert the pulley kit.

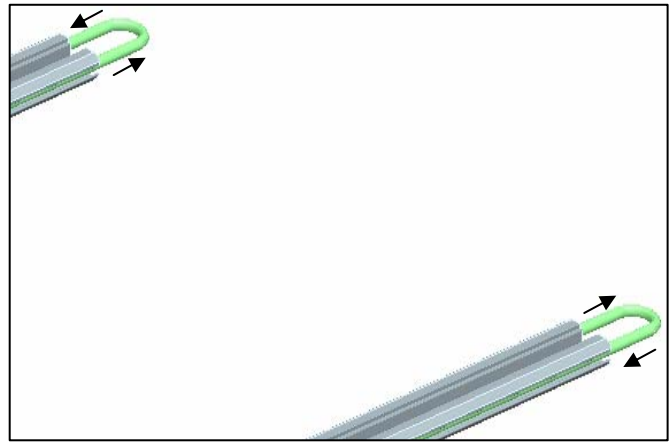
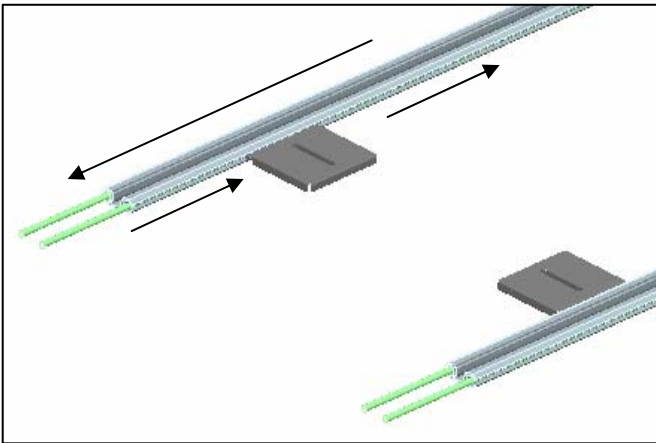

## II. INSTALLING THE PULLEY KIT:

After installing the pulley kit, ensure that the cord slides correctly.

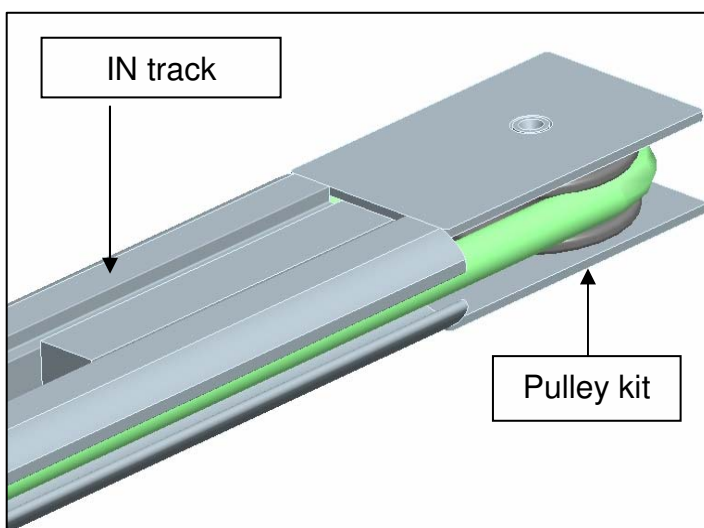

**N.B. :**

There is an assembly direction for the pulley, the support is not symmetrical.

The pulley has to be flush with the profile

### **III. INSTALLING THE TRACKS IN THE POCKET PROFILES:**

It is very easy to install the tracks in the Pocket profiles: All you have to do is follow the procedure below:

- Slide the IN track into the Pocket and install it
- Install the guide cords
- Install the spacer to space the track

**The length of the IN track and the spacer is equal to the length of the Pocket profile – 100mm**

**Track and spacer = Pocket length – 100mm**

#### **1. Positioning and installing the tracks:**

The track should be aligned in relation to the Pocket profile on the pit side.



**JUST THE TRACKS AND THE SPACERS ARE SHOWN**

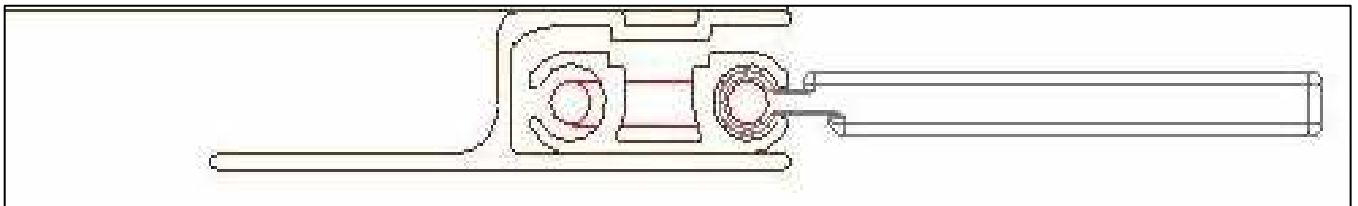

#### **2. Positioning and installing the guide cords :**

The tracks are squeezed using the guides that themselves are positioned against the wall of the pool.

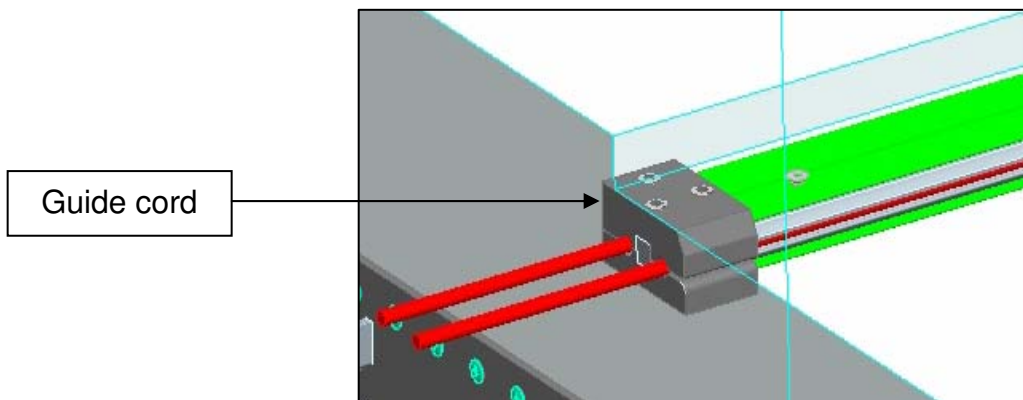

### **3. Spacing the track unit:**

The spacer should be aligned in relation to the Pocket profile on the pit side and centred in relation to the track. The guide should always be positioned against the pool wall.



**JUST THE TRACKS AND THE SPACERS ARE SHOWN**

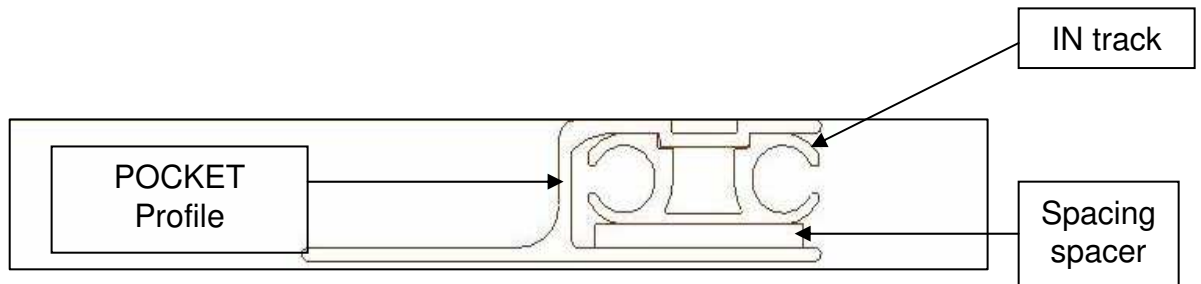

### **4. Fixing the track on the Pocket profile:**

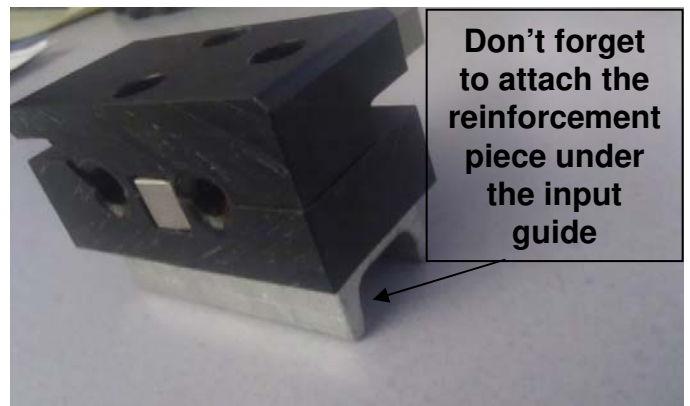
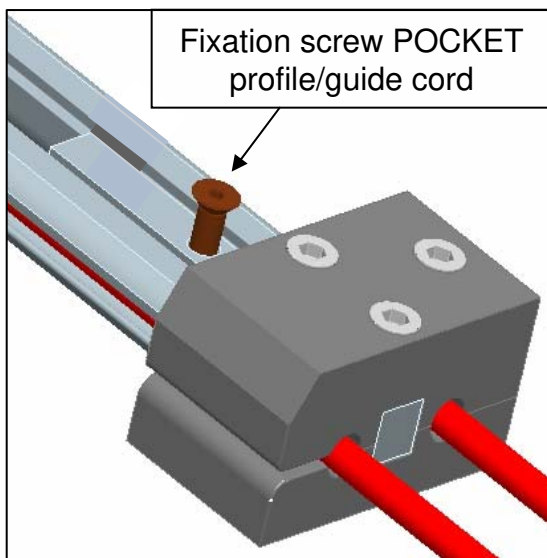

The diagram represents the  $\varnothing 8$  mm hole to drill in the POCKET profile in order to lock the input guide.

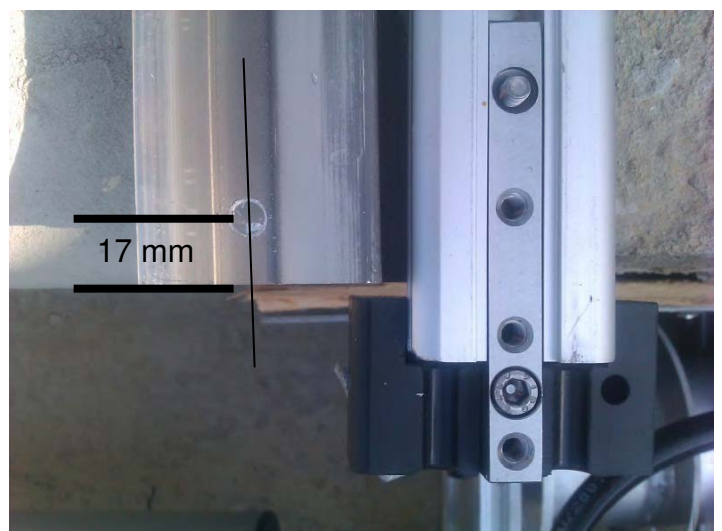
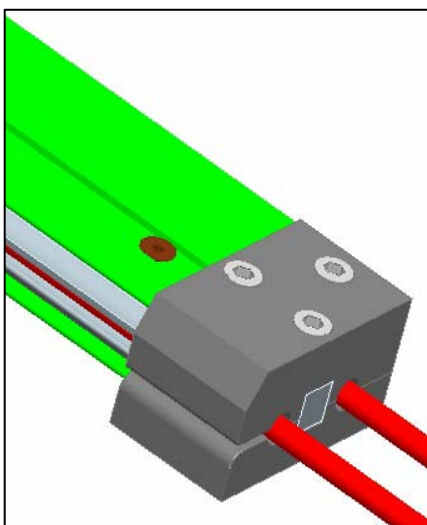



# INSTALLING THE LOADING BAR

## SUPPLIES NEEDED :

- Bracket (Bracket kit)

- Loading bar



- IN linking bracket kit (ZA 200012)

For the installation of the loading bar, first of all it is necessary to fix the bracket where the assembled loading bar will be.

## I. INSTALLING THE COVER ON THE LOADING BAR

Slide the backing cloth as indicated below into the loading bar.

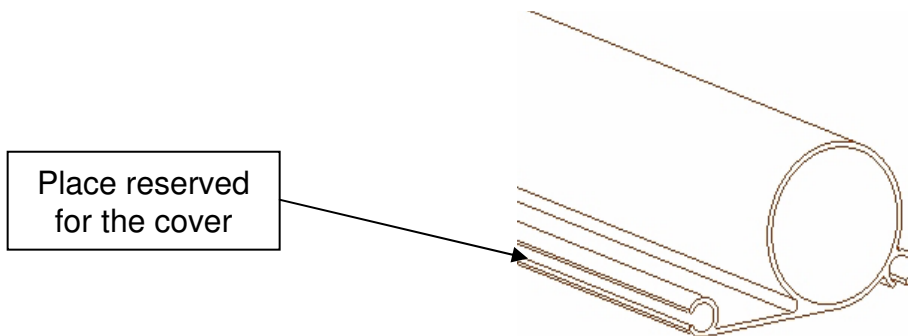

## II. INSTALLING THE BRACKETS ON THE GLIDERS

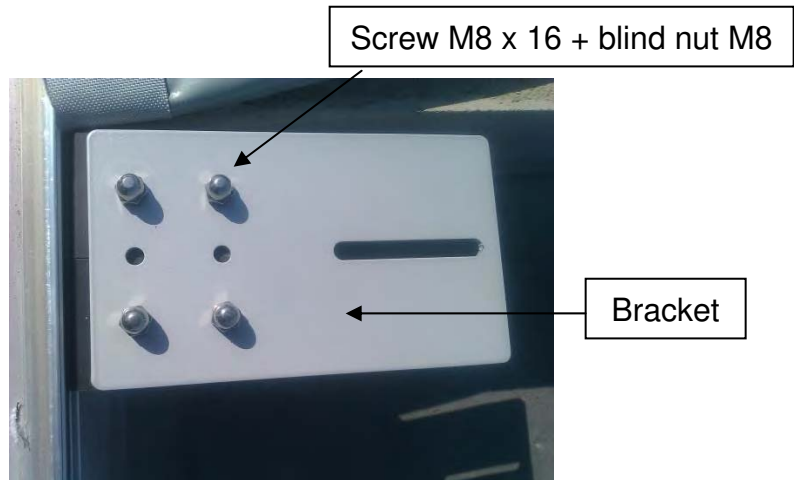

### III. FIXING THE LOADING BAR ONTO THE BRACKETS :

For the fixation of the loading bar use M8 x 16 screw and M8 nuts.

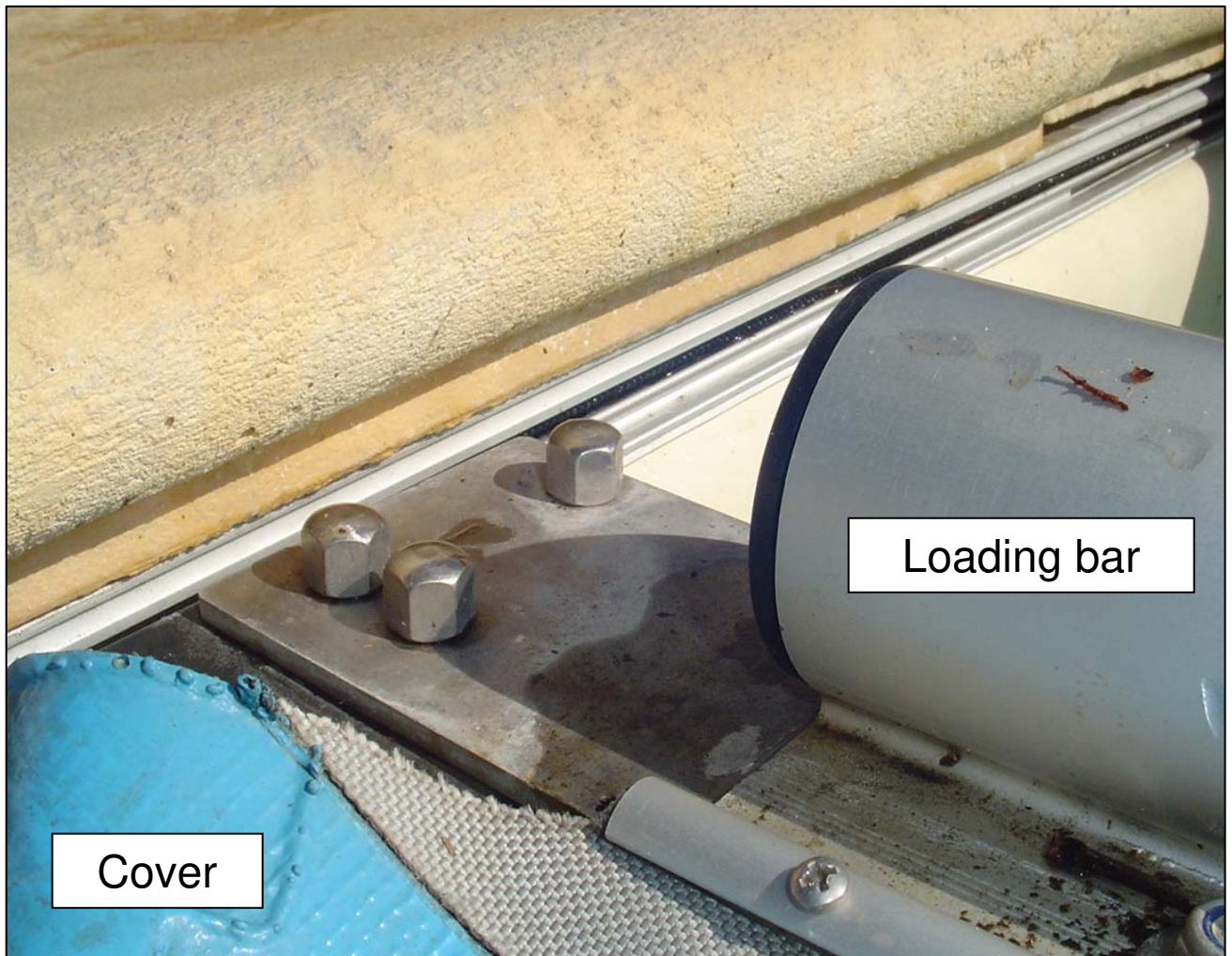

Screw M8 x 16

Reminder: Never fully tighten the nuts on the loading bar.  
Loosen them a half turn in order to release the bar.

# ASSEMBLING THE CORD ON THE MOTORISATION

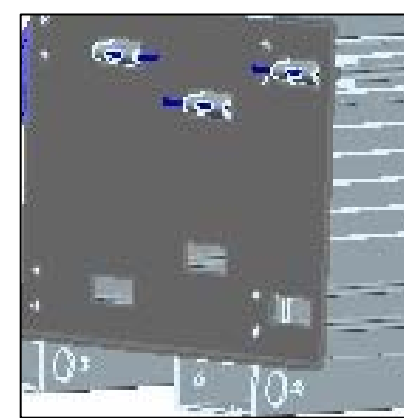
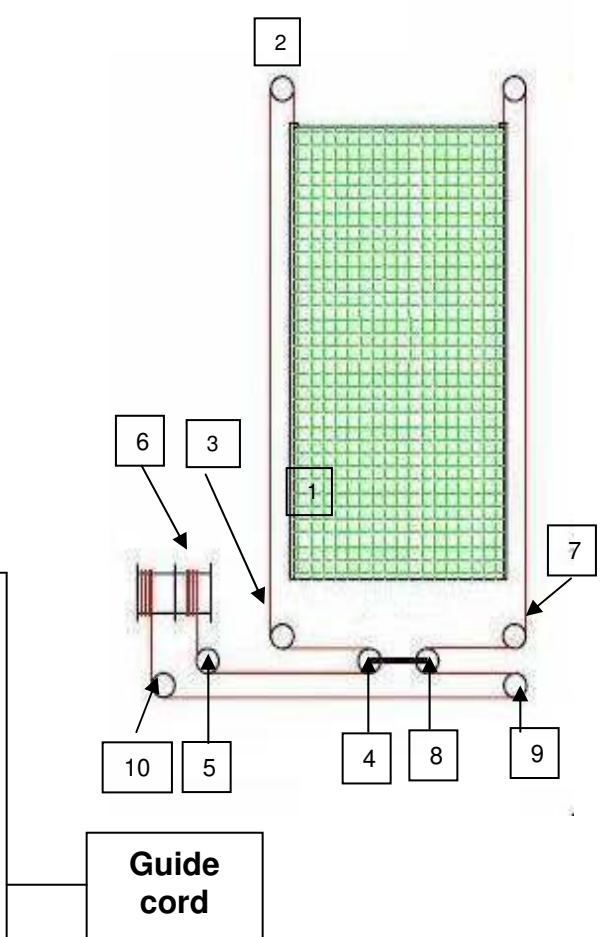
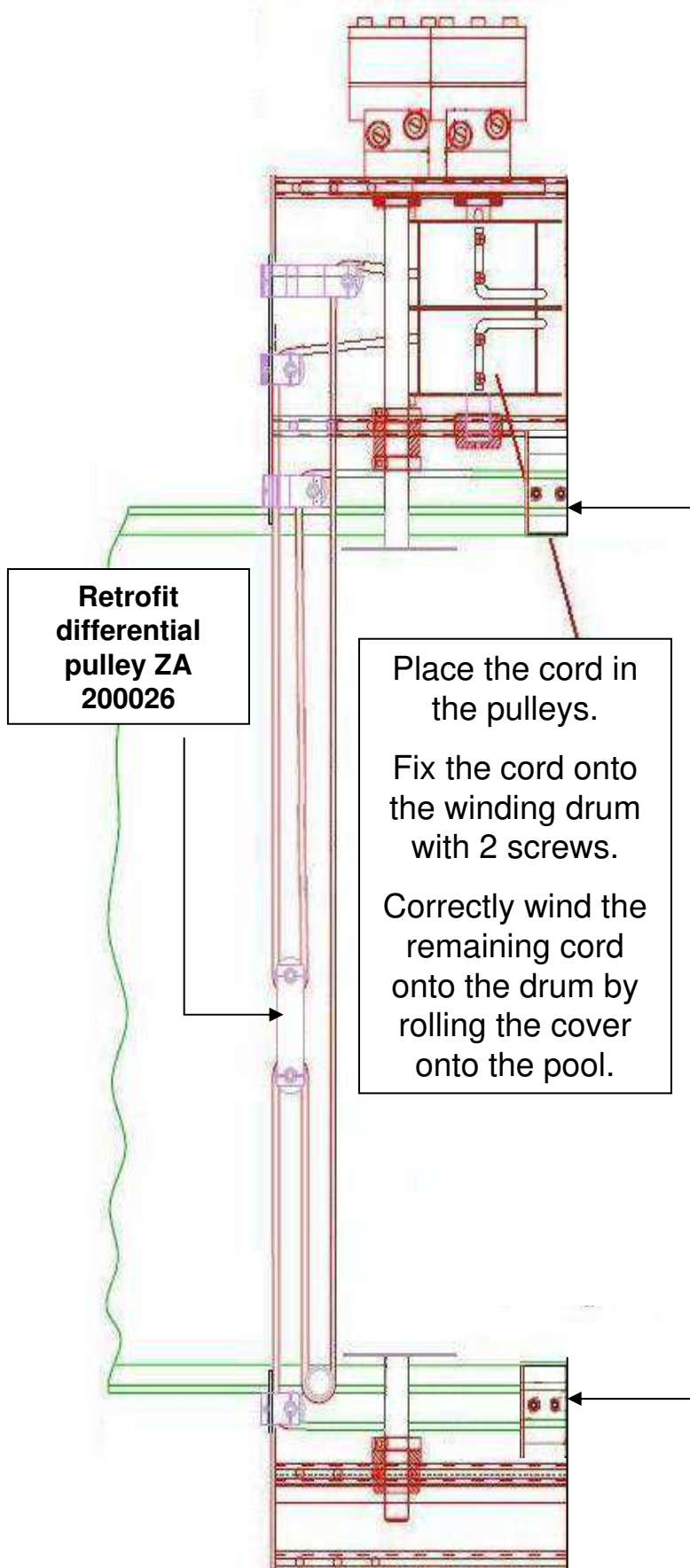

**The guide pulleys should be located on the upper part of the chassis.**



# FIXING THE COVER OF THE AXLE

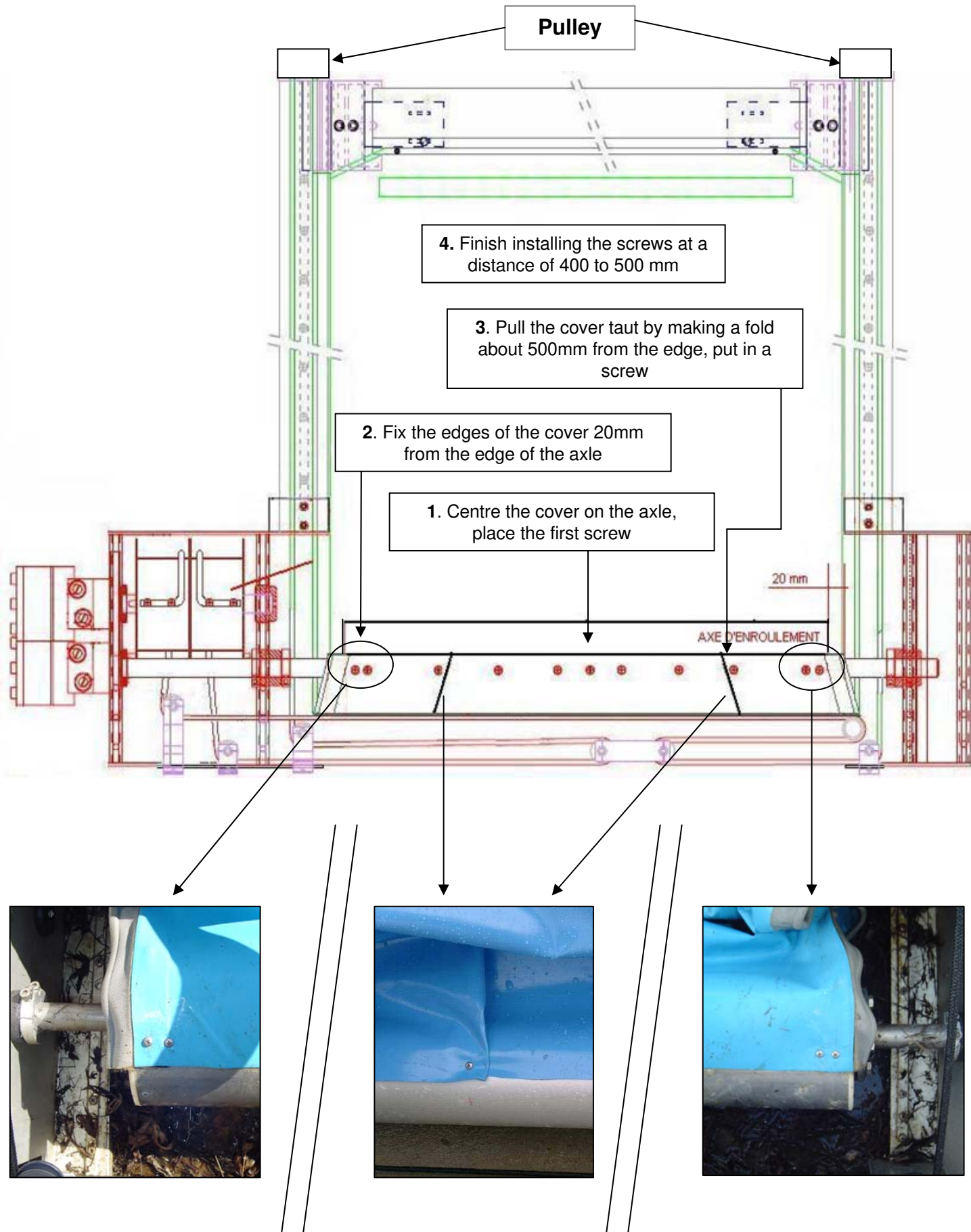

# CONNECTING THE WIRES

## VERSION UNDER **MOTOR RIGHT**

**CONNECT HOSE N°1 FROM  
MOTOR WITH HOSE N°1  
FROM POWERPACK**

*(You are free to choose)*

**CONNECT HOSE N°2 FROM  
MOTOR WITH HOSE N°2  
FROM POWERPACK**

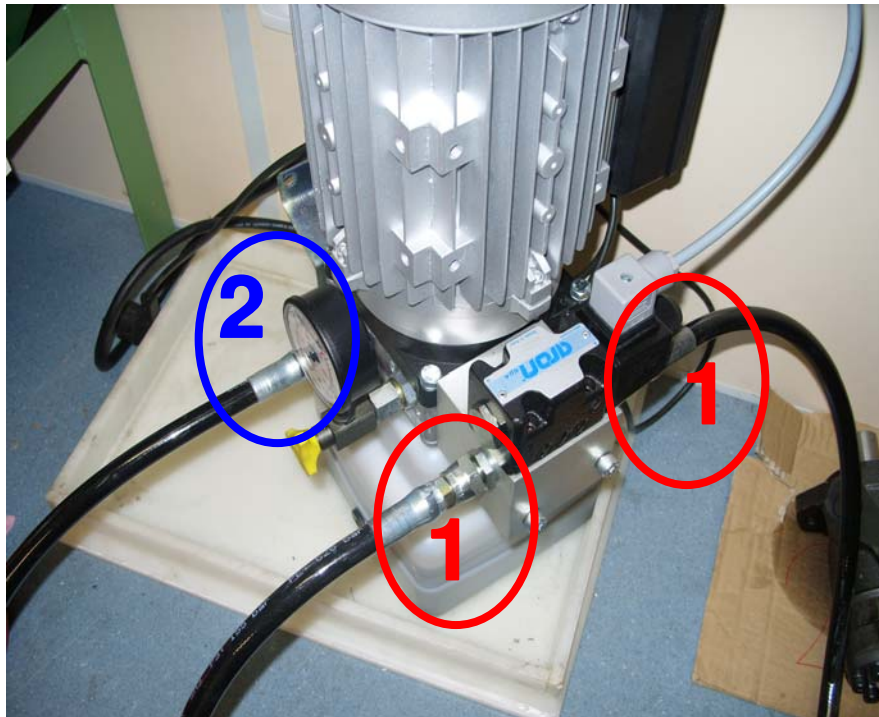
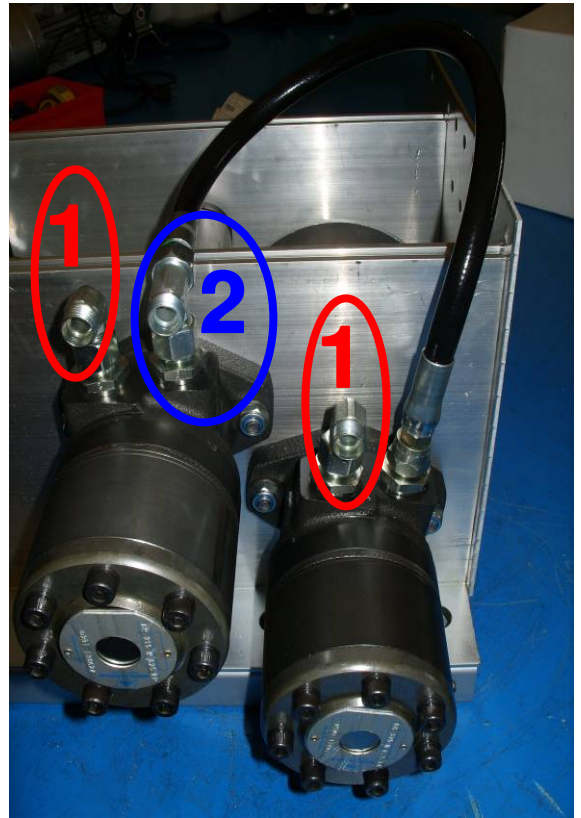

# CONNECTING THE WIRES

## VERSION UNDER **MOTOR LEFT**

**CONNECT HOSE N°1 FROM  
MOTOR WITH HOSE N°1  
FROM POWERPACK**

*(You are free to choose)*

**CONNECT HOSE N°2 FROM  
MOTOR WITH HOSE N°2  
FROM POWERPACK**

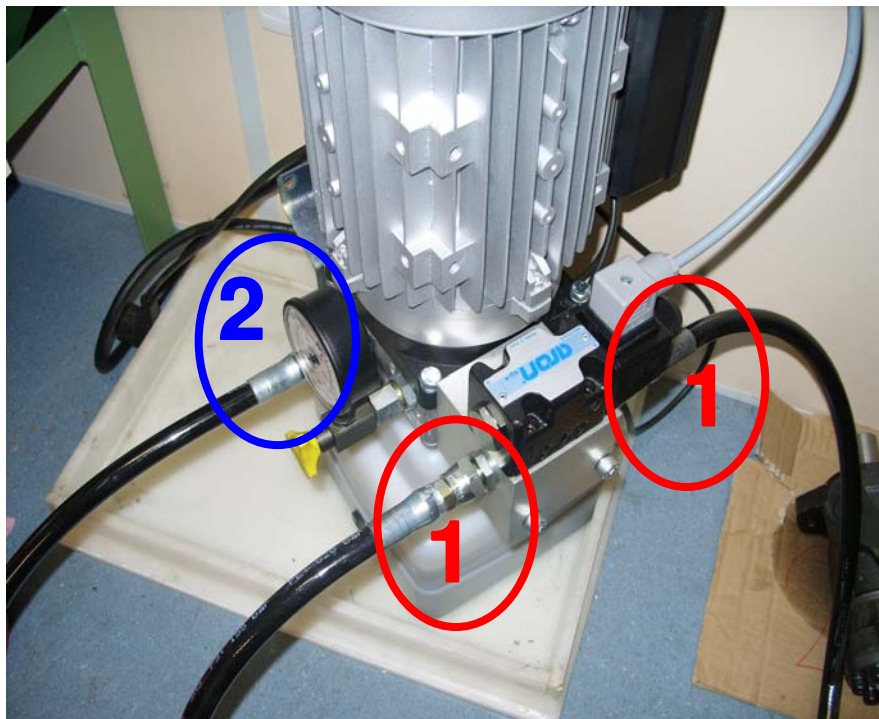
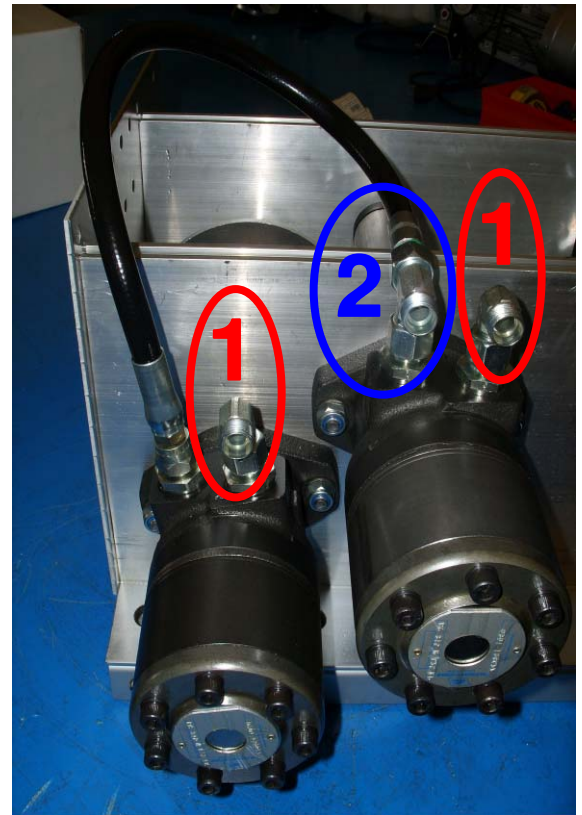



# ADJUSTING THE POWERPACK

It is not necessary to install special equipment, a 16A socket is enough for the supply.

Connect the hydraulic wires (no connection order)

Fill the reservoir with oil, start up and add oil gradually

(reservoir of 4 litres + 1 litre for 10 metres of wire + 1 litre for both motors)

## To adjust the hydraulic pressure :

Unscrew the nut using a 13mm key

Use a male 6 face key of 5mm to adjust the pressure.

Turn anticlockwise to **reduce** the pressure. Turn clockwise to **increase** the pressure.

Always adjust the pressure of the system at a stop beforehand and read the pressure on the manometer (max. 100 bars). Do not use higher pressure than is necessary.

The reservoir contains oil for the hydraulic and transmission system GM type C2 or C3 (norm ISO WG32) level oil

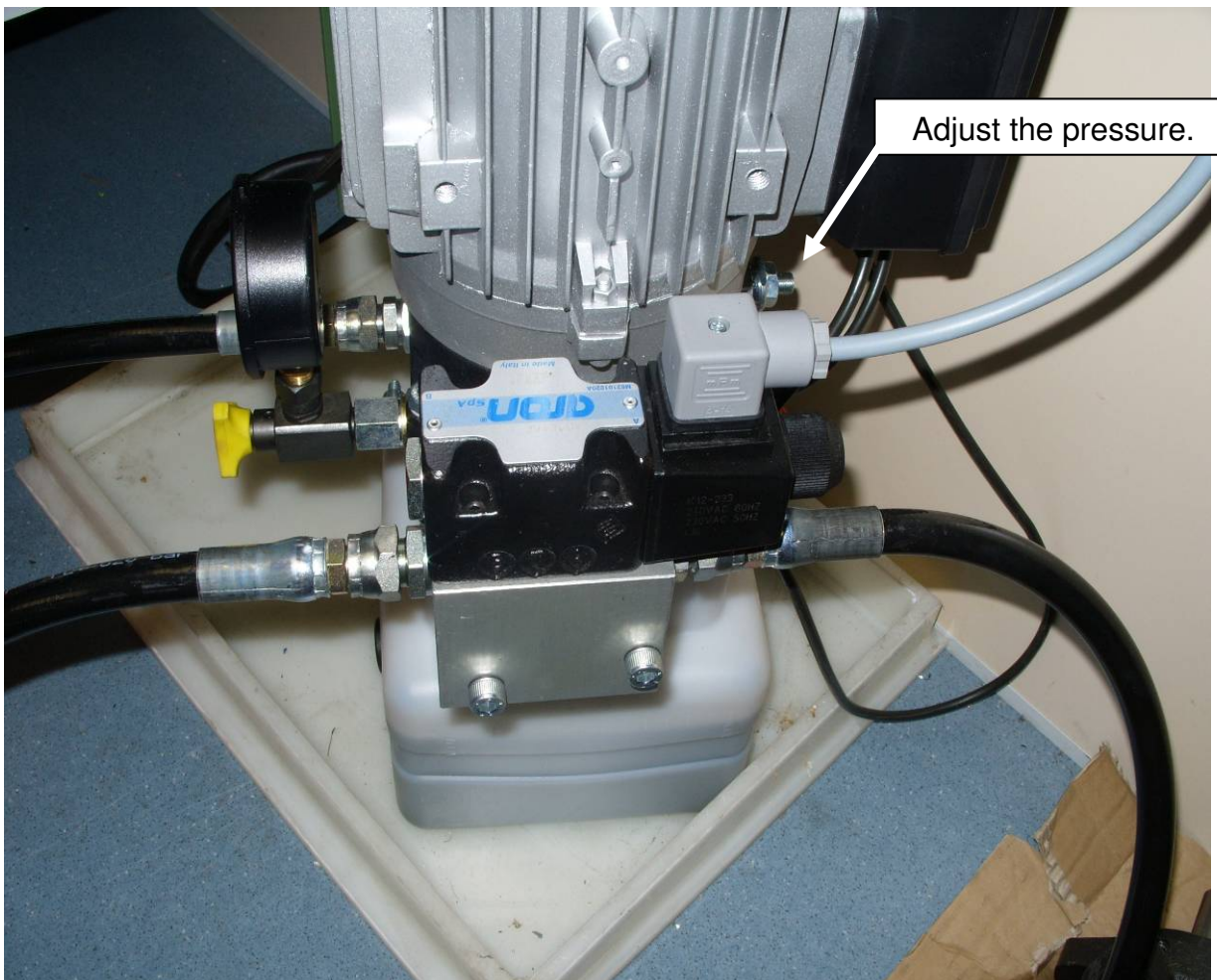

# ELECTRICAL CONNECTION

## Contactor side

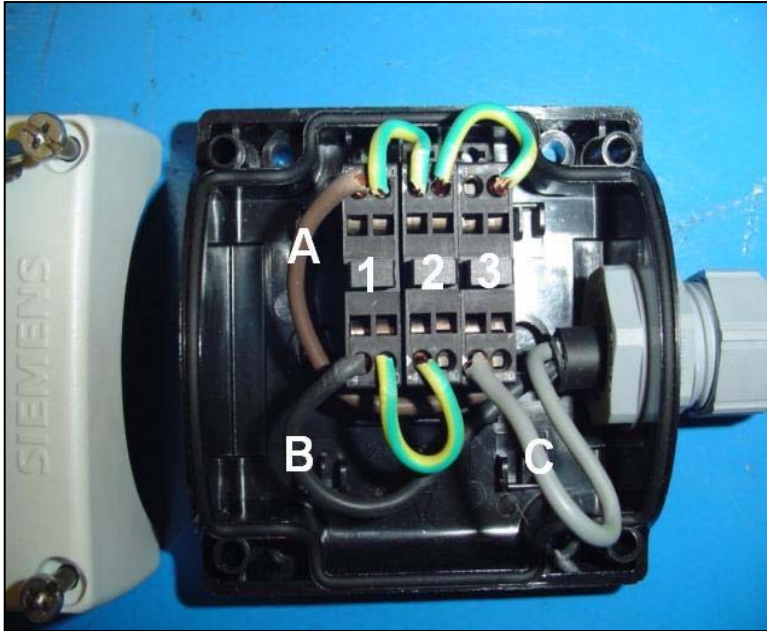

**Cable A** : Power supply 220 volts

**Cable B** : Motor power supply

**Cable C** : Solenoid valve power supply

**Mark 1** : Single contact to feed just the motor

**Mark 2 + Mark 3** : Parallel contact, the motor + the solenoid valve

## Power pack side

It is not necessary to install special equipment, a 16A socket is enough for the supply.



# ADJUSTING THE COVER

To avoid the cover and the loading bar leaning, it is necessary to adjust the winding tube. See diagram below.

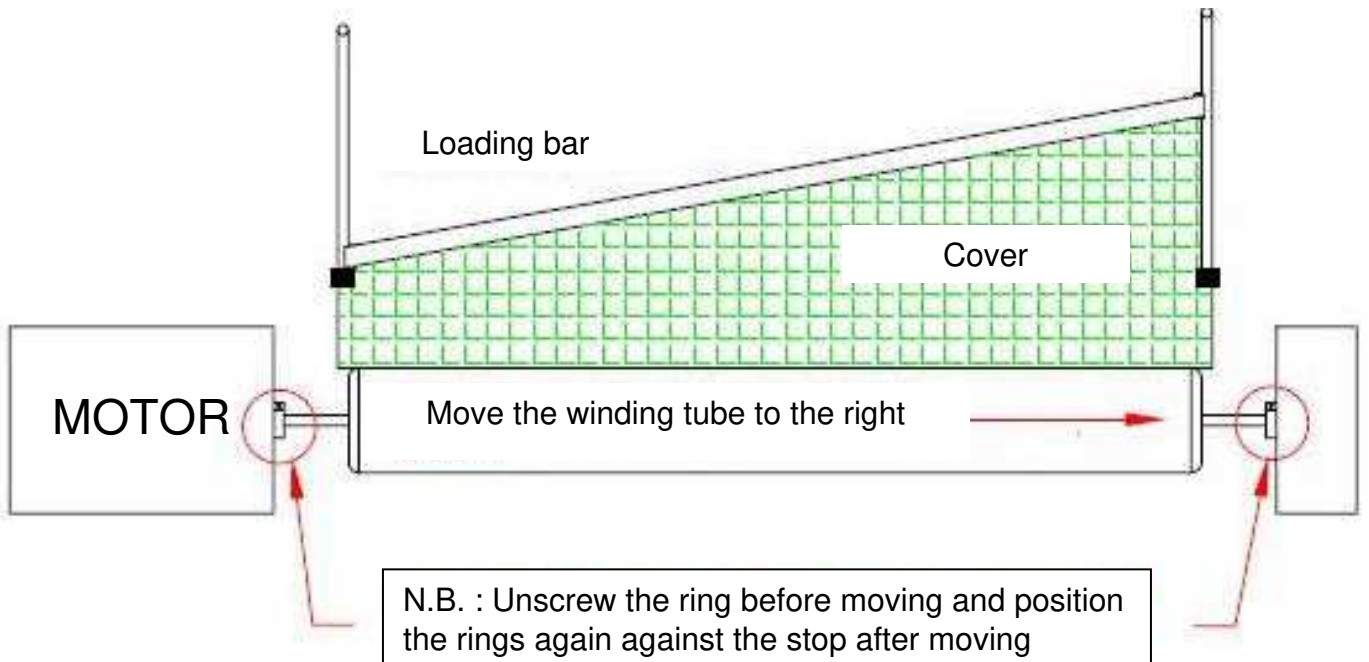
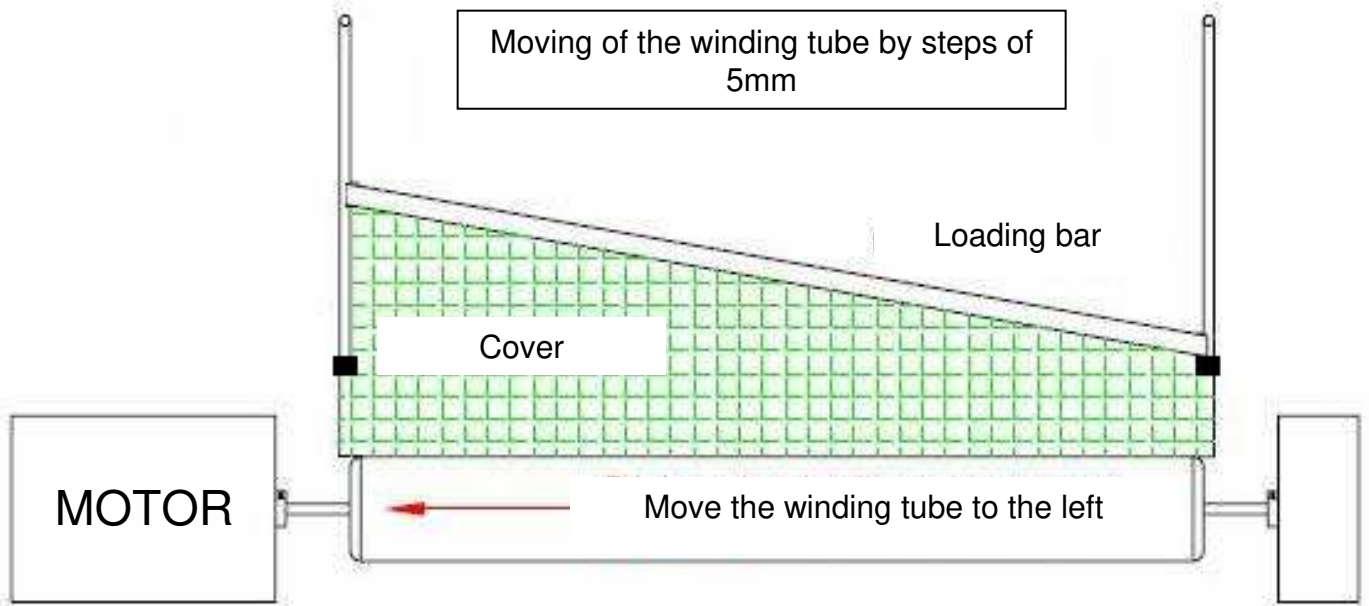

# RAINWATER REMOVAL PUMP



Fill the white container with water or sand to weigh down the pump on the cover.

Clean the blue filter.



See instructions enclosed with the pump.



# WALU LOCK automatic safety cover

## Models: TOP FLAT / TOP OUT / UNDER IN / UNDER FLAT / UNDER OUT

Meets standard  
NF P 90-308

### TECHNICAL INSTRUCTIONS

► READ THIS DOCUMENT CAREFULLY AND KEEP IT FOR FUTURE REFERENCE.

#### ❶ INSTRUCTIONS FOR USE

##### - Warning:

A swimming pool can be very dangerous for children. Drowning accidents happen quickly. Children playing in or near a swimming pool require constant vigilance and your active supervision even if they know how to swim. The physical presence of a responsible adult is indispensable at all times when the pool is open.

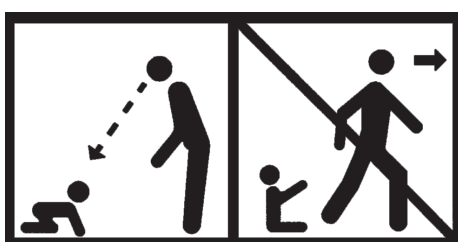

Memorise and display the following emergency numbers at the poolside:

• Fire service: ..... • Ambulance: ..... • Poison centre: .....

#### ❷ SAFETY RECOMMENDATIONS

- Safety is only guaranteed with a closed, locked cover correctly installed in accordance with our instructions.
- Always keep an eye on the pool while opening or closing the pool cover.
- The cover must systematically be put back in place even if you only leave the pool unattended for a few moments.
- Safety is only guaranteed with a closed, locked cover correctly installed in accordance with our instructions.
- This cover is no substitute for common sense and individual responsibility. It is not intended to replace the vigilance of parents and/or responsible adults, whose role in the protection of children remains essential.
- The cover must only be wound or unwound by a responsible adult, checking the pool to ensure that there are no bathers or foreign bodies in the water before and during the operation.
- Keep the key needed to operate the cover out of the reach of children.
- On no account may this cover be considered as a surface for walking on; therefore, never intentionally climb, walk or jump on the safety cover!
- Learn life-saving techniques.
- The physical presence of a responsible adult is indispensable at all times when the pool is open.

#### ❸ RECOMMENDATIONS FOR USE

##### - Winding up/unwinding the cover:

The cover must only be wound or unwound by a responsible adult, checking the pool to ensure that there are no bathers or foreign bodies in the water before and during the operation.

The operations to open or close the pool require the use of a key. Always remove the key after each operation and keep it in a place out of the reach of children. It is essential, for safety reasons, not to leave the cover part open.

Always keep an eye on the pool while opening or closing the pool cover.

Ensure there are no excess loads on the pit cover or bench - do not exceed the maximum load of 200 kg on the whole assembly or 100 kg per linear metre.

In normal conditions, one opening/closing cycle will enable the rainwater to run off the cover through the rainwater drainage grate. The impurities will be captured by the grate and can easily be eliminated using a garden pipe. In the event of storms, prolonged precipitation, periods of absence (holidays, for example) or during the winter period, it is essential to use the automatic rainwater removal pump to avoid water collecting on top of the cover.

## ④ CLEANING INSTRUCTIONS

You must clean the cover at least twice a year (preferably before and after the bathing season) using a special cleaning product for PVC fabric. Day-to-day cleaning is by water jet. In all cases avoid aggressive, foam-producing or solvent-containing products as well as abrasive sponges.

PVC pit covers or benches must be cleaned twice a year with a special PVC cleaner. Wooden pit covers or benches must be treated once a year with a special product for tropical hardwoods, taking care not to stain the cover underneath. For this reason, it is recommended that you treat the wood with the cover unwound over the pool. Aluminium bench or pit cover profiles can be cleaned using a gentle cleaning product (such as a household cleaner). Avoid abrasive products and sponges.

**Important:** the aluminium guide tracks must be cleaned at least once a month with a garden hose or high pressure washer to remove any debris that could prevent the smooth running of the cover.

## ⑤ MAINTENANCE INSTRUCTIONS

The whole cover assembly including the aluminium tracks must be inspected twice a year (when cleaning the cover, for example). An extra check will be necessary if the cover has had to be used for its safety function or after a period when it has been subjected to extreme conditions (high winds, heavy snowfall...). After these different inspections, it is essential to replace any constituent parts showing any wear or damage at all. If in doubt, please contact your swimming pool installer and specialist. All spare parts used must be **WALTER** original parts to ensure your cover continues to comply with the initial specifications, the warranty and the Standard.

Take all measures to prevent young children gaining access to the pool until the cover is repaired or if you notice any malfunction preventing it from closing and securing the pool.

For the after sales service, contact your dealer first.

For any other enquiries, our after sales department will be happy to help. Call +33 (0)3 90 29 51 17

## ⑥ SPECIFIC RECOMMENDATIONS FOR THE WINTER PERIOD

**WALU LOCK** will also give you every satisfaction in winter use as long as certain rules are followed:

The water level in the pool must always be at the normal level for use (2/3 up the skimmers) in summer and in winter. You must therefore ensure that the white goods and pipes do not freeze; to do this, it is recommended that you use the appropriate gizmos and plugs, as well as a line of winterising floaters across the width of one end of the pool to avoid any damage to your pool.

Ask your swimming pool installer and specialist for advice.

**Important:** The automatic rainwater removal pump must be in place when the pool is winterised to avoid water collecting on top of the pool cover. Place the pump in the middle of the cover and run the waste hose to a suitable drainage place around the pool. The transformer supplied with the pump must be placed more than 3.50 m away from the pool and out of the rain. Its electrical connection must also be protected against the weather and plugged into a socket that meets current electrical standards.

**Important:** The metal strainer underneath the pump must be removed (tighten the two lugs positioned above) and cleaned at least once a month to remove any impurities that could obstruct the passage of the water in the pump.

Also ensure that the waste pipe is not clogged up.



## **WARRANTY**

### **- Warranty conditions:**

- Your WALU LOCK automatic pool cover is guaranteed for 3 years in normal use, for the following parts: PVC fabric, aluminium tracks, aluminium shaft, leading edge bar and supports.
- The winding mechanism, the hydraulic pump and the hoses are guaranteed for 2 years.

### **- The warranty shall not apply in the following cases in particular:**

- incorrect assembly, failure to comply with the installation instructions and resulting damage,
- mishandling or abnormal use and resulting damage,
- normal wear and tear on the cover components,
- wear on the PVC fabric due to rough or abrasive coping,
- cleaning with products other than those recommended (see cleaning instructions),
- damage due to transport,
- drop in the water level.

As **WALU LOCK** covers are made to measure, we cannot be held liable for any errors in.

**WALU LOCK** covers must be installed and used in accordance with the "Technical instructions".

All claims must be made by registered letter with acknowledgment of receipt, and the equipment concerned must be made available for examination by our experts or those of our insurers.

For the after sales service, contact your dealer first.

The warranty covers only the replacement of parts or assemblies found to be defective, and excludes any liability, compensation, transport costs that may be claimed for any reason whatever.

Any modification of the cover and use of spare parts other than those supplied by **WALTER** shall invalidate the warranty and render the cover non-compliant with the Standard.

The warranty applies to installations performed in accordance with good professional practice, the applicable standards and our technical instructions.

**Losberger France S.A.S.**  
**WALTER PISCINE**  
**Z.I. BP 58**  
**F-67172 BRUMATH Cedex**  
**[www.walter-piscine.com](http://www.walter-piscine.com)**



**ATTESTATION DE CONFORMITE****aux exigences de sécurité de la norme NF P 90-308 (mai 2004) et amendements A1, A2 et A3  
Eléments de protection pour piscines enterrées non closes privées à usage individuel ou  
collectif – Couvertures de sécurité et dispositifs d'accrochage***Certificate of Conformity with the safety requirements of NF P 90-308 (May 2004) Standard and amendments A1, A2 and A3  
Protective elements for in-ground, barrier-free, private or collective use swimming pools – Safety covers and securing devices*Type de couverture de sécurité : **Bâche automatique 4 saisons**  
*Type of safety cover:*Marque et modèle : **WALU LOCK UNDER IN**  
*Mark and model:*Fabricant : **WALTER S.A.S.**  
*Manufacturer:* Z.I. - BP 58  
67172 BRUMATH CedexDemandeur de l'attestation : **WALTER S.A.S.**  
*Applicant:* Z.I. - BP 58  
67172 BRUMATH Cedex**Au vu du rapport d'examen sur dossier référencé G030537/CQPE/5, la couverture essayée est  
déclarée conforme aux exigences du document de référence.***On the basis of the results contained in the report reference G030537/CQPE/5, the safety cover tested is declared in conformity with  
the requirements of the above referenced document.*

Trappes, le 19 décembre 2006

**Le Chef de la Division  
Articles à usage Domestique ou de Loisir**  
*The Head of Domestic and Leisure Products Division***Bruno FAUVEL**

Cette attestation est délivrée dans les conditions suivantes :

1. Elle ne suppose que l'article essayé et pour les essais réalisés et pour les informations qui sont consignés dans le rapport référencé ci-dessus. Le LNE décline toute responsabilité en cas de non-conformité d'un des éléments de l'article essayé pour lequel le demandeur a fourni au LNE un certificat ou une garantie de la conformité aux normes en vigueur, le demandeur étant seul responsable de la véracité des documents qui produisent au LNE.
2. Elle n'implique pas aucune procédure de surveillance ou de contrôle de fabrication et de mise en place par le LNE.
3. La conformité à la norme référencée ci-dessus exonère pas de la conformité à la réglementation en vigueur.
4. Des copies peuvent être délivrées sur simple demande auprès du demandeur.

This certificate is issued under the following conditions:

1. It applies only to the tested item and to the tests or information specified in the report referenced above. The LNE declines any responsibility in the event of non conformity for one of the elements of the article tested for which the applicant provided to the LNE a certificate or a guarantee of the compliance with the standards in force, the applicant being the only person responsible of the veracity of the documents that he produces to the LNE.
2. It does not imply that LNE has performed any surveillance or control of its manufacture.
3. The conformity to the above referenced standard does not exempt from the conformity to the regulation in force.
4. Copies are available upon request by the applicant.

**Laboratoire national de métrologie et d'essais**Établissement public à caractère industriel et commercial • Siège social : 1, rue Gaston-Berlioz - 75724 Paris Cedex 15 • Tél. : 01 40 23 37 00  
Fax : 01 40 23 37 37 • e-mail : info@lne.fr • Internet : www.lne.fr • Siret : 515 325 214 00012 • NAF : 743 B • TVA : 23 02 315 320 244  
Banque Paris Central LEAN : 6376 3058 8000 0149 7267 4000 170 BIC : BARCF33P