



# WALU ROLL

SUBMERGED WITH TUBULAR DRIVEN MOTOR

## Mounting instructions

*Swimming pool with or without dividing wall*

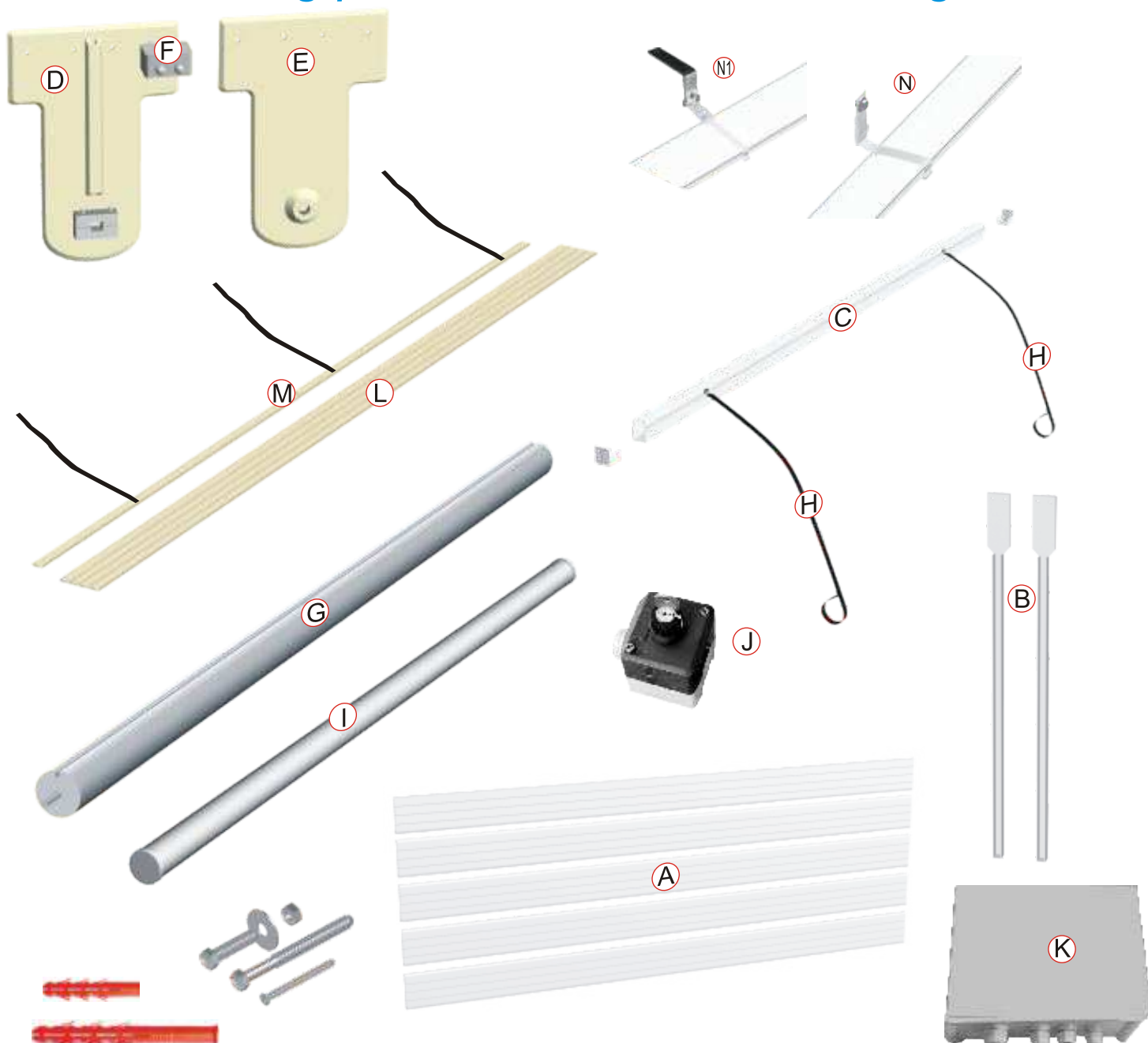

**Tools you will need, not provided**

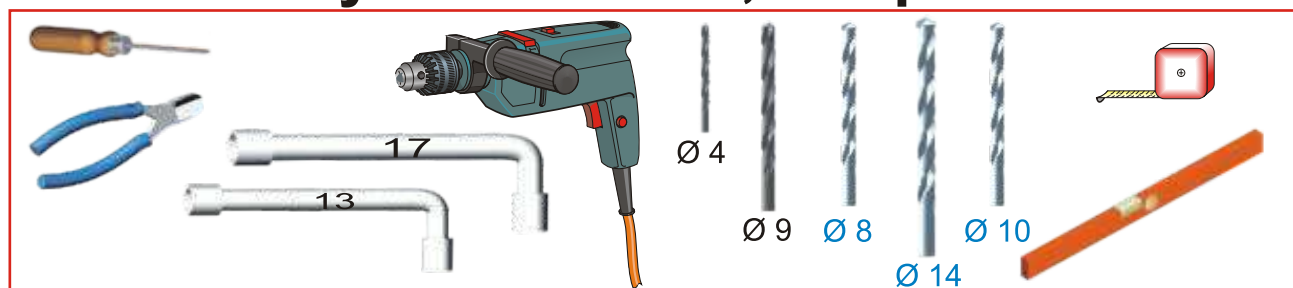

# Swimming pool without dividing wall

## Partition wall fitting

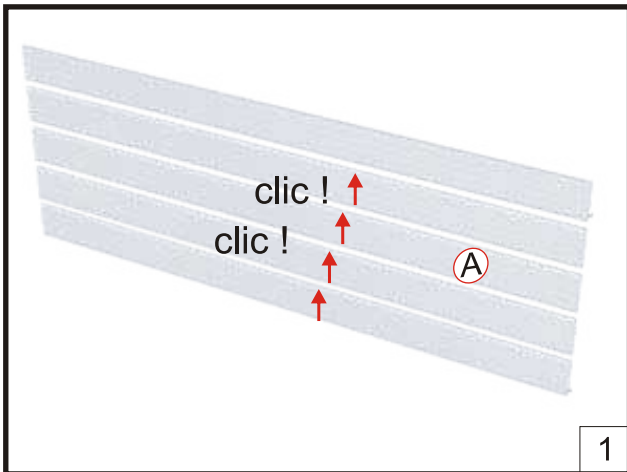

Fit into each other the intermediate A blades constituting the partition wall.

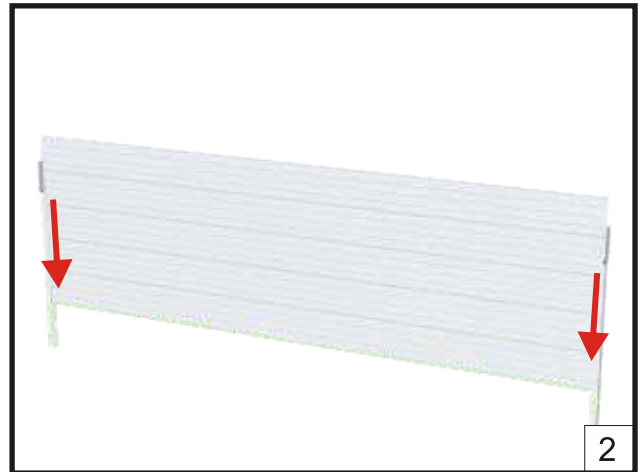

Engage the partition in both uprights.

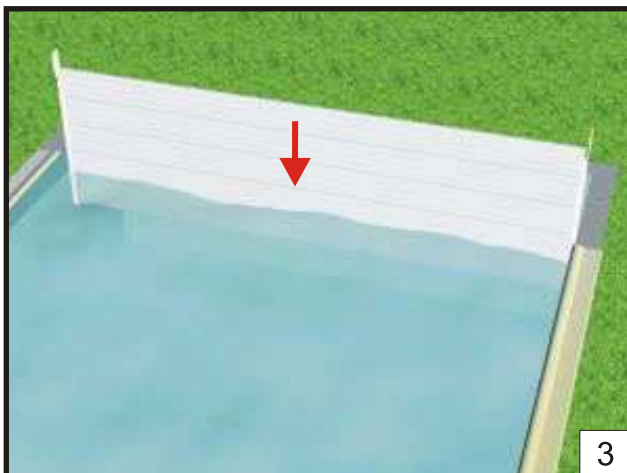

*The following steps do not necessitate emptying the pool.*  
Position the partition in the water. Align the assembly in its upper part.

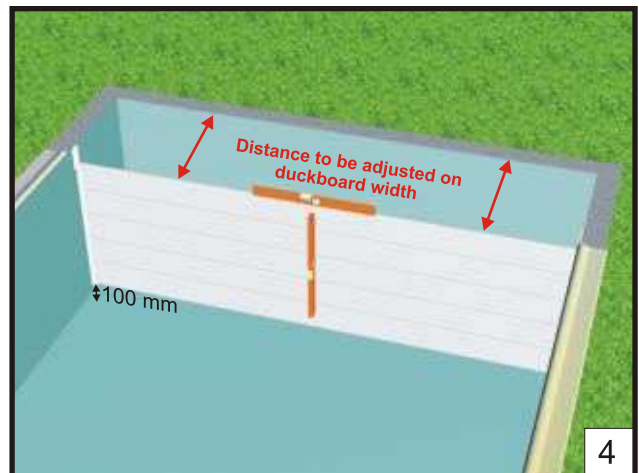

Check that it is level and horizontal. The partition uprights shall be placed 100 mm above the pool bottom.

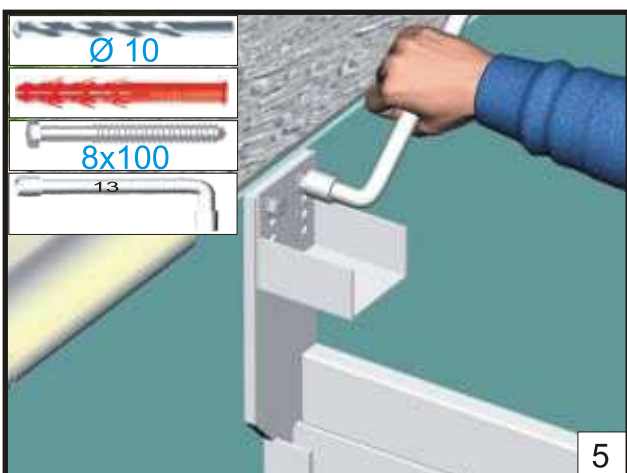

Fix the beam shoe on the wall support. For a bricked swimming pool, it is possible to screw them directly.

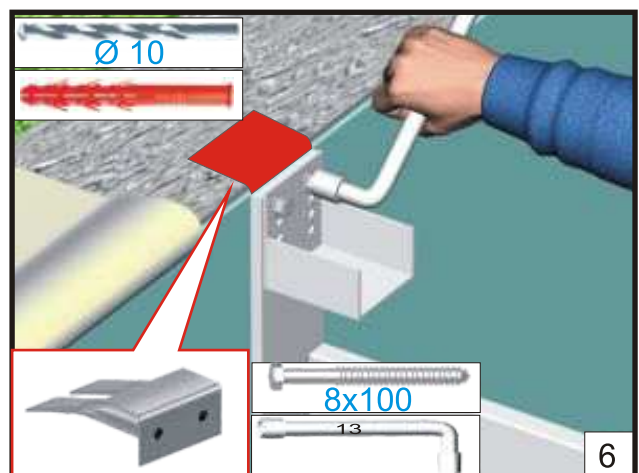

In case of a new swimming pool, it is preferable to seal the provided set square first in the masonry.

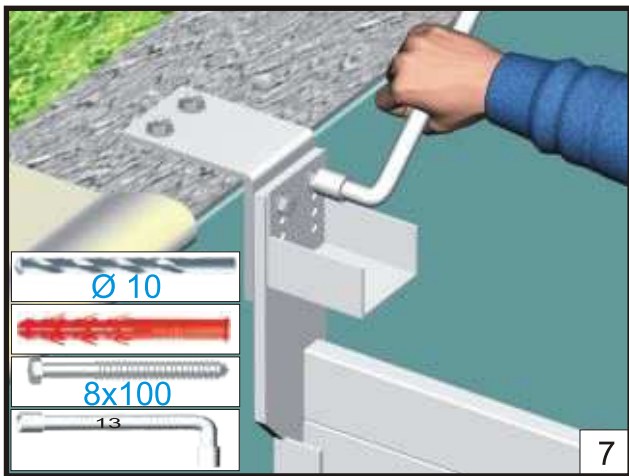

You also have the possibility to fix the wall support as top of foundation.

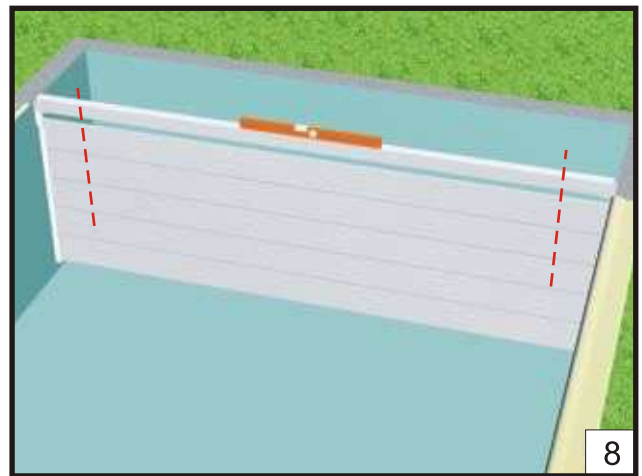

Place the beam in the shoes. Check the level.

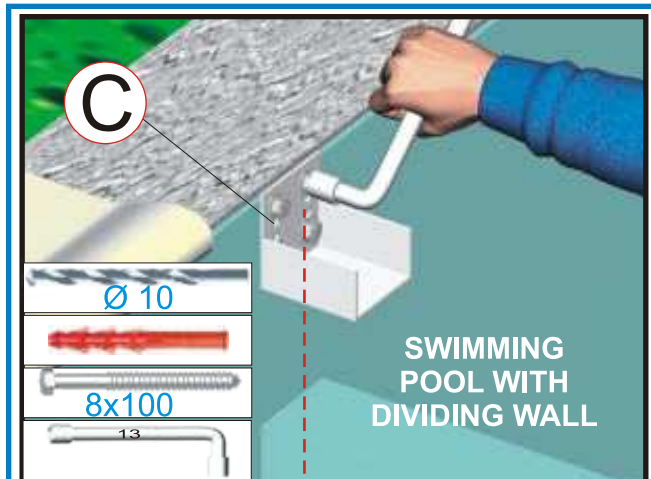

In case of a swimming pool WITH A DIVIDING WALL, fix the beam level to this wall and align it as indicated above.

# Cover roller fitting

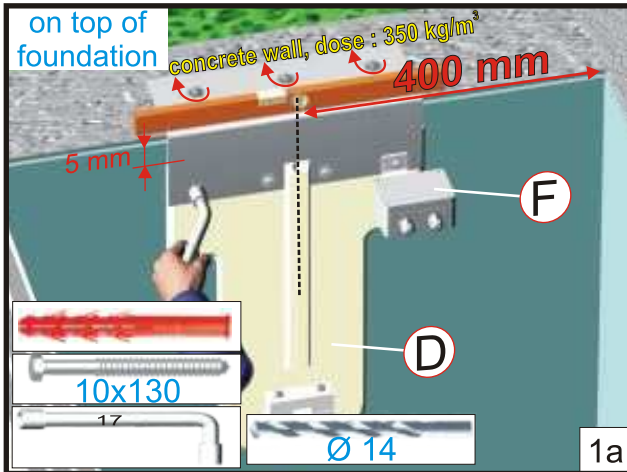

Use one of the fixing holes to fix the switch box.

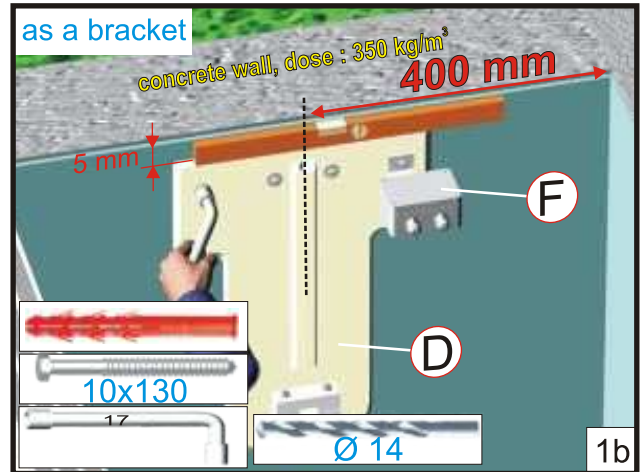

Use one of the fixing holes to fix the switch box.

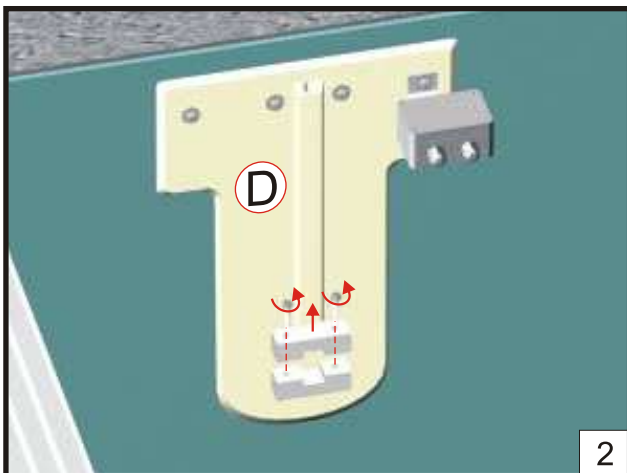

Unscrew the motor support.

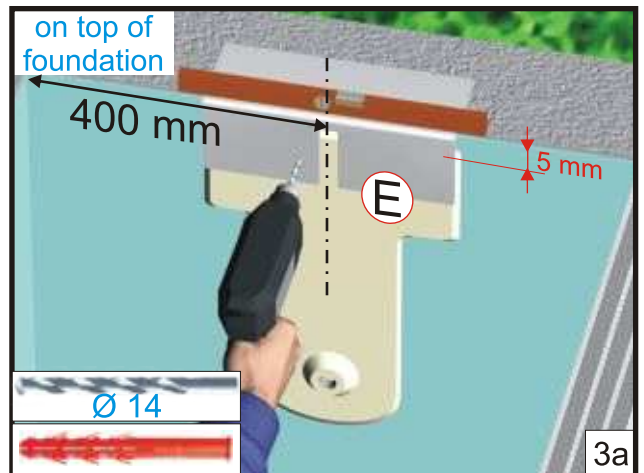

Do the same way as the other plate, but **do not fix it**.

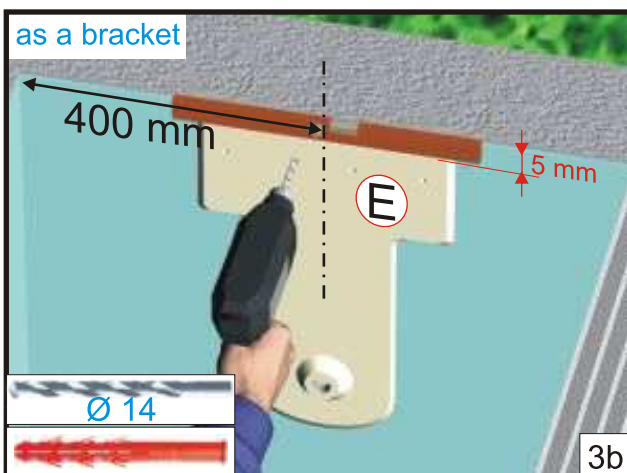

Do the same way as the other plate, but **do not fix it**.



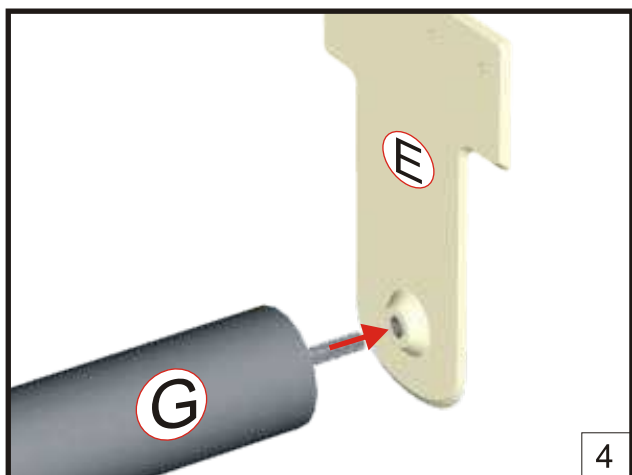

Outside of the pool, engage the shaft in the taken off plate.

4

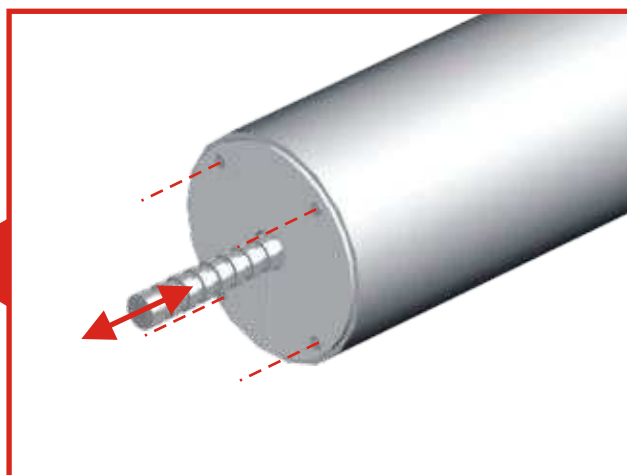

Pull out some screws of the semicircular parts, so as to adjust the outside length of the axle if necessary.

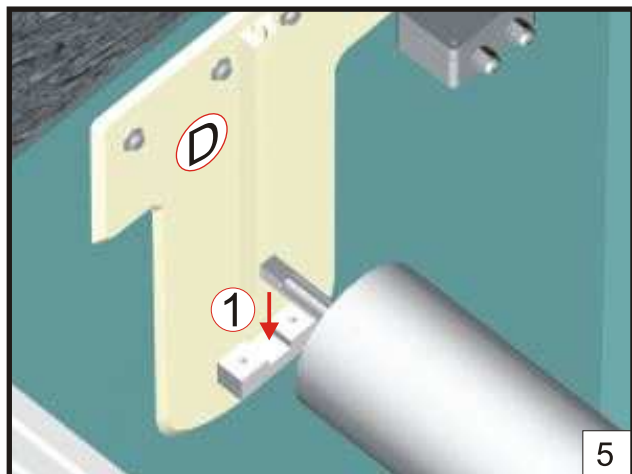

Take the shaft/plate assembly down in the pool and position the shaft on motor side in its plate support...

5

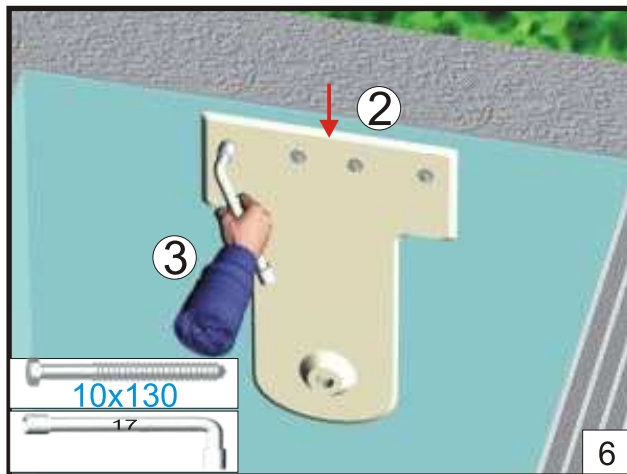

... then screw the plate opposite to the motor.

6

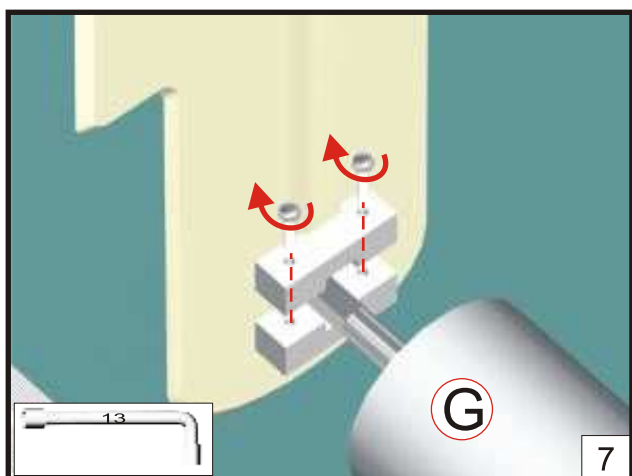

Block the shaft on motor side by screwing the support back again.

7

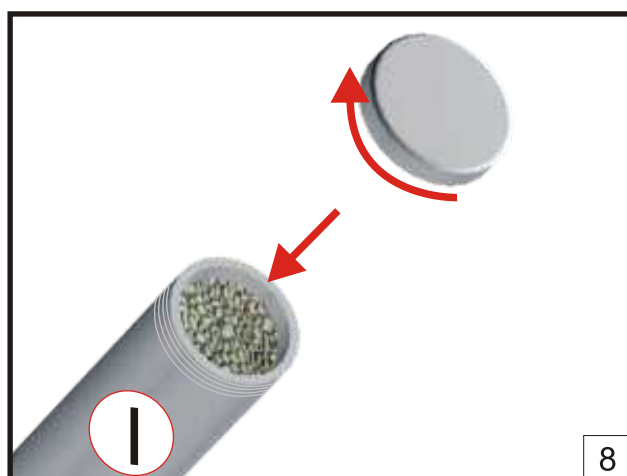

Fill the counterweight with fine gravels and replace it in its straps.

8

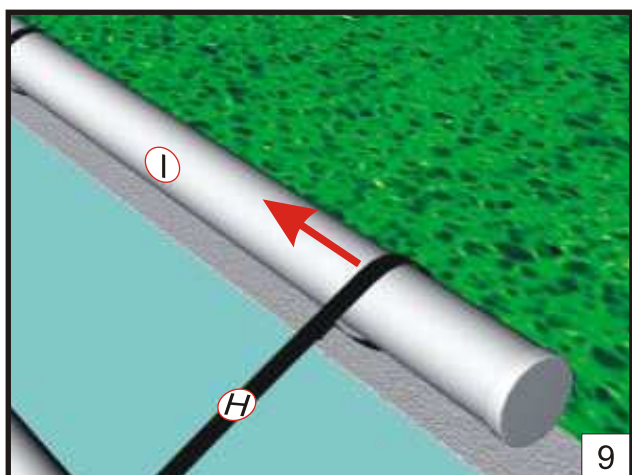

Engage the counterweight in the straps.

9

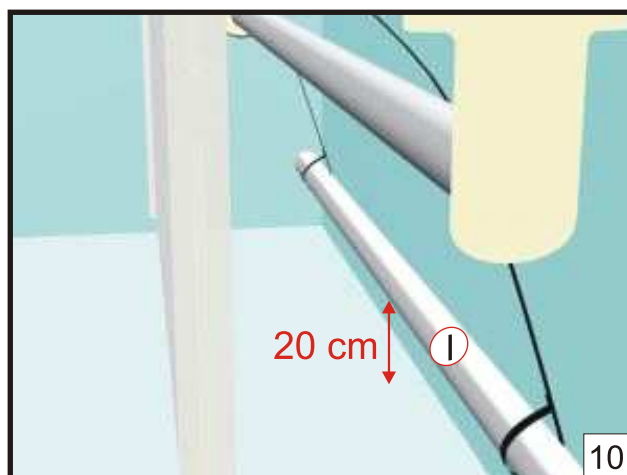

Fit the counterweight. It shall be positioned 20 cm minimum above the pool bottom.

10

# Electrical wiring

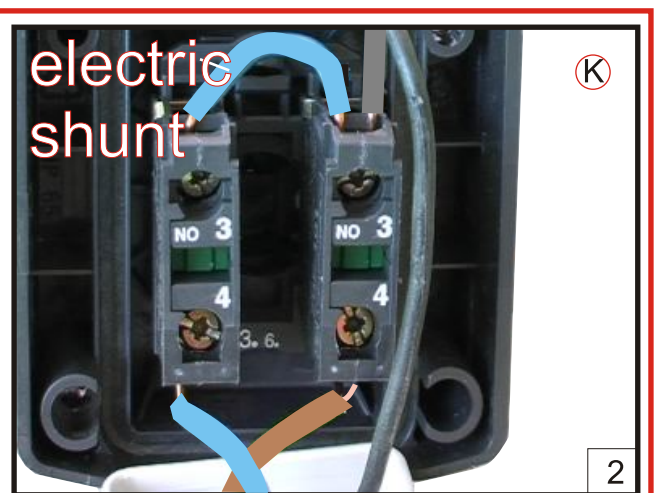
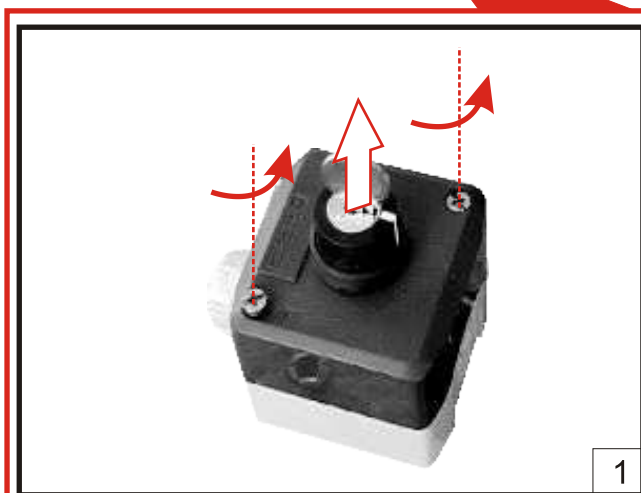
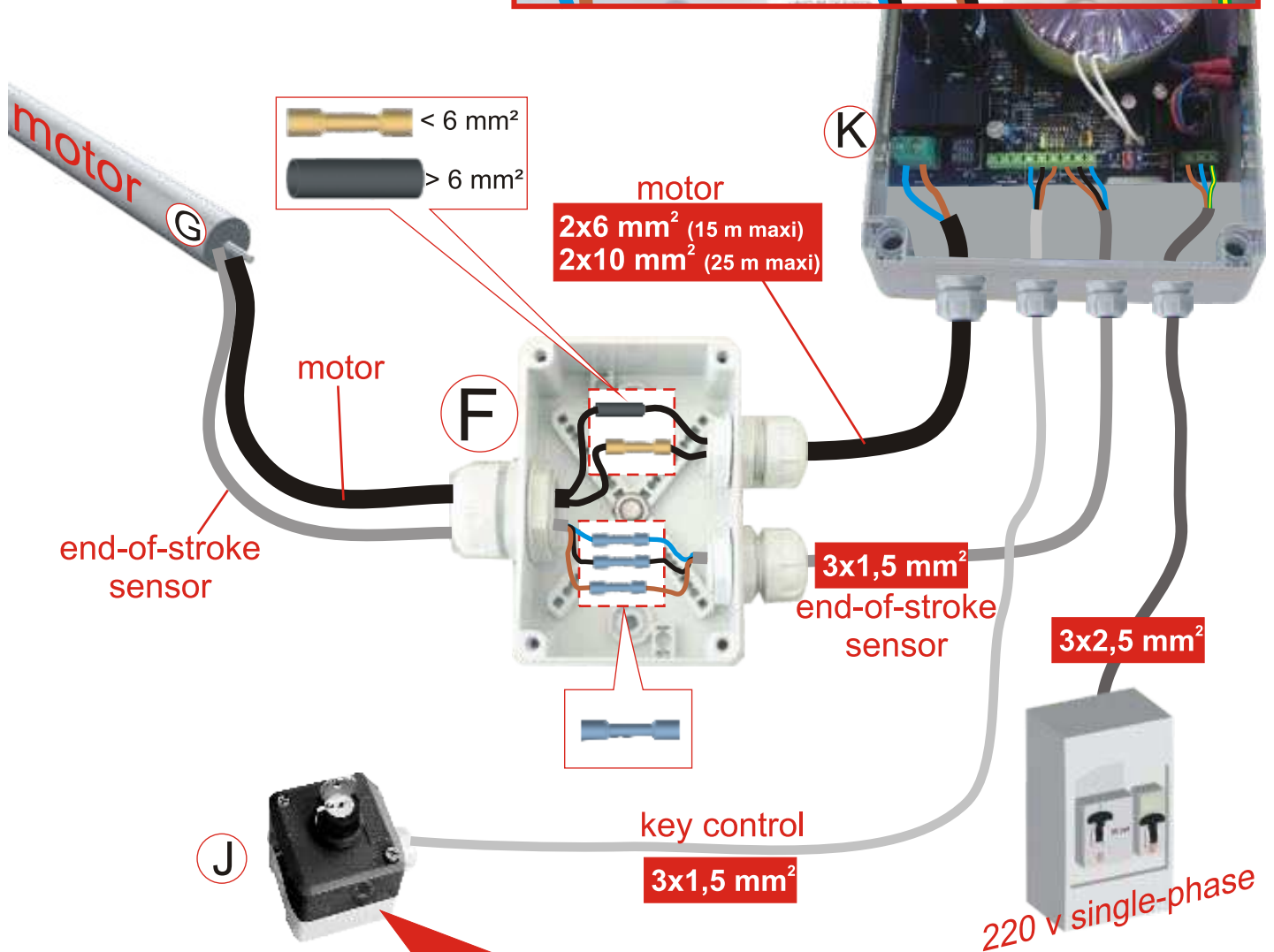
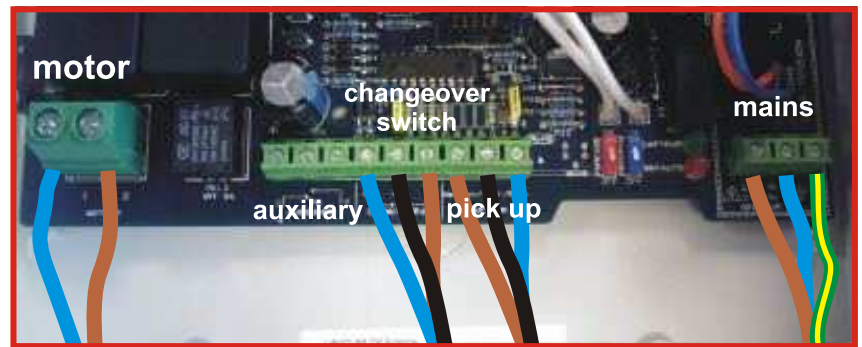

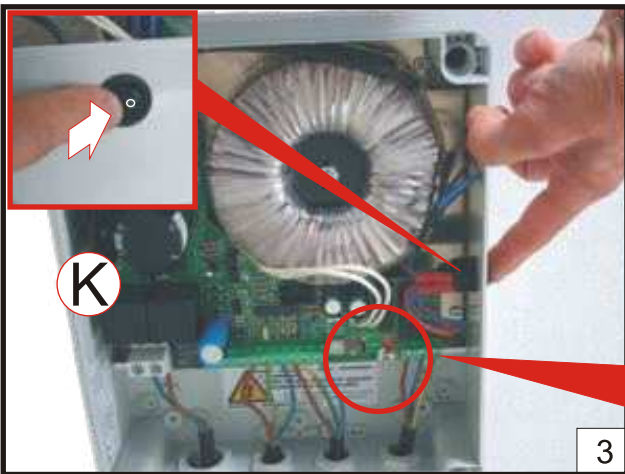

Before performing the adjustments, first check the connections for compliance. Switch on the installation by pushing the "power" button (I).

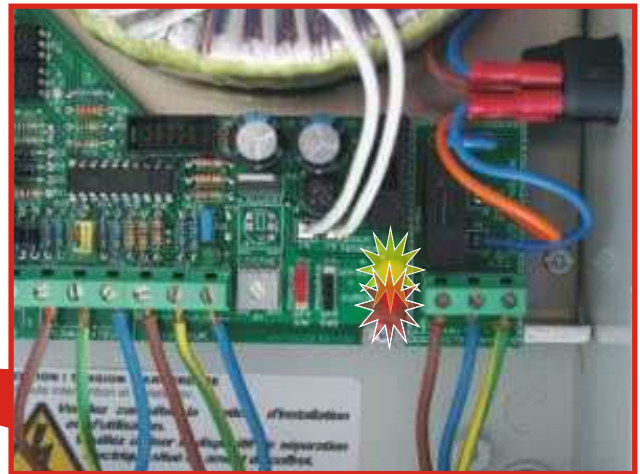

The red and yellow light-emitting diodes flash. If not, check the electric connections.

## Fitting a retractile sheath and anti-humidity lugs

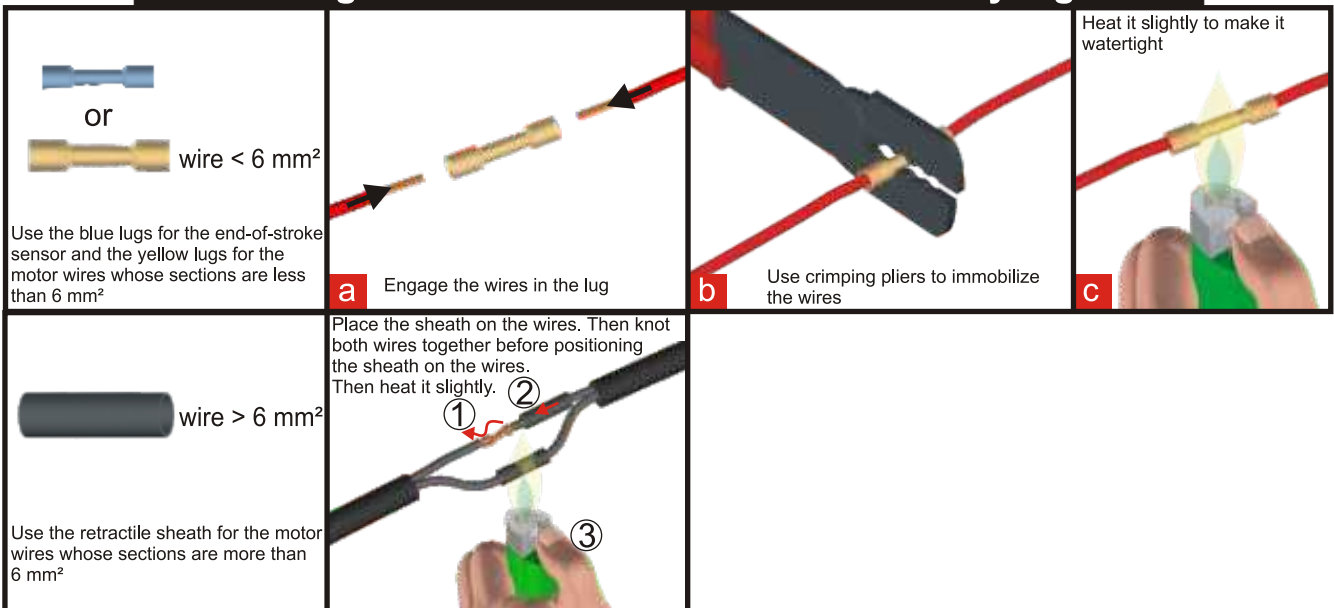

## INFORMATION ON SWITCH BOX AN 1030

*For information about the installation (electric connections and adjustments), refer to the instructions*

1. Compatibility :
  - For PL 3000 motor, use an ATO 25 A fuse (automobile type).
  - For PL 3200 motor, use an ATO 15 A fuse (original fuse); for double motor, use an ATO 25 A fuse.
  - Incompatible with DL 1300 and DL3000 motors (mechanical end-of-strokes), use a switch box AN 1010.
2. Power supply 240 VAC :
  - Terminal board to the far right of the card (any other connections would lead to destruction)
  - Power indication: green (permanent) LED situated at the right of the card.
3. Forced mode : (red switch)
  - Sensor input inhibited
  - Overload detector inefficient

**WARNING:** using the forced mode means programming the end-of-stroke again.

4. LED signal "motor" sensor (small green LED above of the sensor terminal board)
  - Motor stopped : led on or off
  - Motor stopped, sensor is functioning correctly : led flashes regularly
  - Motor running, sensor with malfunction : led does not flash or off

**Note :** in case of malfunction, (normal or programming mode), the motor stops and the red "overload" LED flashes, check the connections and the sensor connections.

5. Auxiliary relay (to activate an electrolysis system or other)
  - Description: 3 A dry contact 30 VDC, with common contact (c) and de-energized (r) /energized (t) contacts.
  - Normal mode with shutter completely open : relay energized (t)
  - Normal mode with shutter in intermediate position or closed : relay de-energized (r)
  - Forced mode, the relay is in the last direction of the key control :
    - \*opening direction: relay de-energized
    - \*closing direction: relay energized
6. Box fixing
  - Use the 4 holes at the 4 corners of the box (conical holes for screw centering).

If this type of fixing is not respected, this may lead to cancelling the guarantee.



# Shutter fitting

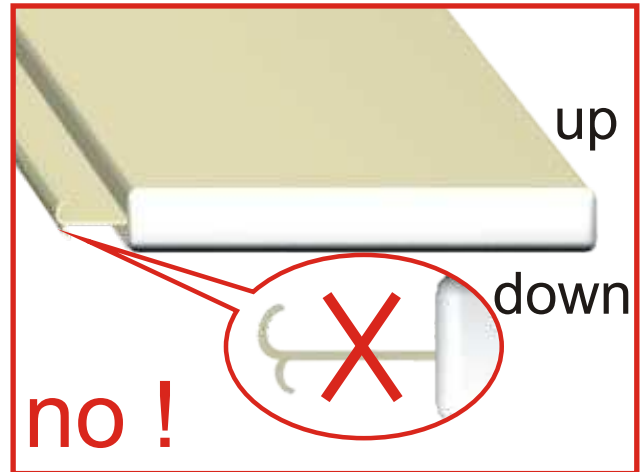
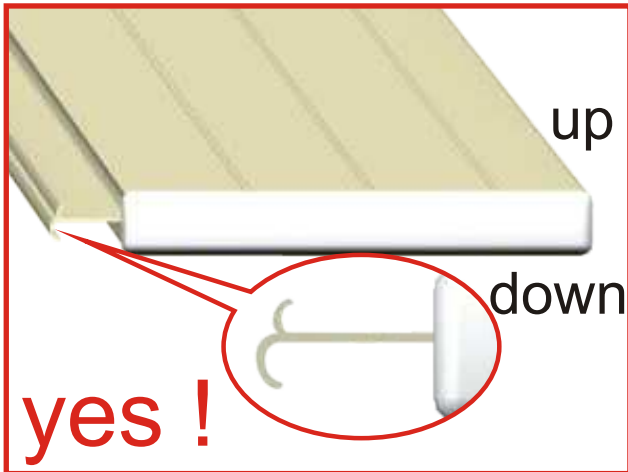

DETAIL OF THE BLADE POSITION : be careful with the direction of the blades.

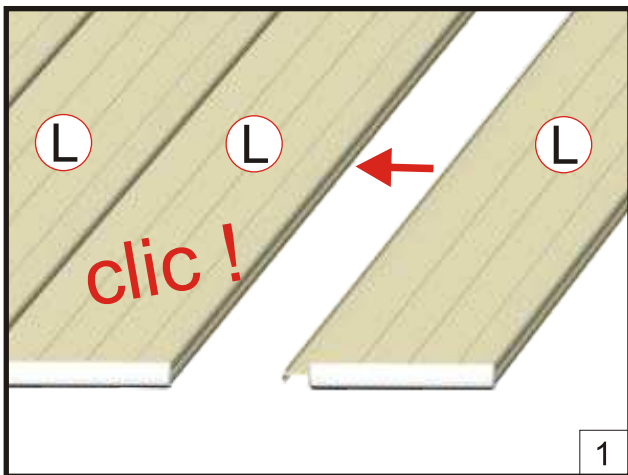

Fit the blades into each other to form the shutter.

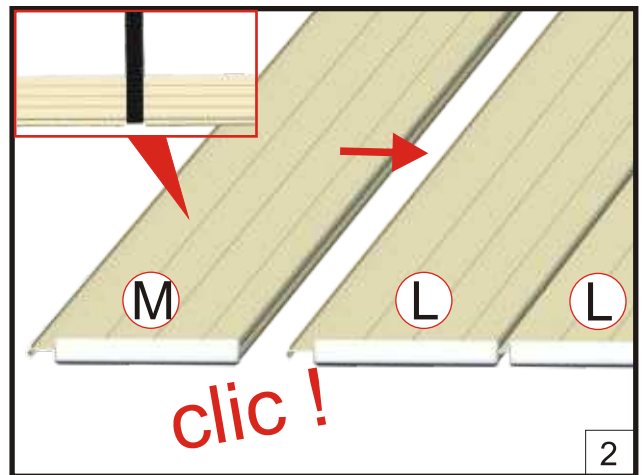

End with the beginning blade.

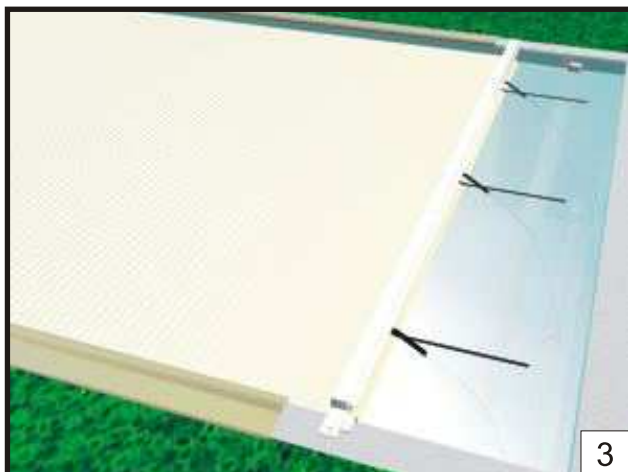

Position the shutter on the water surface.



Bend the strap end and cut a half-disk in the center to make a circular hole.



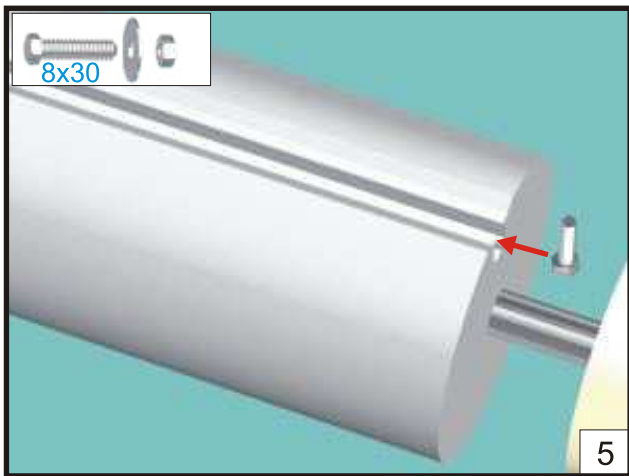

Engage the fixing screws in the roller groove. They must be facing the straps.

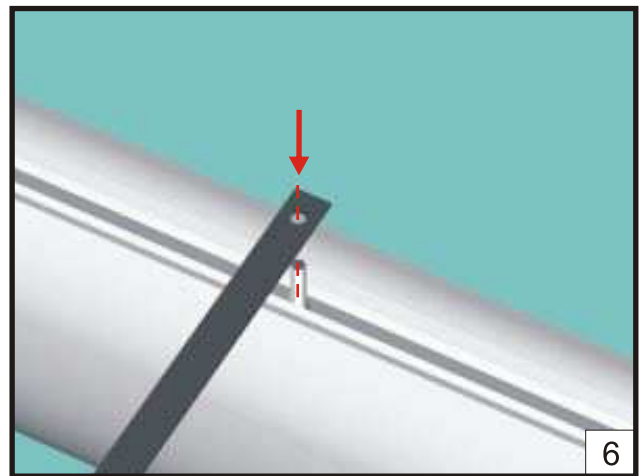

Insert the straps on the screws.

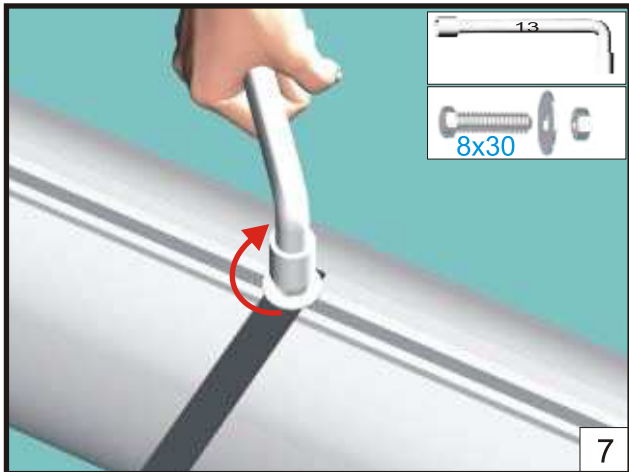

Block the straps with the provided washers and nuts.

# Fitting a shutter for roman stairs

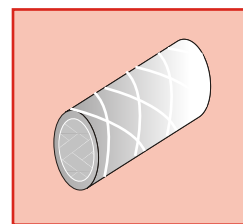
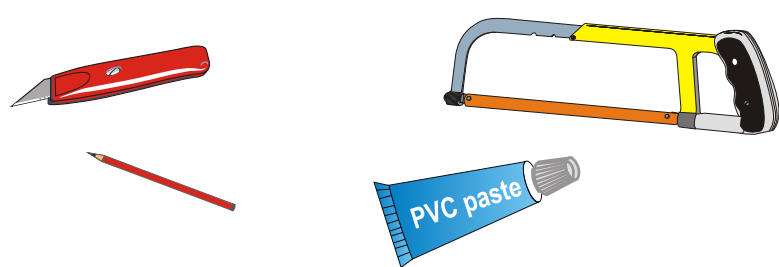

**Tools you will need, not provided**

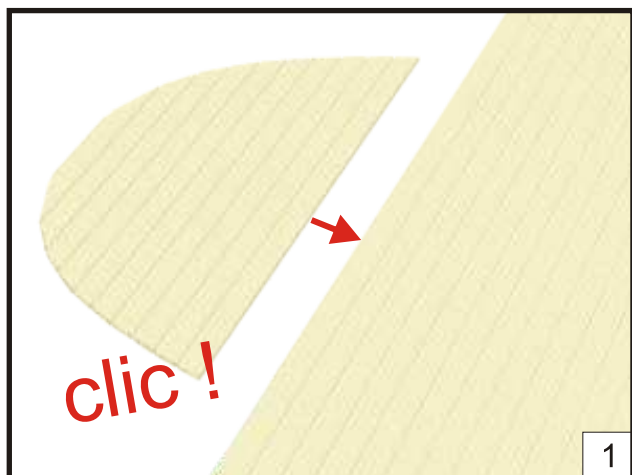

Fit in the cut-out part (for the stairs) in the shutter.

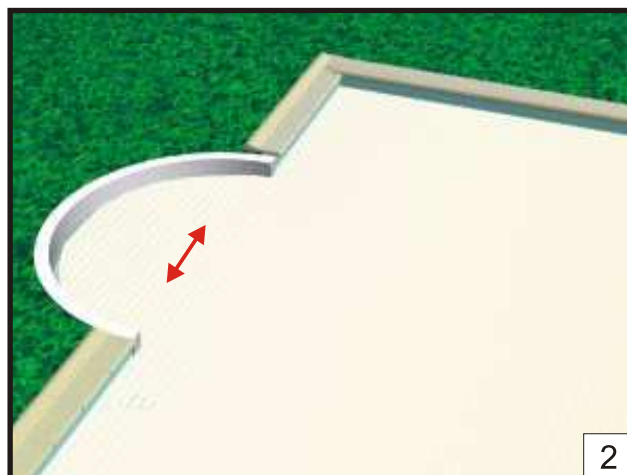

Position the shutter in the pool and place the rounded part above the stairs.

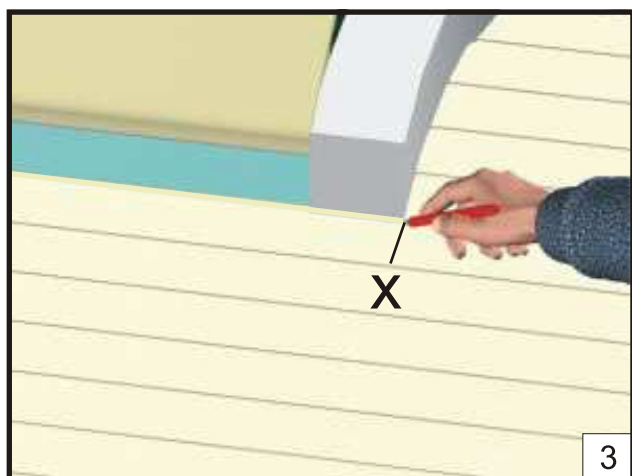

Mark out the edge of the stairs on the first blade.

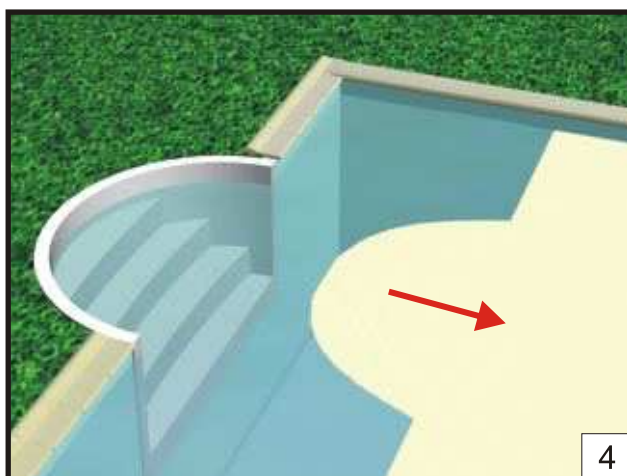

Move back the shutter so as to be able to work on it.

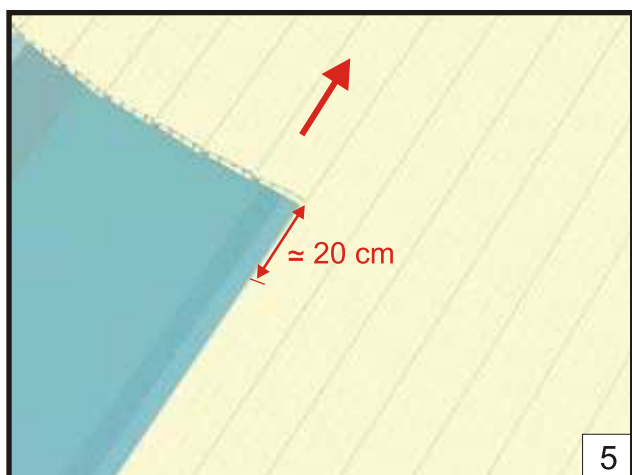

Shift forward the rounded part by approximately 20 cm.

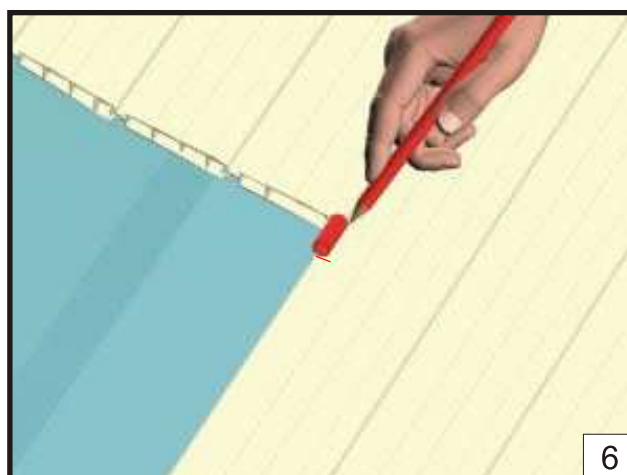

Locate the position of the little tube provided in relation to the reference mark.

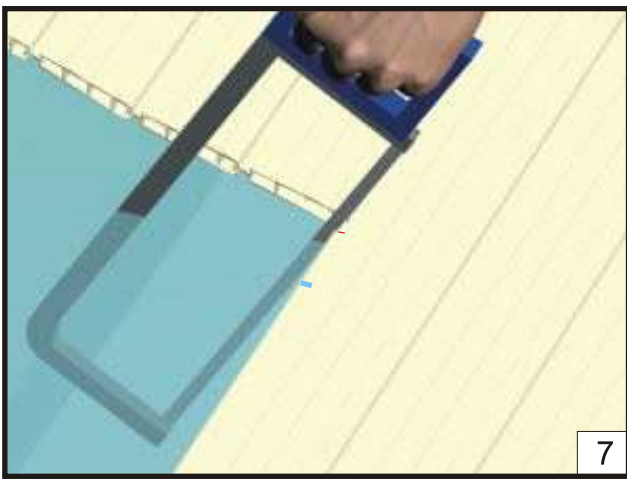

With a hacksaw cut the strip ends along the marks.

7

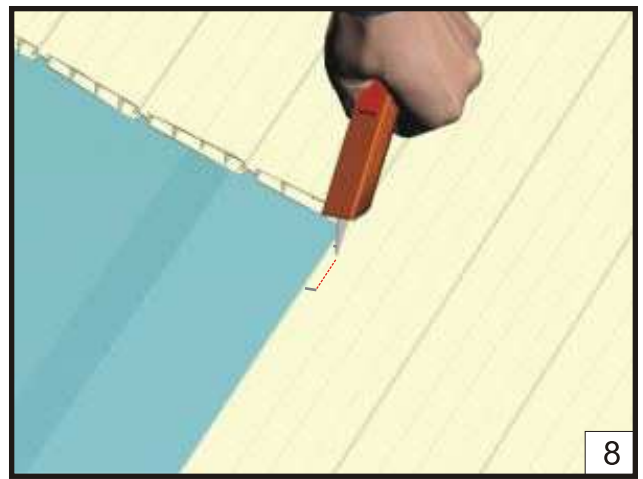

Score a line with a Stanley knife between both cutting-lines.

8

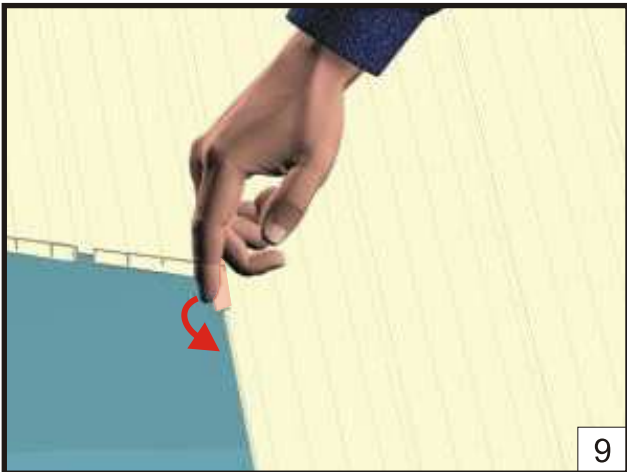

Take the piece out.

9

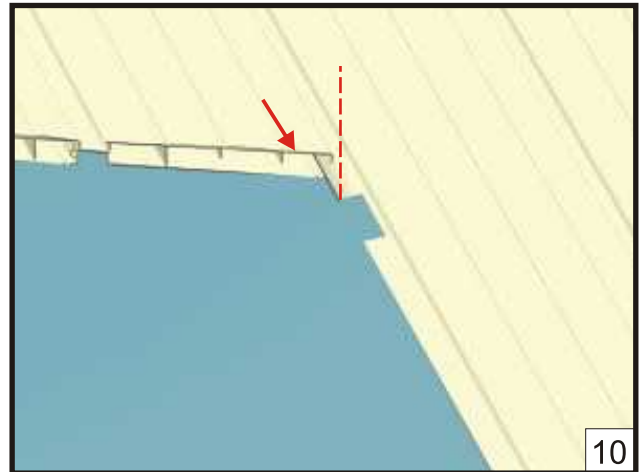

Reposition the rounded part of the shutter up to the edge of the opening you just cut out.

10



Paste one of the tube end.

11

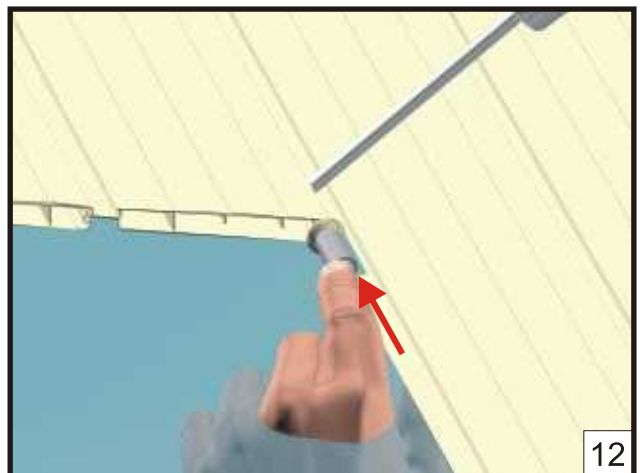

Position the tube in the opening, lever up the first blade of the rounded part of the shutter with a flat screwdriver and engage the tube in the blade.

12

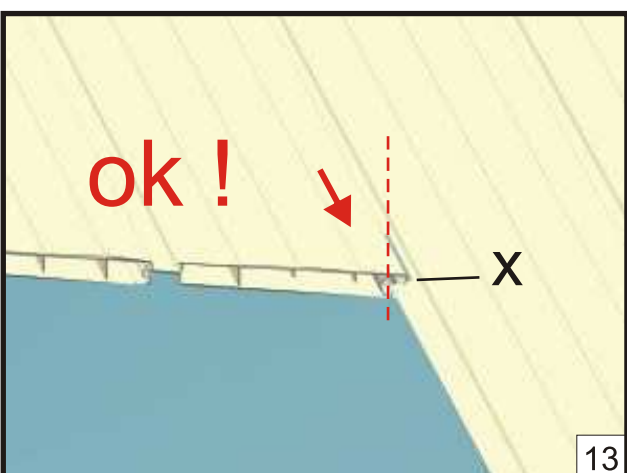

Reposition the rounded part and align it with the initial reference mark (X).

13

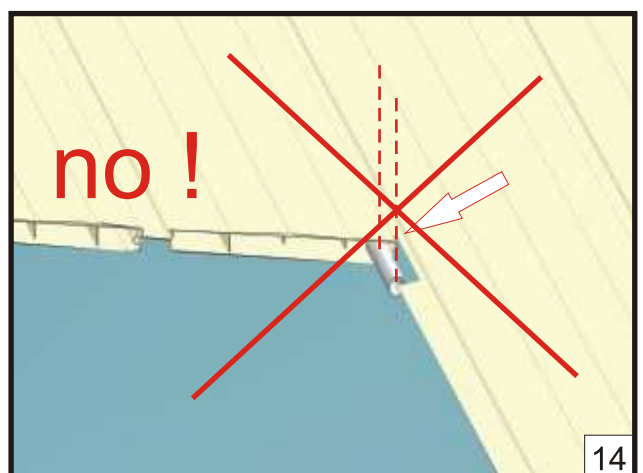

Be careful with the tube position.

14

# End-of-stroke adjustments

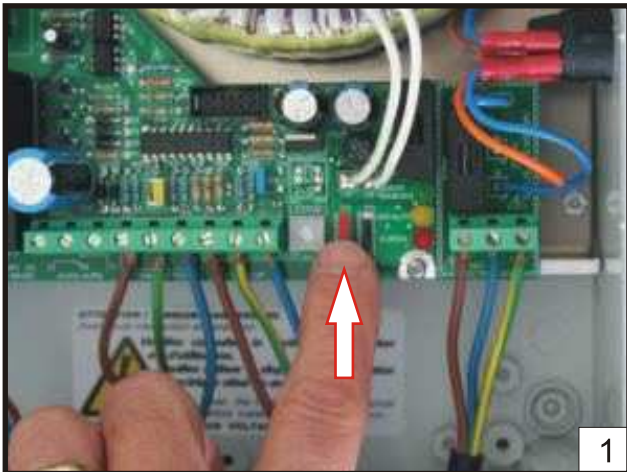

Switch **ON** the red contactor.

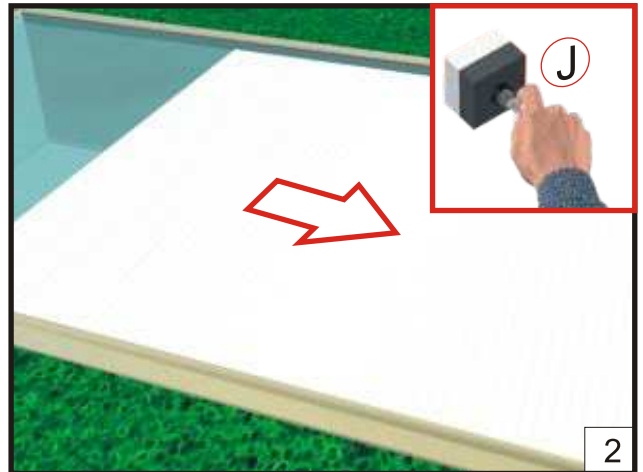

Roll the shutter up, by activating the key control.

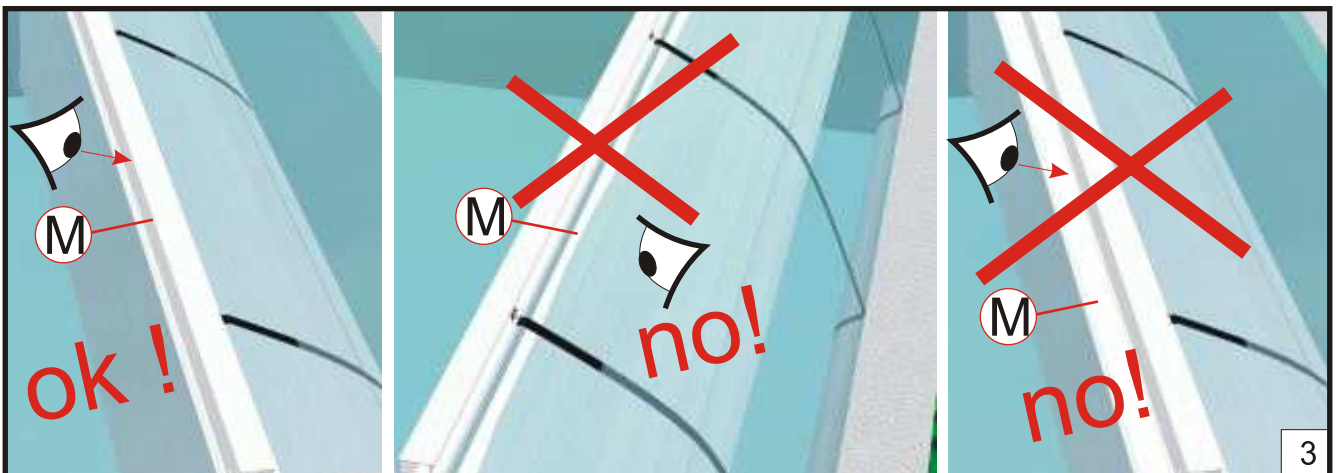

## SWIMMING POOL **WITHOUT** SKIMMER

Stop rolling the shutter as soon as the M last blade of the shutter is correctly positioned under the beam.

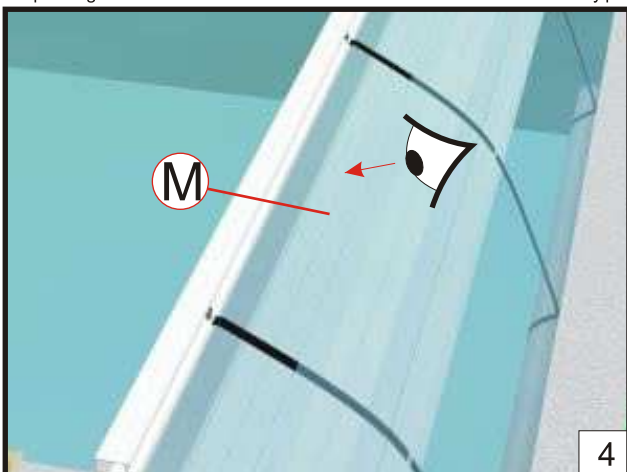

## SWIMMING POOL **WITH** SKIMMER

This is the correct position of the last blade when the shutter is rolled up.

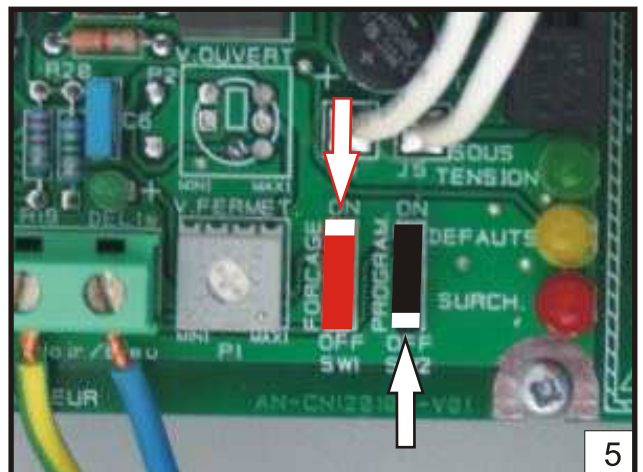

Switch **OFF** the red contactor, then switch **ON** the black one.



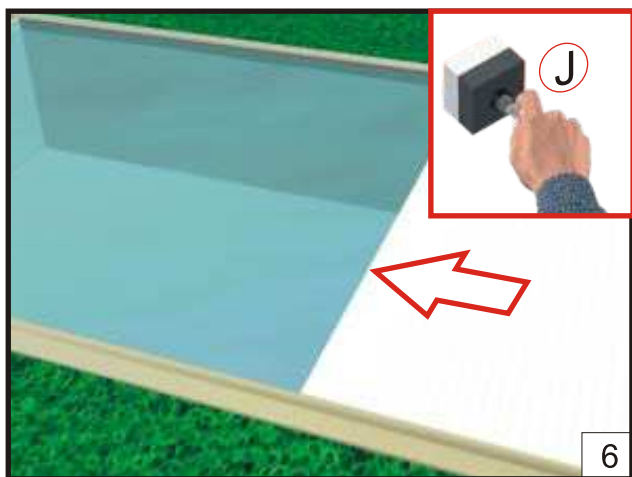

6 COMPLETELY unroll the shutter, by activating the key control. Stop the maneuver as soon as the blade is in contact with the pool wall.

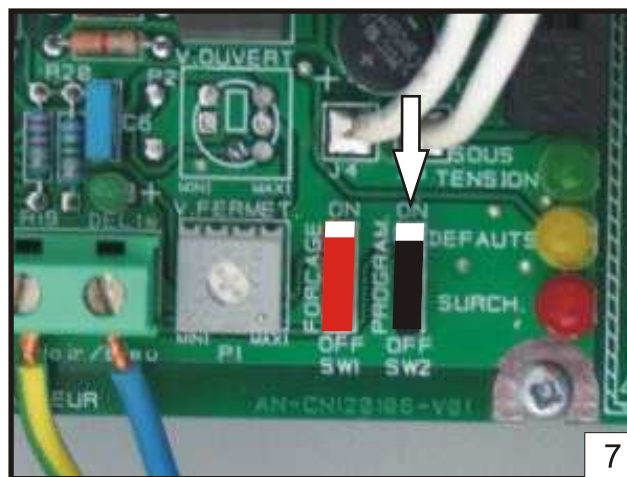

7 Switch **OFF** the **black** contactor. The adjustments are done.

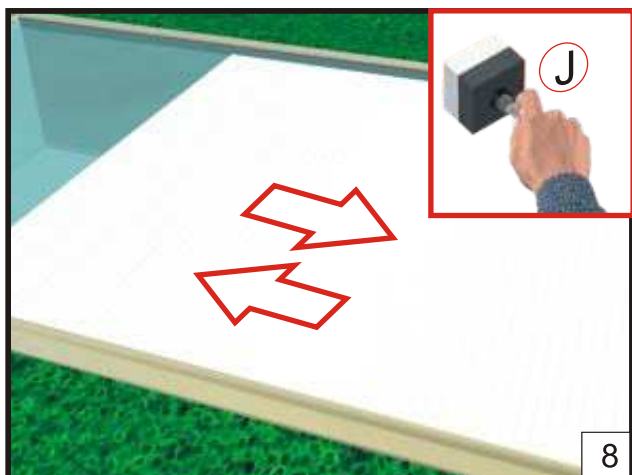

8 Perform the shutter opening and closing tests.

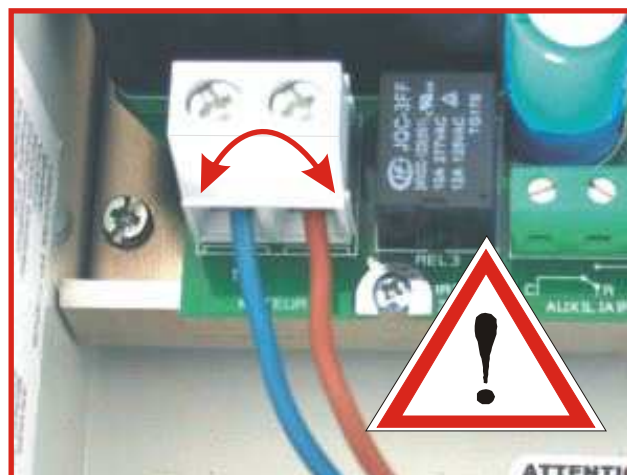

If the shutter does not stop as indicated before, invert the blue and black supply wires, then do the operations 1 to 7 again.

For more information, see page 7.

# Security system

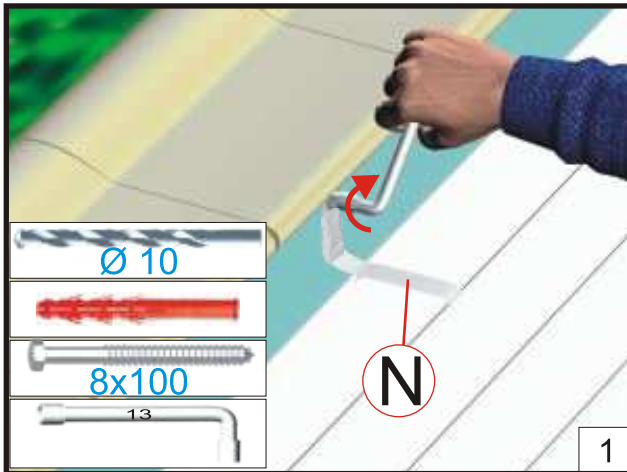

Fix the strap with the required fastening on the face of the pool end.

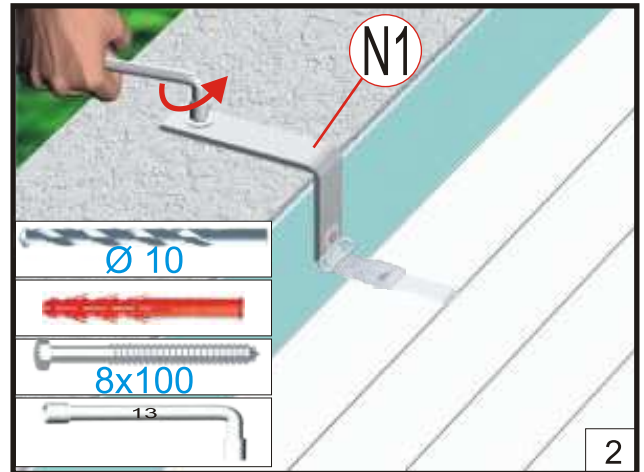

If the pool edges are not installed, fix the shutter strap on the concrete slab by means of the set square. Then pass the strap in the ring.

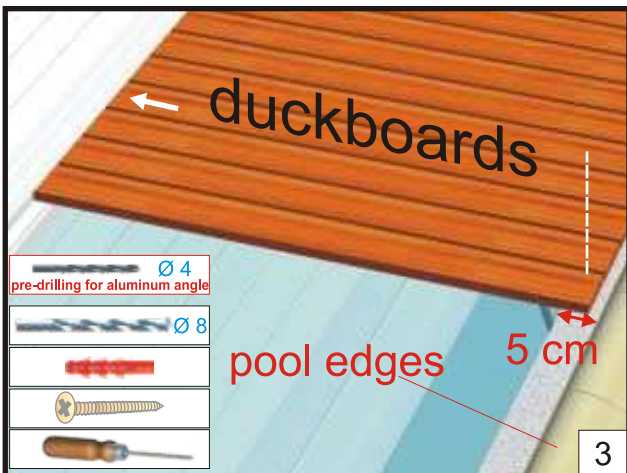

Engage the duckboards in the beam groove and fix them in the masonry (on edge side).

*notes*





Z.I B.P 58  
F-67172 BRUMATH CEDEX  
Tél : +33 3 90 29 51 00 - Fax : +33 3 90 29 51 19