



WALU ROLL JUNIOR

Mounting instructions



Tools you will need, not provided

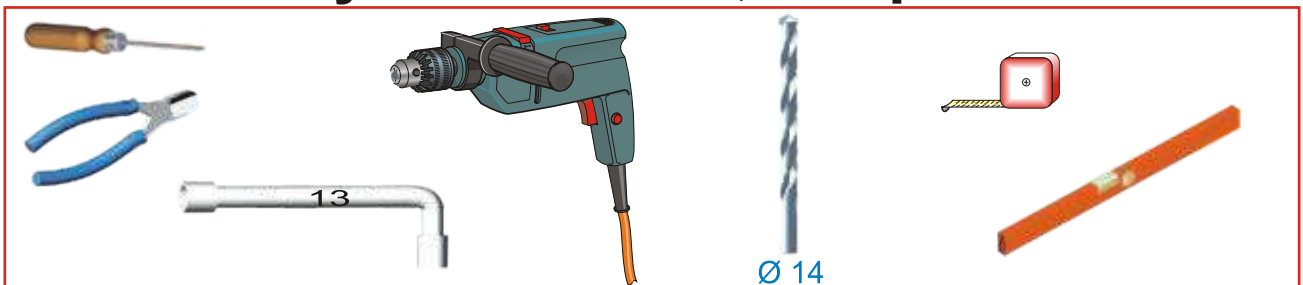

Cover roller fitting

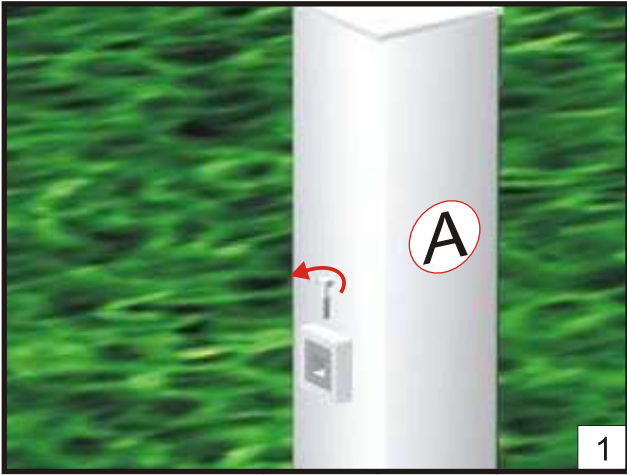

To begin with, pull out the screw (it acts as a pin) on the plate of the A post.

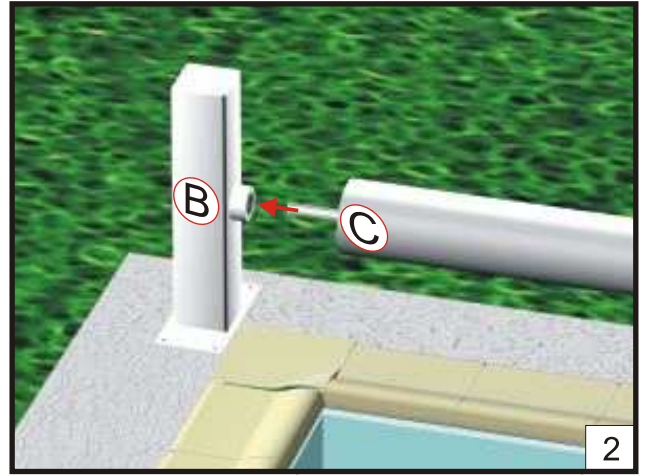

Position the B post on the edge of the swimming pool. Engage the C roller shaft in its bearing.

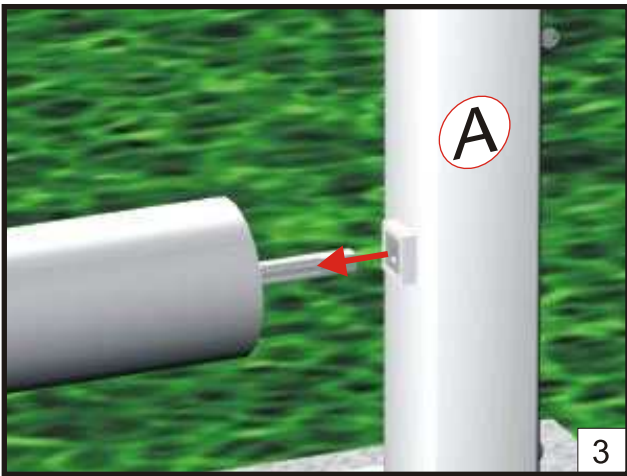

Engage the roller square into the plate of the A post.

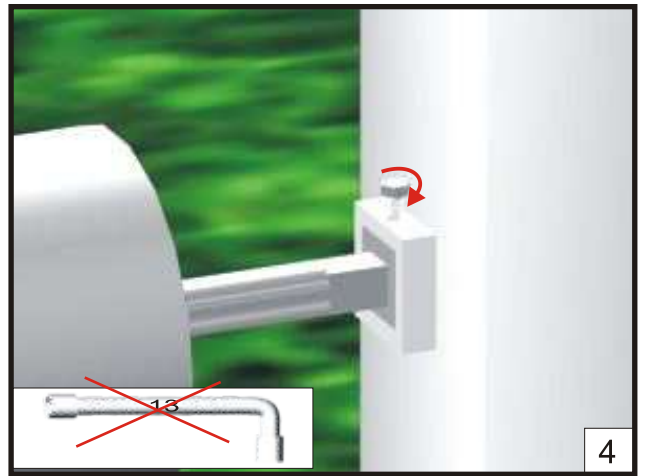

Tighten the screw **by hand**.

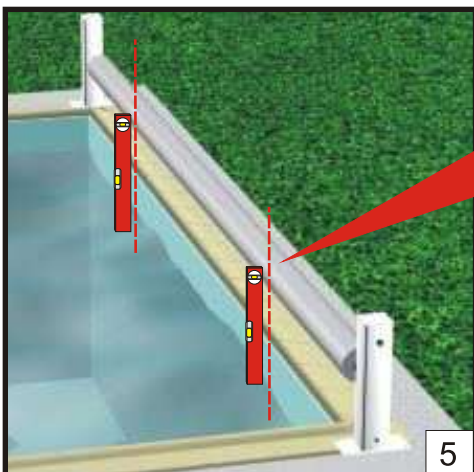

Position the post-roller assembly level with the edge of the swimming pool.

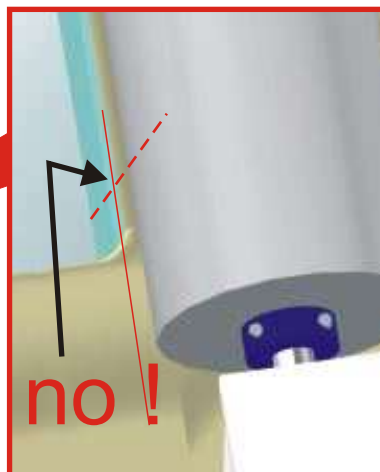

Do not align the roller level with the edge ...

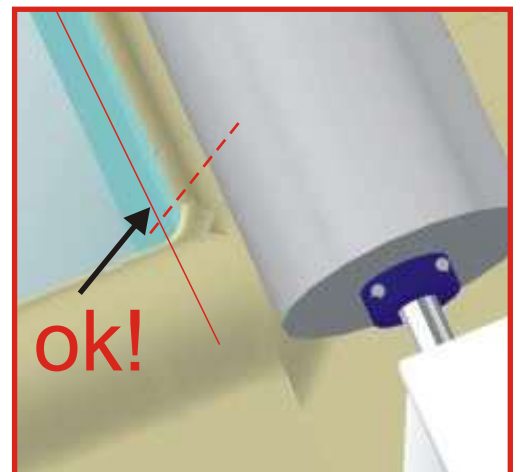

... but with the beginning of the roundness of the pool edge angles.

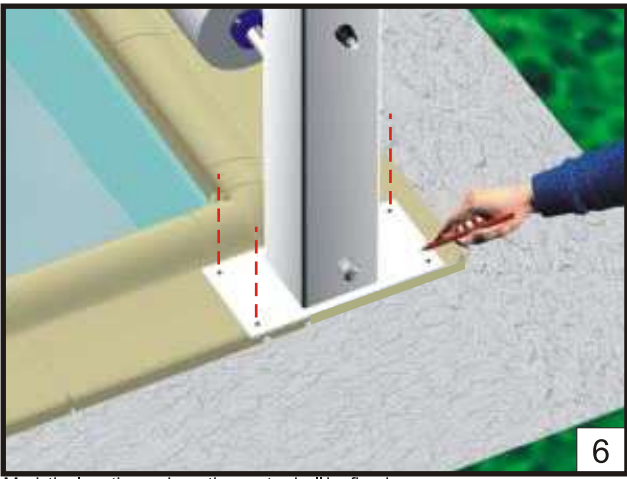

Mark the locations where the posts shall be fixed.

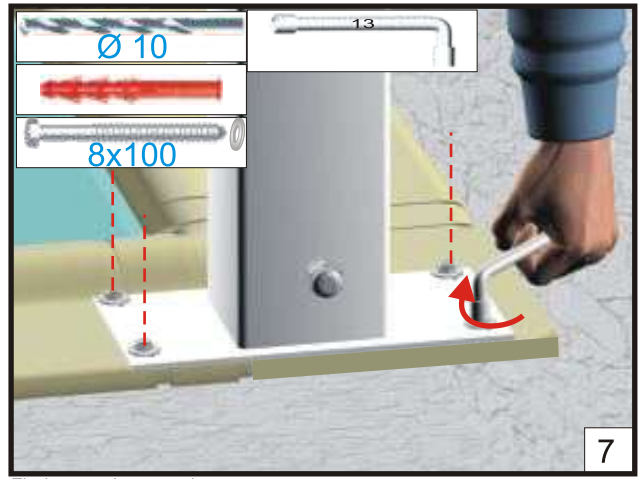

Fix them on the ground.

Electrical wiring

220 v single-phase



2x2,5 mm²

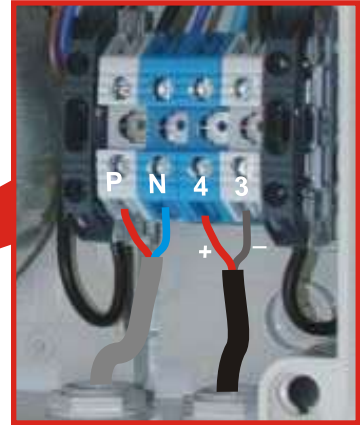
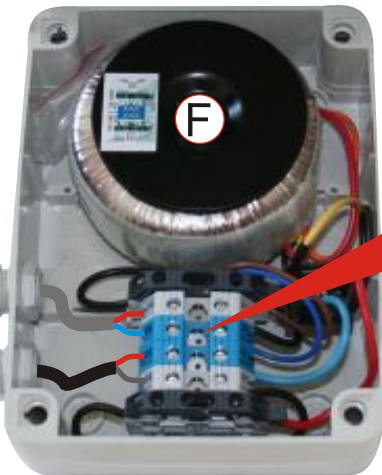

2X2,5 mm² up to 10 m
 2X4 mm² from 10 to 20 m
 2x6 mm² above 20 m

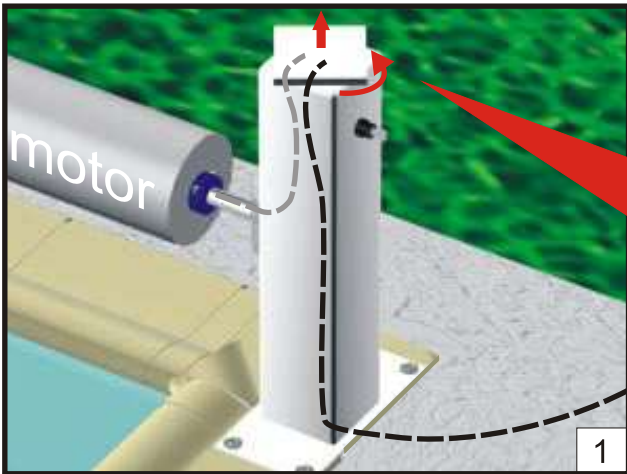

Take off the upper cover of the post on motor side.

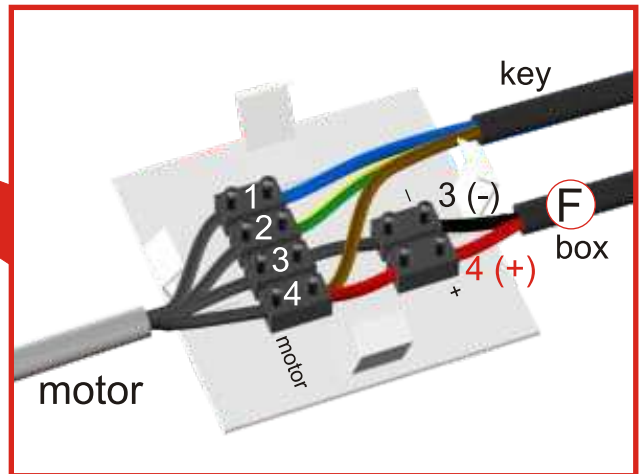

Connect both wires of the case (+ and -) as well as the 4 wires connecting the motor (keep the same order 1, 2, 3 and 4 for the black wires).



Fit the connector of the key contactor.



Turn the upper cover to close the post.

Shutter fitting

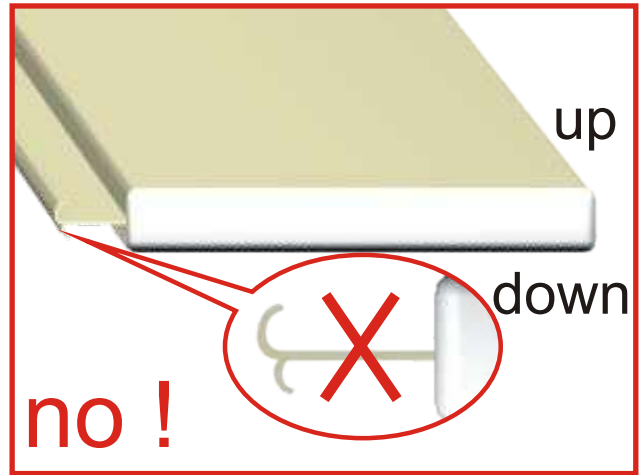
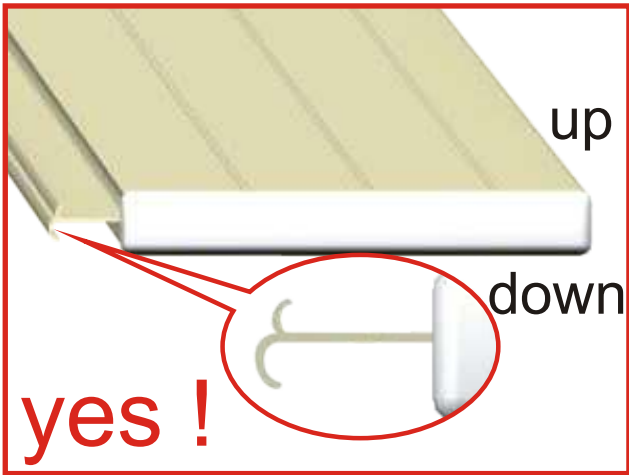

DETAIL OF THE BLADE POSITION : be careful with the direction of the blades.

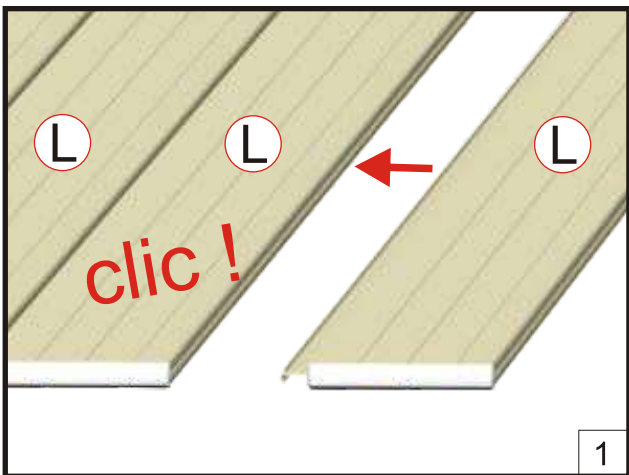

Fit the blades into each other to form the shutter.

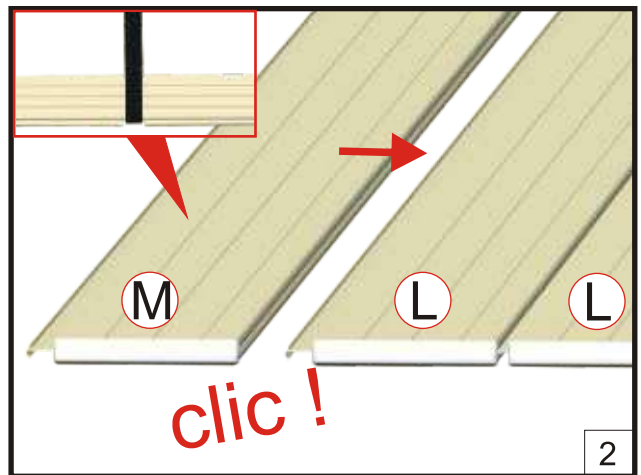

End with the beginning blade.

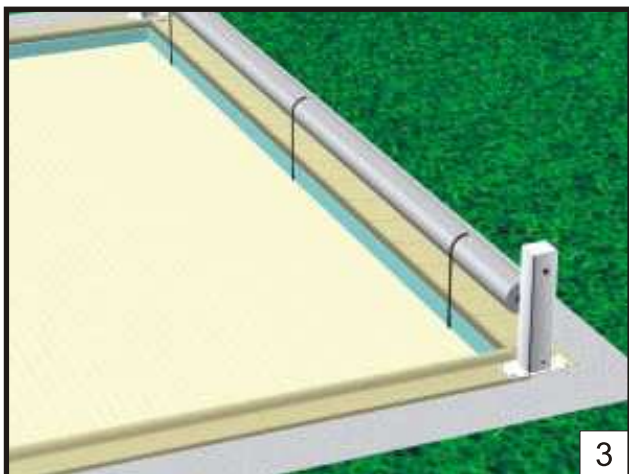

Unroll the shutter assembly in the pool.



Bend the strap end and cut a half-disk in the center to make a circular hole.

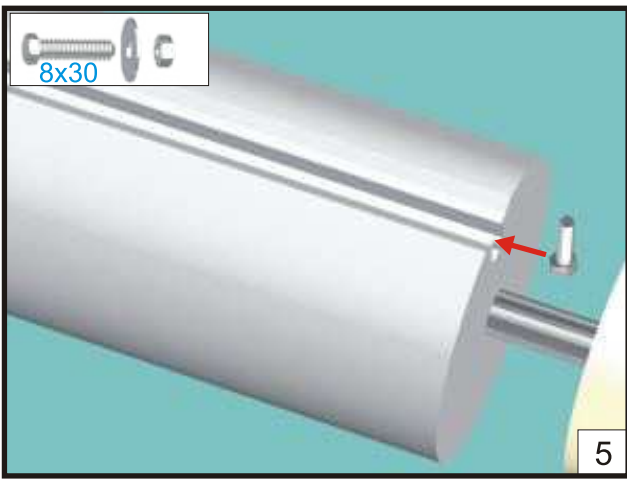

Engage the fixing screws in the roller groove. They must be facing the straps.

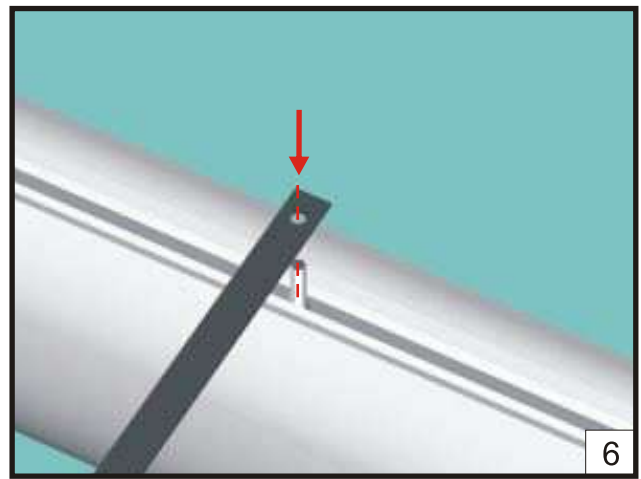

Insert the straps on the screws.

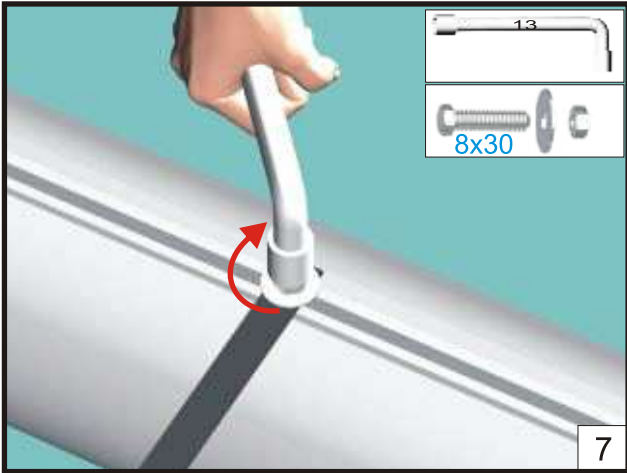

Block the straps with the provided washers and nuts.

Fitting a shutter for roman stairs

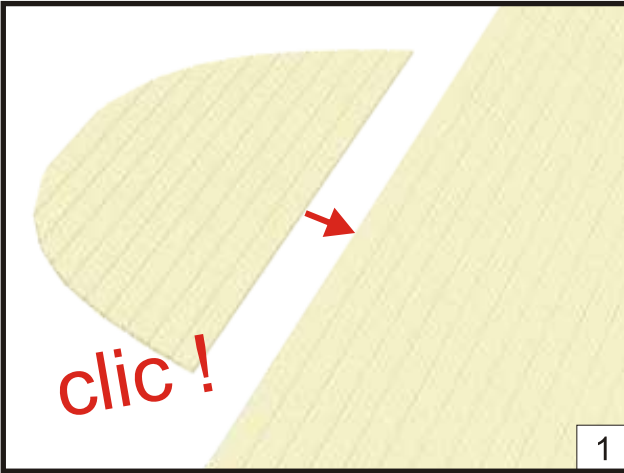
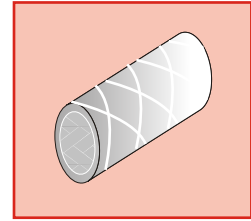

Fit in the cut-out part (for the stairs) in the shutter.

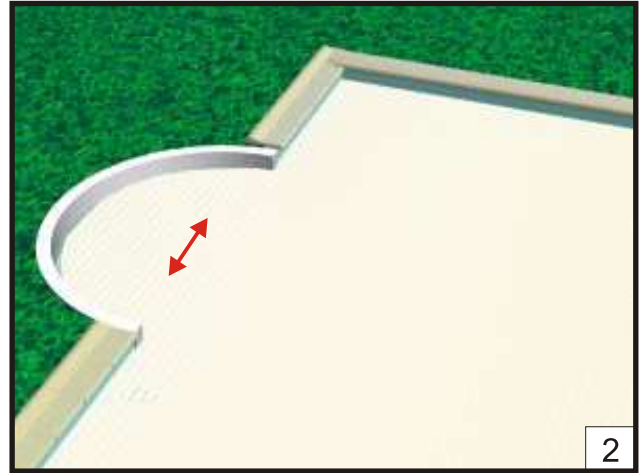

Position the shutter in the pool and place the rounded part above the stairs.

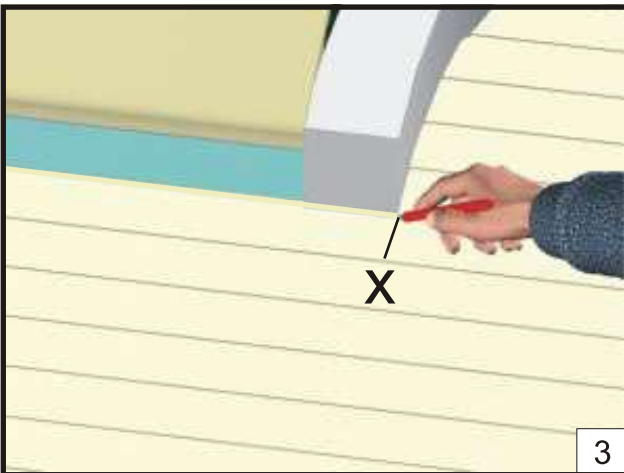

Mark out the edge of the stairs on the first blade.

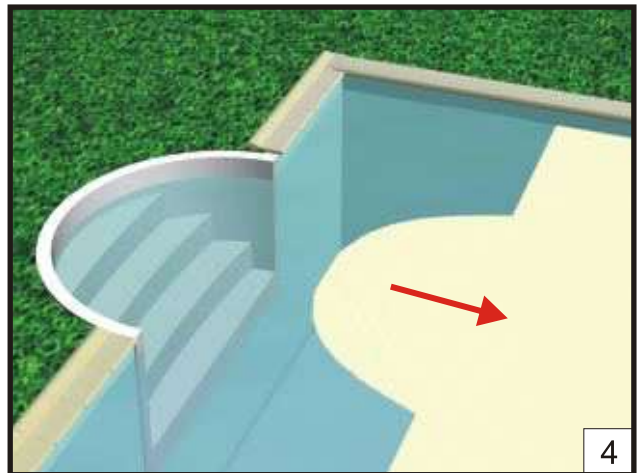

Move back the shutter so as to be able to work on it.

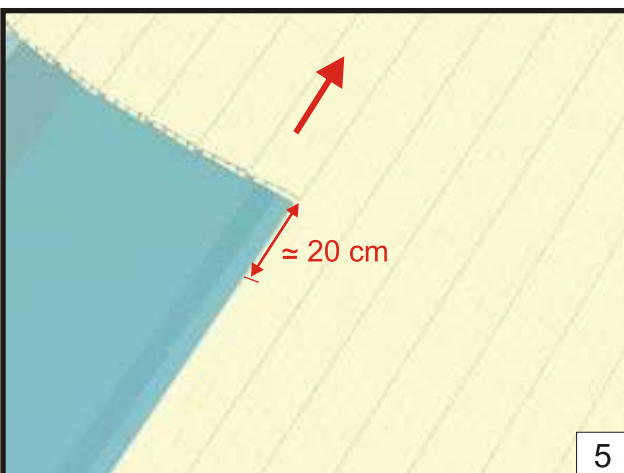

Shift forward the rounded part by approximately 20 cm.

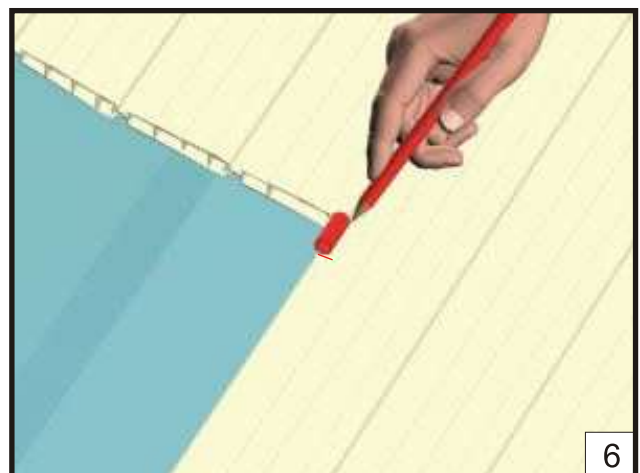

Locate the position of the little tube provided in relation to the reference mark.

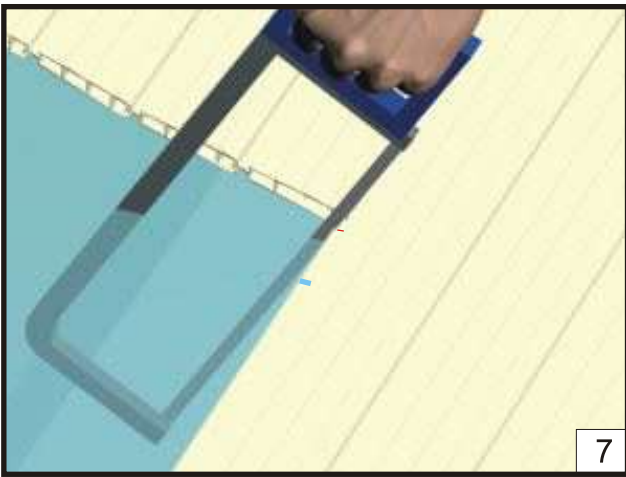

With a hacksaw cut the strip ends along the marks.

7

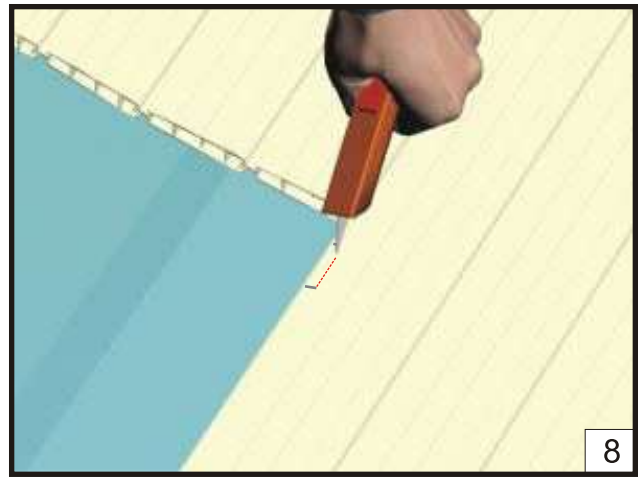

Score a line with a Stanley knife between both cutting-lines.

8

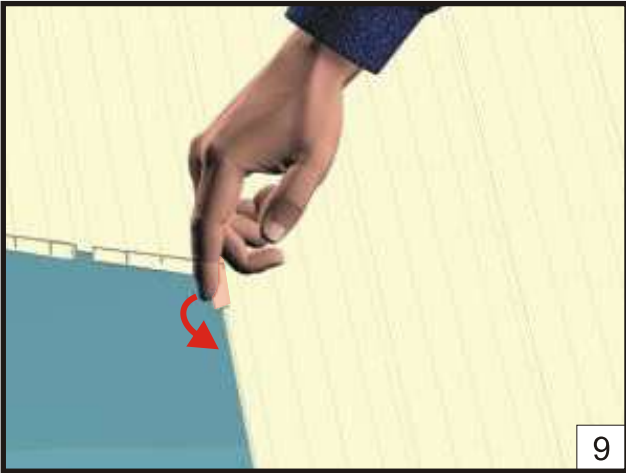

Take the piece out.

9

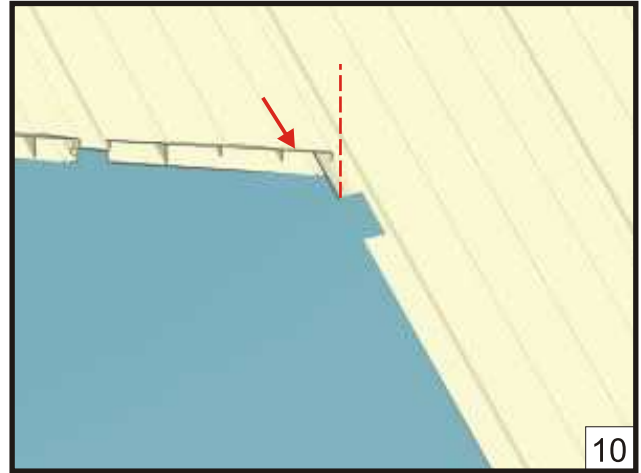

Reposition the rounded part of the shutter up to the edge of the opening you just cut out.

10



Paste one of the tube end.

11

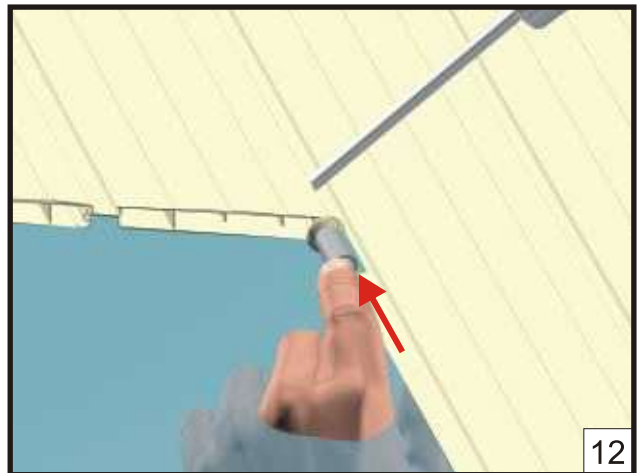

Position the tube in the opening, lever up the first blade of the rounded part of the shutter with a flat screwdriver and engage the tube in the blade.

12

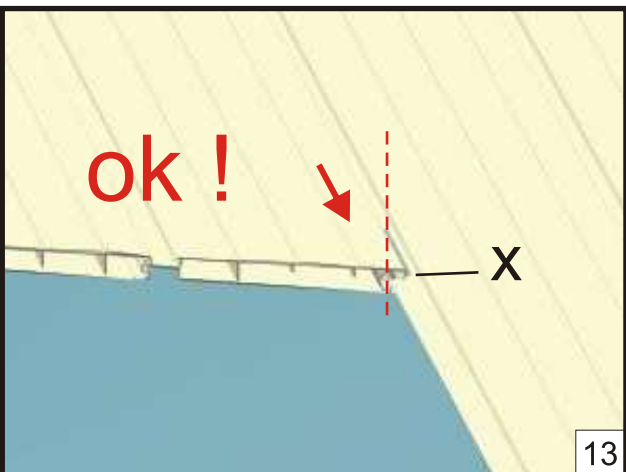

Reposition the rounded part and align it with the initial reference mark (X).

13

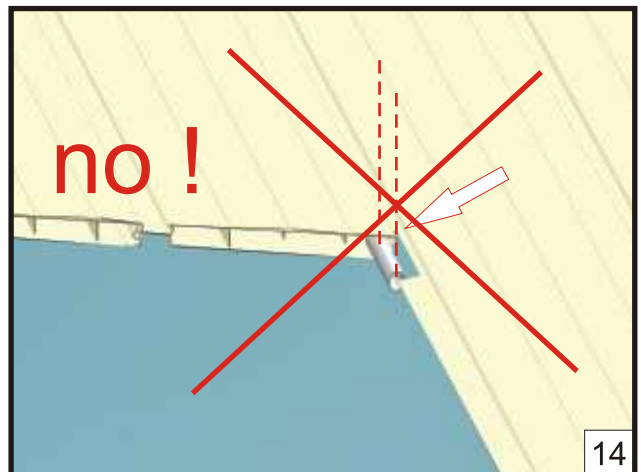

Be careful with the tube position.

14

Tests and end-of-stroke adjustments



Perform the operation tests.

1

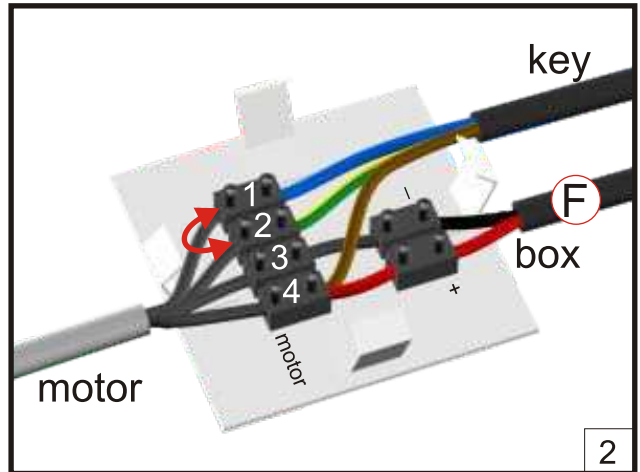

If the shutter rolls in the wrong direction, reverse the wires 1 & 2 of the cable connecting the motor.

2

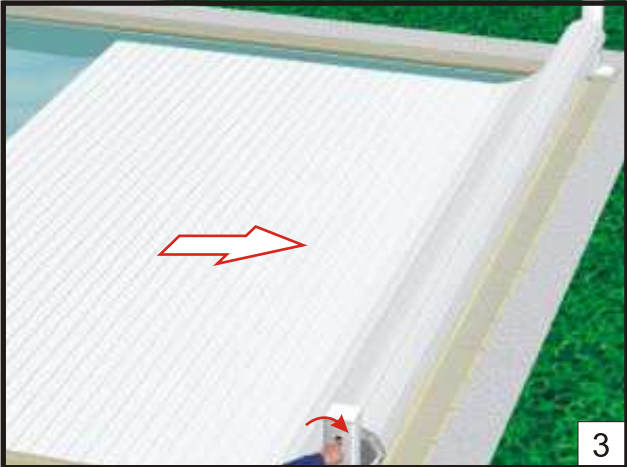

Roll up the shutter by means of the key.

3

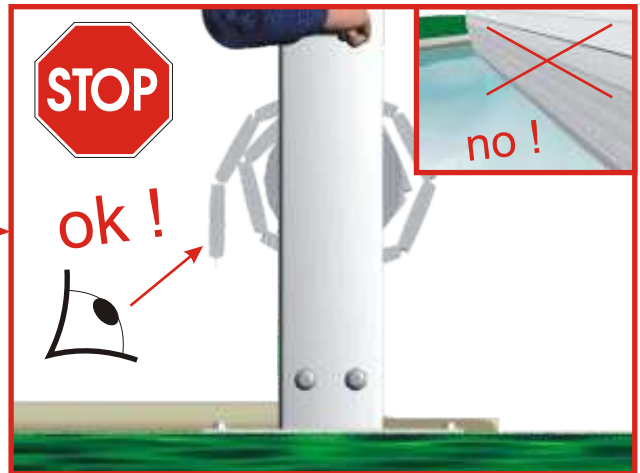

Stop rolling up the shutter as soon as the last blade of the shutter is in the position as indicated above.



4



Run the driving shaft with the key and with the provided accessory (at the same time) activate the end-of-stroke adjustment until the shutter stops correctly (see figure 3). Perform this maneuver again until the required adjustment.

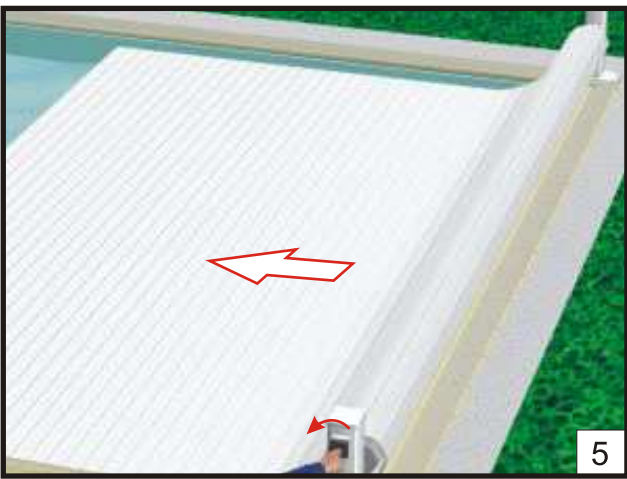

By means of the key, unroll the shutter.

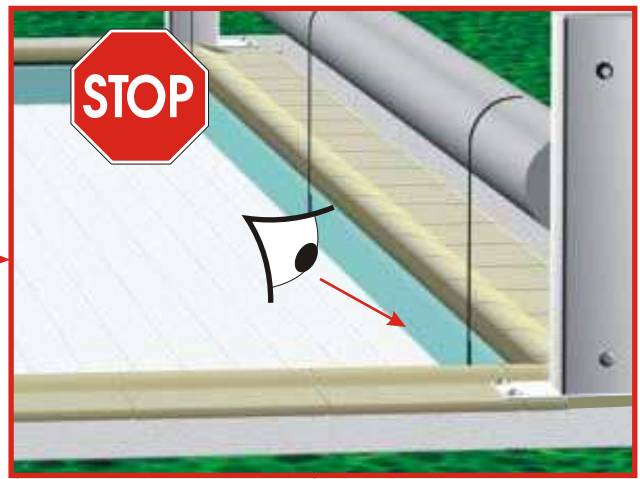

Stop rolling the shutter as soon as the first blade is under water.

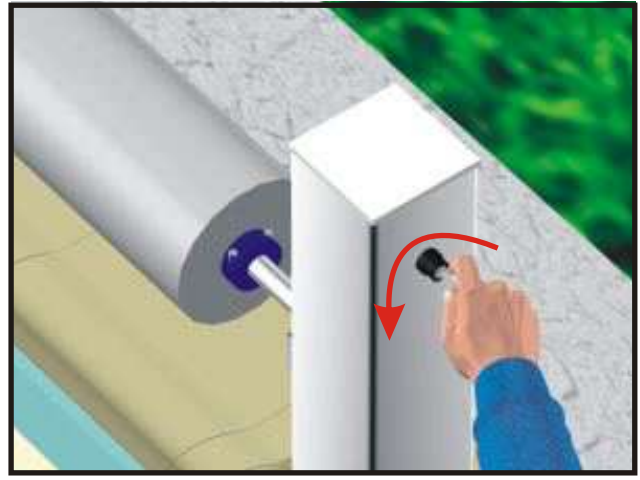
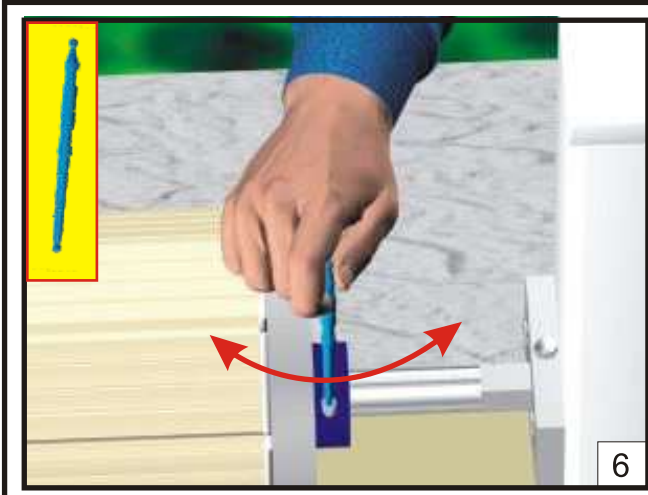

Turn the driving shaft with the key and with the provided accessory (at the same time) activate the end-of-stroke adjustment until the shutter stops correctly (see figure 5). Perform this maneuver again until the required adjustment.

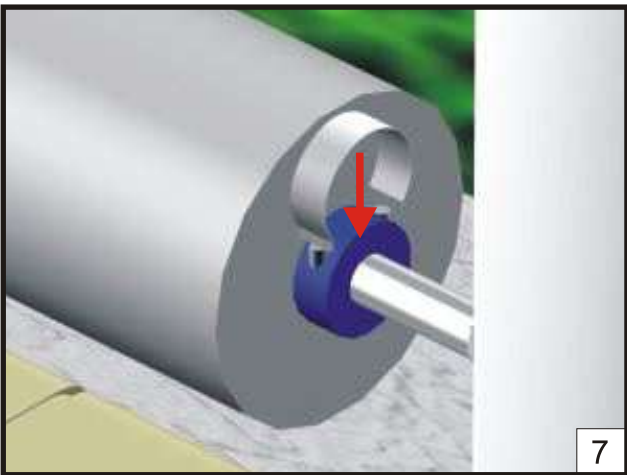

Place the protection ring on the end-of-stroke adjustment.

Security system

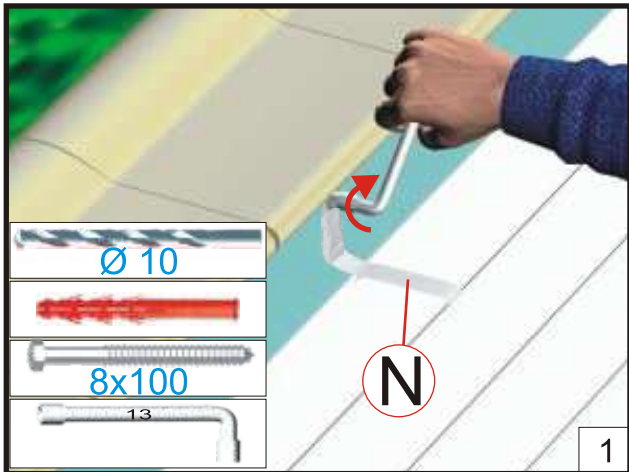

Fix the strap with the required fastening on the face of the pool end.

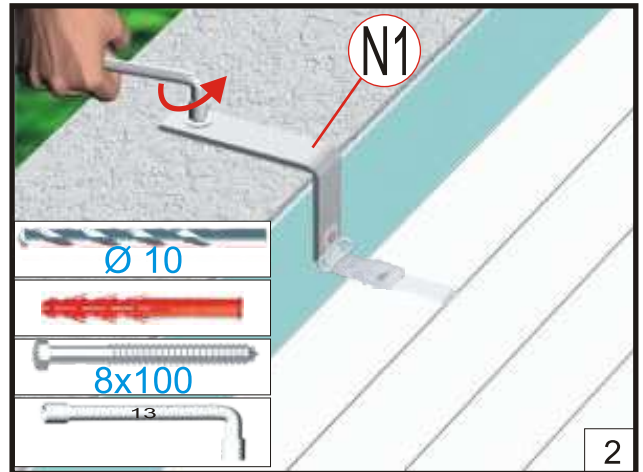

If the pool edges are not installed, fix the shutter strap on the concrete slab by means of the set square. Then pass the strap in the ring.

Advice of use

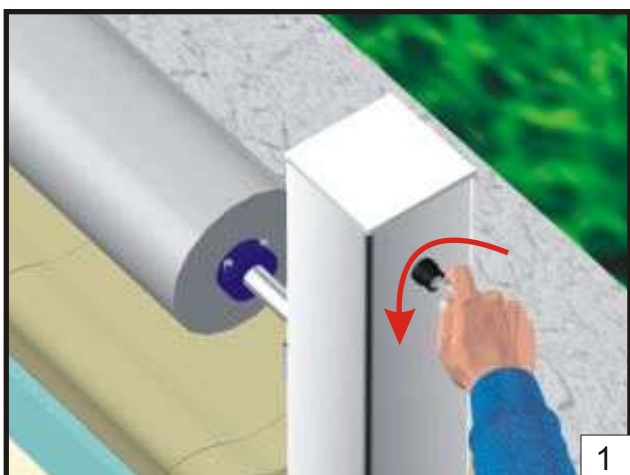

When you roll out the shutter, ensure it unfurls in the right direction. If not, roll it up and out again.



Z.I B.P 58
F-67172 BRUMATH CEDEX
Tél : +33 3 90 29 51 00 - Fax : +33 3 90 29 51 19